

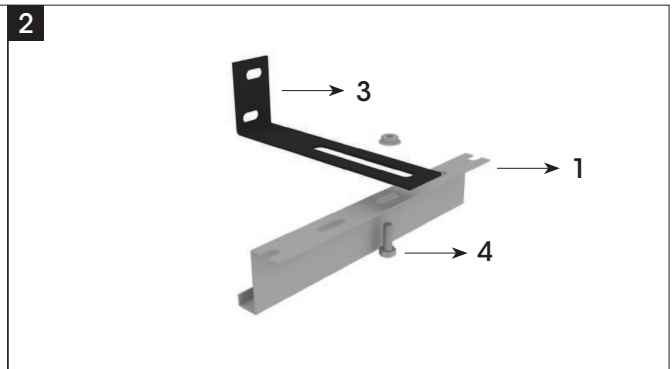

INTEGRA PLANK INTEGRA PLANK

Hook-on Plank Sistem Hook-on Plank System

Hook-on Koridor
Hook-on Corridor

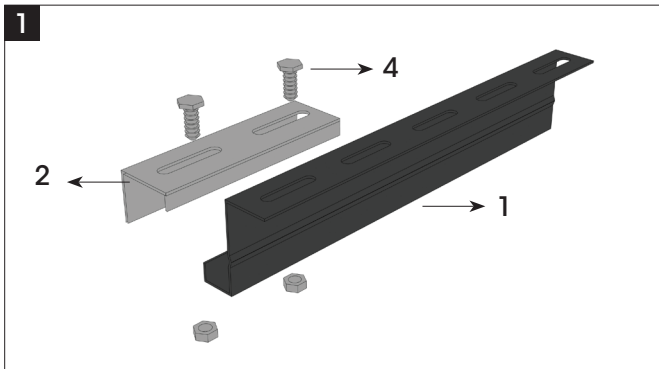
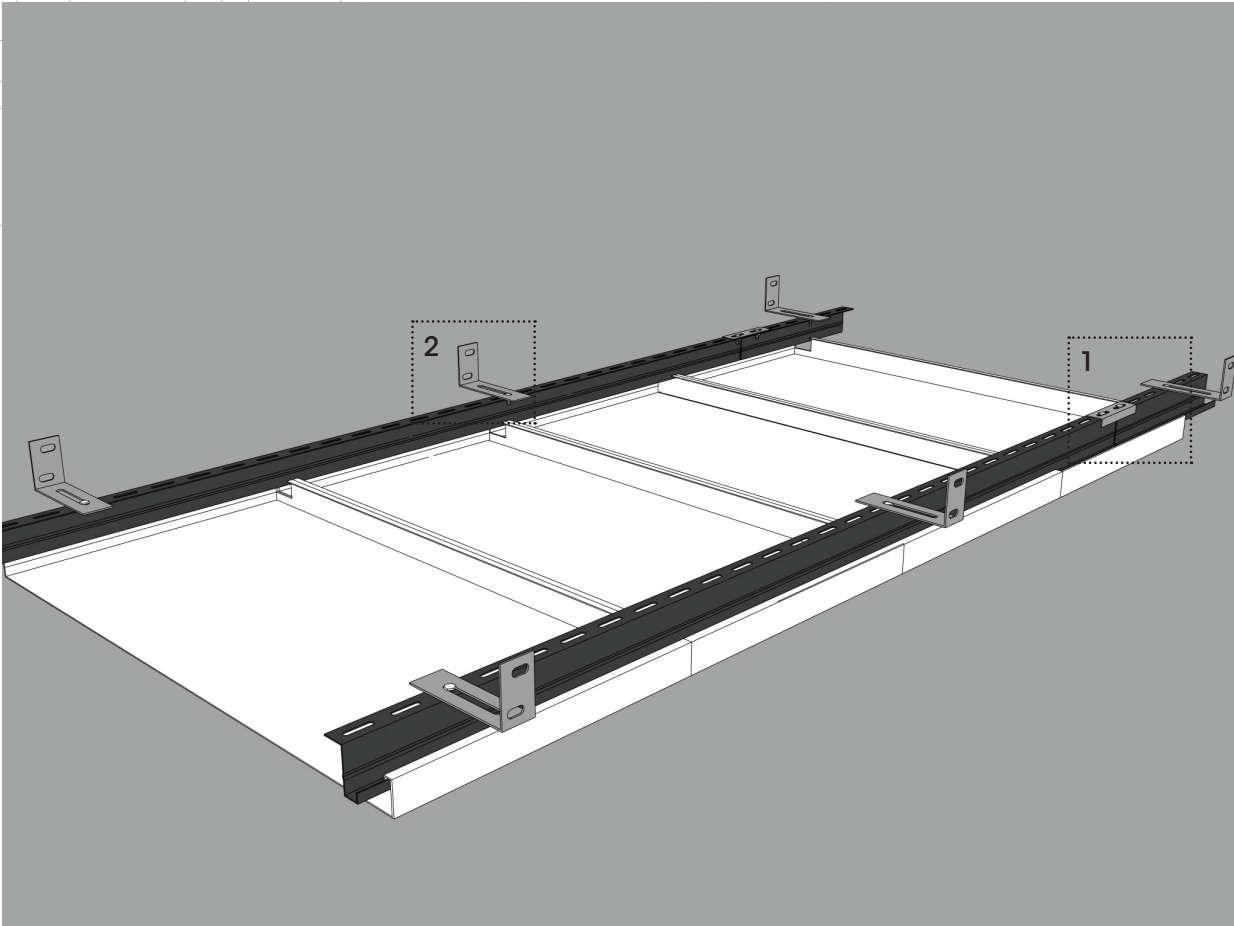

Hook-on Koridor

Integra Plank Hook-on Koridor plakaları farklı detay ve ölçüdeki koridorlar için ideal çözüm sunmak üzere tasarlanmıştır. Hook-on profil ve aksesuarlarıyla tam uyumlu olan paneller kolaylıkla demonte edilebilme özelliğine sahiptir. Mekan boyutuna uygun ebatlandırılabilen Hook-on Koridor, uygulamada malzeme firesini minimuma indirmektedir.

Standart Panel / Standard Panel

**Panel Tanımı**

Hammadde: Galvanize çelik, Paslanmaz çelik, Alüminyum.

Kenar özelliği: Küt

En: 200-1200mm

Boy: 200-3000 mm

Boya: RAL 9006, RAL 9010, RAL 9016

- . İsteğe bağlı olarak tüm RAL renklerinde üretim yapılabilir.
- . Özellikle hijyen gerektiren alanlar için anti bakteriyel boya seçeneği mevcuttur.
- . İstenildiğinde ahşap görünlü paneller üretilebilir.
- . Daha fazla bilgi için bkz. **Renk ve Desen**

Perforasyon: Ø0.7, Ø1.5, Ø1.8, Ø2.5, Ø3, Ø4.5, Ø6, Ø7, Ø16, 8x8, Random.

Daha fazla bilgi için bkz. **Perforasyon**

Akustik: NRC 0,70(Ø2.5mm %16 boşluk oranı)
Daha fazla bilgi için bkz. **Akustik**

Yangın: Yangın tepki sınıfı A2-s1,d0.
Daha fazla bilgi için bkz. **Standartlar**

Teknik Standartlar:

- . Gizli taşıyıcı sistem ile desteklenen, ISO9001:2008, TSE ve CE belgeli tesisimizde Avrupa, Amerika ve TAIM (Technical Association of Industrial Metal Ceiling Manufacturers) standartlarına uygun olarak imal edilmektedir.
- . Malzemenin yangın tepki sınıfı, uluslar arası akredite edilmiş test kuruluşlarında yaptırılmış yangın testi ile EN 13501-1 standardı uyarınca yapılan sınıflandırma sonucu A2-s1,d0 olarak belgelenmiştir.

Hook-on Corridor

Integra Hook-on Corridor ceiling panels are designed to offer ideal solutions for corridors of different sizes and details. The corridor panels, which are fully compatible with hook-on profiles and accessories, can be easily demounted.

Produced according to the specific size of each area, the hook-on corridor system minimizes material loss during installation.

Standart Birleşim / Standard Connection

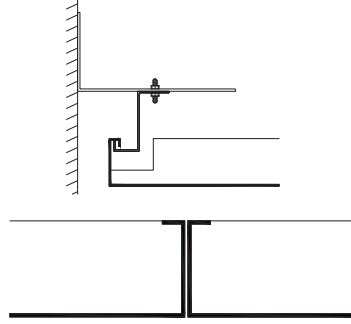
**Panel Description**

Raw material: Galvanized Steel, Stainless Steel, Aluminium.

Edge Option: Square

Width: 200-1200mm

Length: 200-3000 mm

Colour: RAL9006, RAL9010, RAL9016

- . Production is possible in all other RAL colours upon request.
- . Antibacterial paint option is available upon request, especially for areas with hygiene requirements.
- . Panels with wood appearance can be produced if requested.
- . For detailed information please see **Colours and Design**.

Perforation: Ø0.7, Ø1.5, Ø1.8, Ø2.5, Ø3, Ø4.5, Ø6, Ø7, Ø16, 8x8, Random.

For detailed information please see **Perforation**.

Acoustics: NRC: 0,70(Ø2.5mm %16 open area)
For detailed information please see **Acoustics**.

Fire: Reaction to Fire Class A2-s1,d0.
For detailed information please see **Standards**.

Technical Standards:

- . Ceiling panels supported by fully concealed suspension system manufactured in accordance with European, American and TAIM (Technical Association of Industrial Metal Ceiling Manufacturers) standards in our factory that have ISO9001:2008, TSE ve CE certificates.
- . Panels are tested in accordance with EN 13501-1 and must be designed to comply with Euroclass A2-s1, d0

METAL CEILING SPECIFICATION

... x ... mm Sized Hook-on Corridor System

General Description:

Galvanised Steel/Aluminium ceiling panels supported by fully concealed suspension system manufactured in accordance with European, American and TAIM (Technical Association of Industrial Metal Ceiling Manufacturers) standards by a manufacturer that have ISO9001:2008, TSE ve CE certificates.

Ceilings are tested in accordance with EN 13501-1 and must be designed to comply with at least Euroclass A2-s1-d0

Panel Description:

Raw material	Ceiling panels manufactured from ... mm Galvanised Steel/Aluminium/ Stainless Steel.
Colour	Ceiling panels coated electrostatically applied powder coating coloured RAL ... (min. 60 μ thickness and approx. %20 Gloss Rate)
Acoustical inlay	Ceiling panels are manufactured with 0,2 mm thickness, black acoustical inlay (Royalin/Soundtex) to achieve sound absorption $\alpha_w = \dots$ for $\varnothing \dots$ mm Perforation (%.. open area)
Perforation	Ceiling panels are perforated $\varnothing \dots$ mm (% ... open area) and plain borders are ... mm.

Installation:

Wall anchor(3) should be used for lateral sides facing inwards of the corridors according to wall positioning and panel type. The distance between wall anchors should be 900mm. Hook-on profile is connected to wall anchor by using Bolt/Nult (4). Mounting distance between Hook-on profiles should be 5 mm less than size of panel. In order to add one hook-on profile to another lienarly; Hook-on profile splice should be used. . Lighting, sprinkler or vent places should be cutted out and the components should be installed according to the project after the installation. In the case of these components come up to suspension system accessories, installation should be continued with mounting suspension system accesories one before and one after the components.

Suspension System:

1- AS 9:	Hook-on Profile, Z sectioned, 19x38 mm sized, 4000 mm length, 1 mm thickness, galvanised steel
2- AS 15:	Hook on profile splice
3- AS 30:	Wall anchor, 30x50x100 mm sized, 1,5 mm thickness galvanised steel
4- VDS 60:	Bolt/nult, $\varnothing 6$ mm

PANEL BAĞLANTI DETAYLARI
PANEL CONNECTION DETAILS

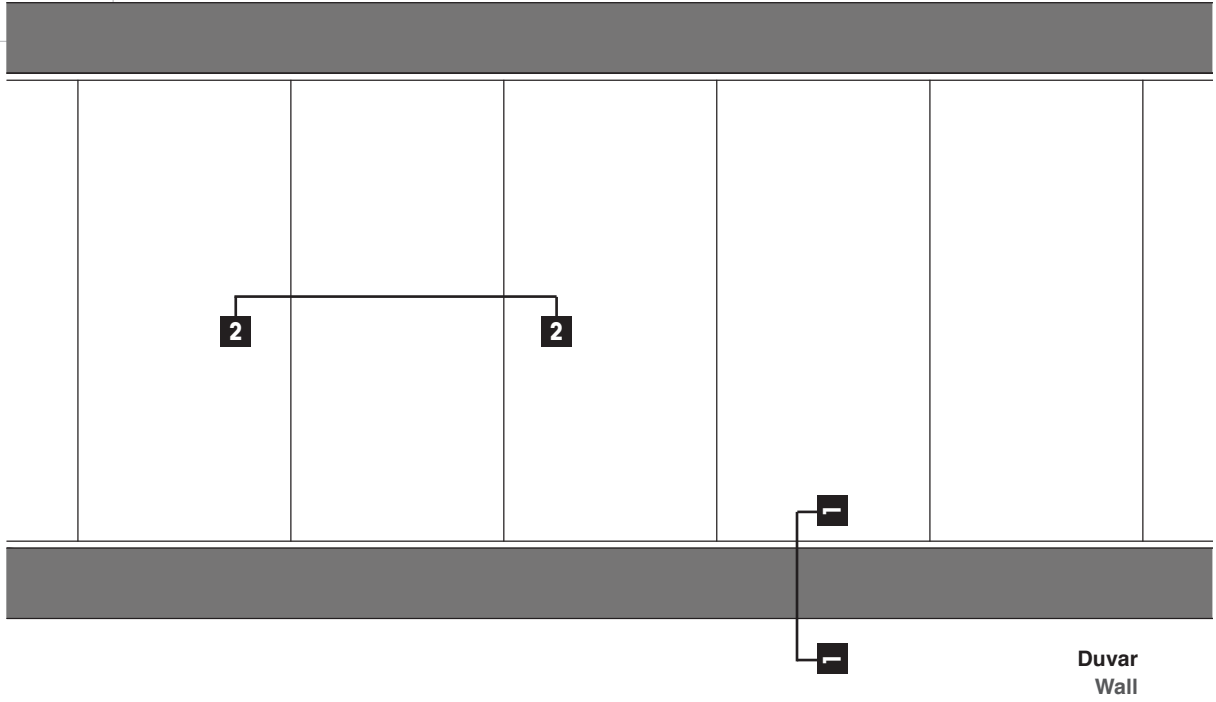

1-1 Kesiti / Section 1-1

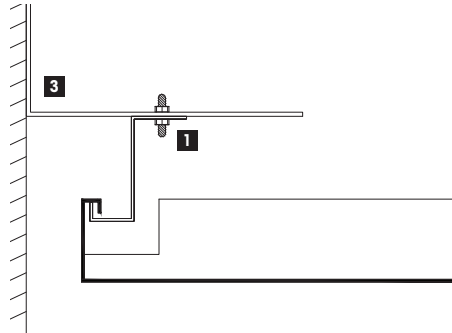

Taşıyıcı - Panel Birleşimi

- 1 Hook-on Profil
- 3 Duvar Bağlantı Pabucu

Profile - Panel Connection

- 1 Hook-on Profile
- 3 Wall Anchor

2-2 Kesiti / Section 2-2

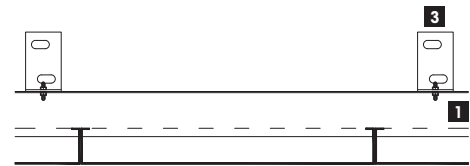

Taşıyıcı Birleşimi

- 1 Hook-on Profil
- 3 Duvar Bağlantı Pabucu

Profile Connection

- 1 Hook-on Profile
- 3 Wall Anchor

METAL VE DİĞER TAVANLARIN BİRLEŞİM DETAYLARI
METAL AND OTHER CEILING CONNECTION DETAILS

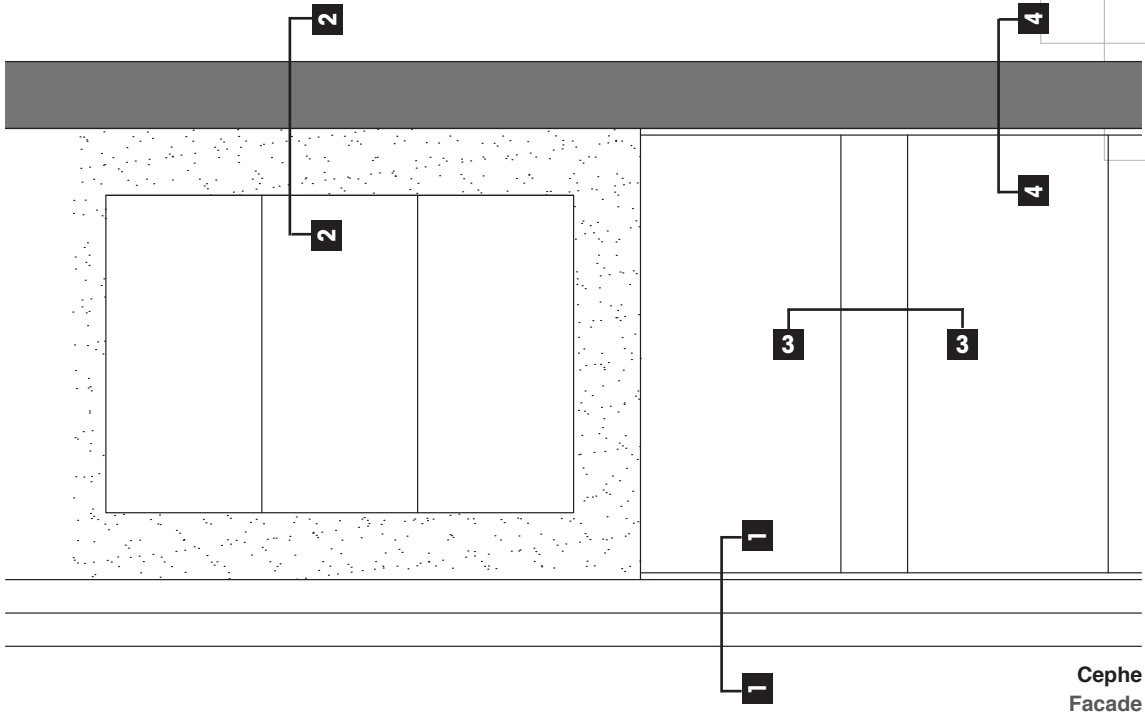

1-1 Kesiti / Section 1-1

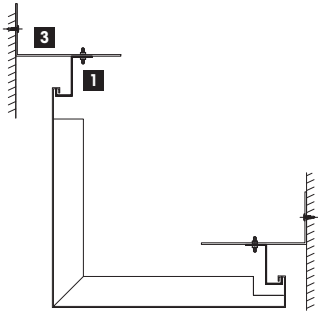

Alternatif 1

Duvar Bağlantı Pabucu ile Alın Panel Bitişi

1 Hook-on Profil

3 Duvar Bağlantı Pabucu

Alternative 1

L Panel Finish with Wall Anchor

1 Hook-on Profile

3 Wall Anchor

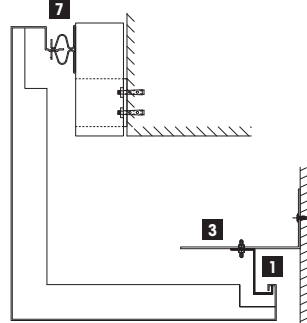

Alternatif 2

Diversa Yarım Dikme ile Alın Panel Bitişi

1 Hook-on Profil

3 Duvar Bağlantı Pabucu

7 Diversa Yarım dikme Profili

Alternative 2

L Panel Finish with Diversa Half Upright

1 Hook-on Profile

3 Wall Anchor

7 Diversa Half Upright

1-1 Kesiti / Section 1-1

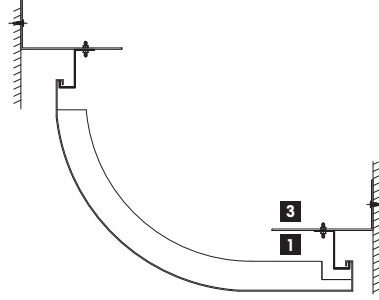

Alternatif 3

Duvar Bağlantı Pabucu ile Alın Panel Bitişi

1 Hook-on Profil

3 Duvar Bağlantı Pabucu

Alternative 3

Curvilinear Panel Finish with Wall Anchor

1 Hook-on Profile

3 Wall Anchor

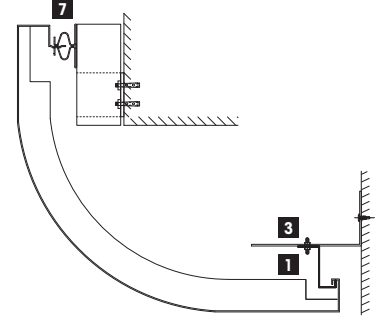

Alternatif 4

Diversa Yarım Dikme ile Alın Panel Bitişi

1 Hook-on Profil

3 Duvar Bağlantı Pabucu

7 Diversa Yarım dikme Profili

Alternative 4

Curvilinear Panel Finish with Diversa Half Upright

1 Hook-on Profile

3 Wall Anchor

7 Diversa Half Upright

2-2 Kesiti / Section 2-2

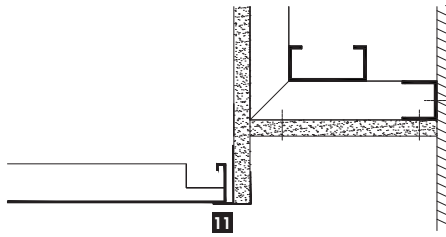

F Profil ile Alçıpan - Metal Tavan Birleşimi

11 F Profil

Joint to Gypsum Board with F Profile

11 F Profile

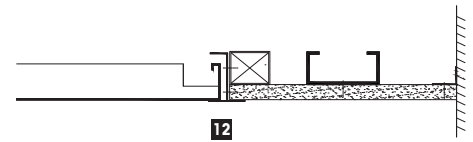

H Profil ile Alçıpan - Metal Tavan Birleşimi

12 H Profil

Joint to Gypsum Board with H Profile

12 H Profile

3-3 Kesiti / Section 3-3

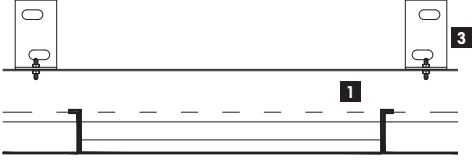

Kapama Paneli - Metal Tavan Birleşimi

- 1** Hook-on Profil
- 3** Duvar Bağlantı Pabucu

Covering Panel - Ceiling Connection

- 1** Hook-on Profile
- 3** Wall Anchor

4-4 Kesiti / Section 4-4

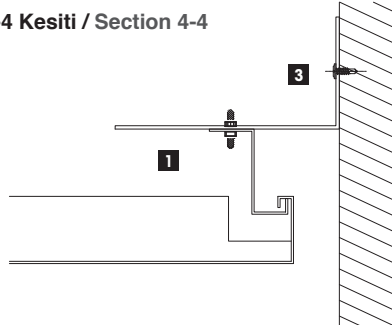

Duvar-Tavan Bağlantıları

- 1** Hook-on Profil
- 3** Duvar Bağlantı Pabucu

Ceiling-Wall Connections

- 1** Hook-on Profile
- 3** Wall Anchor

CUTOUT YAPILMIŞ PANEL DETAYLARI
DETAILS OF PANELS WITH CUT-OUT

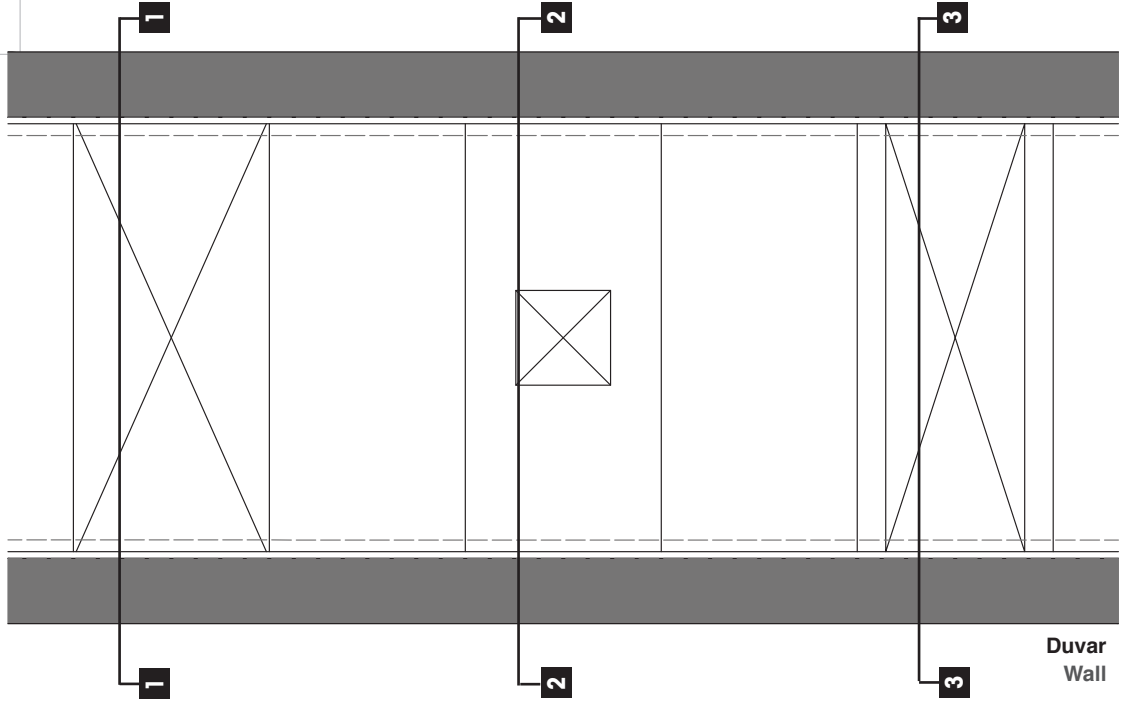

1-1 Kesiti / Section 1-1

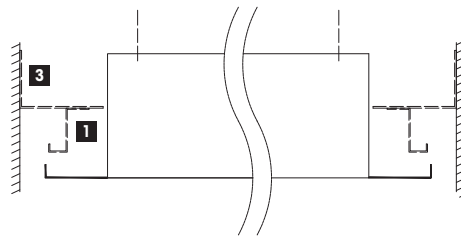

Cut-out Yapılmış Tavan Paneli

1 Hook-on Profil

3 Duvar Bağlantı Pabucu

Ceiling Panel with Cut-out

1 Hook-on Profile

3 Wall Anchor

2-2 Kesiti / Section 2-2



Cut-out Yapılmış Tavan Paneli

1 Hook-on Profil

3 Duvar Bağlantı Pabucu

Ceiling Panel with Cut-out

1 Hook-on Profile

3 Wall Anchor

3-3 Kesiti / Section 3-3

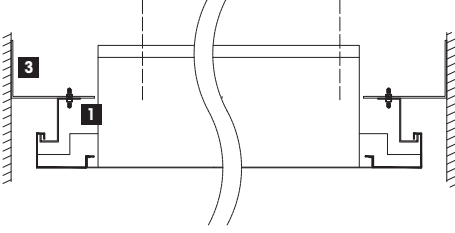

Cut-out Yapılmış Tavan Paneli

1 Hook-on Profil

3 Duvar Bağlantı Pabucu

Ceiling Panel with Cut-out

1 Hook-on Profile

3 Wall Anchor

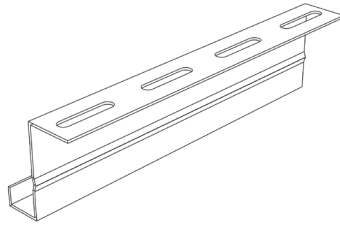

01

AS-9	
Ürün Adı	Hook-on Profil
Özellik / Malzeme	Galvanize Çelik 1 mm 19x38x4000x1,0

AS-9	
Product Reference	Hook-on Profile
Specification / Material	Galvanized Steel 1 mm 19x38x4000x1,0

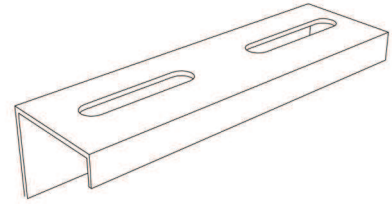

02

AS-15	
Ürün Adı	Hook-on Profil Ekleme
Özellik / Malzeme	Galvanize Çelik 1 mm 22,5x35x100x1,0

AS-15	
Product Reference	Hook-on Profile Splice
Specification / Material	Galvanized Steel 1 mm 22,5x35x100x1,0

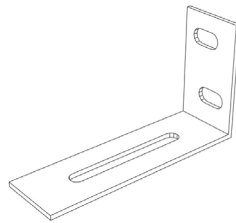

03

AS-30	
Ürün Adı	Duvar Bağlantı Pabucu
Özellik / Malzeme	Galvanize Çelik 1,5 mm 30x50x100x1,5

AS-30	
Product Reference	Wall Anchor
Specification / Material	Galvanized Steel 1,5 mm 30x50x100x1,5

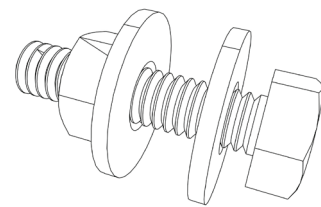

04

VDS-60	
Ürün Adı	Vida/Somun/Rondela
Özellik / Malzeme	Ø6

VDS-60	
Product Reference	Bolt/Nut/Washer
Specification / Material	Ø6

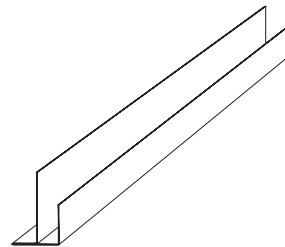

05

FDPR-3000	
Ürün Adı	F Profil
Özellik / Malzeme	Alüminyum 1 mm

FDPR-3000	
Product Reference	F Profile
Specification / Material	Aluminium 1 mm

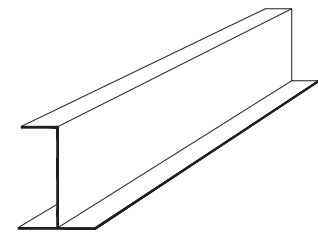

06

HDPR-40	
Ürün Adı	H Profil
Özellik / Malzeme	30x40x3000x1mm Alüminyum 1 mm

HDPR-40	
Product Reference	H Profile
Specification / Material	30x40x3000x1mm Aluminium 1 mm

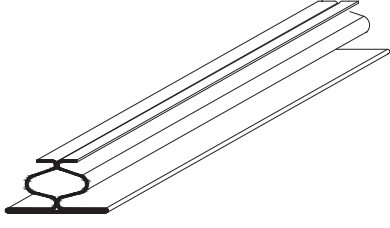

07

Ürün Adı	Diversa yarım dikme profili
Özellik / Malzeme	49x20.6x5100x0,8 mm Galvanize Çelik 0,8 mm

Product Reference	Diversa half upright
Specification / Material	49x20.6x5100x0,8 mm Galvanized Steel 0,8 mm