





INTEGRA PLANK INTEGRA PLANK

Hook-on Plank Sistem Hook-on Plank System

Hook-on DS
Hook-on DS

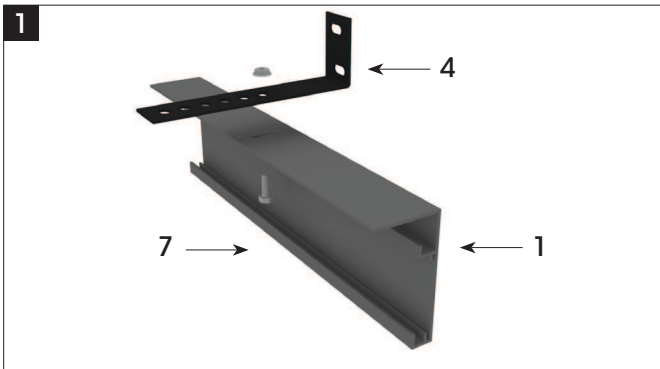
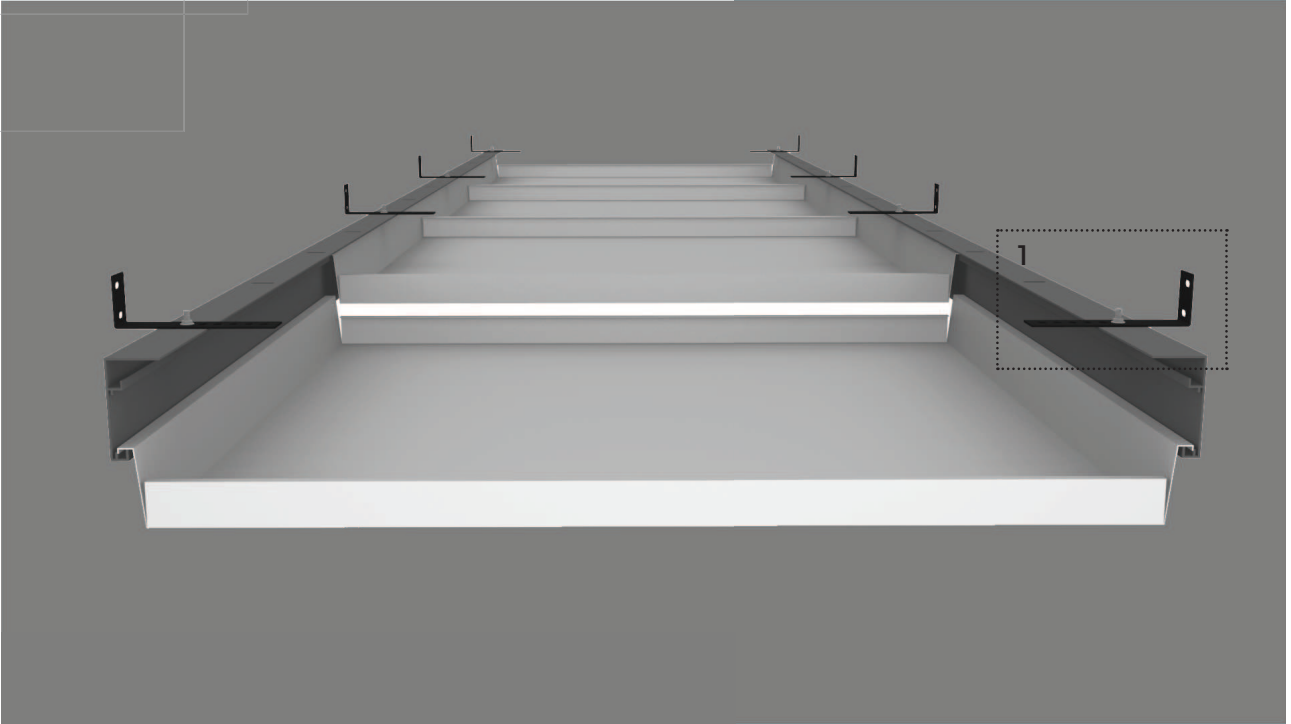

Hook-on DS

Integra Plank Hook-on DS plakaları farklı detay ve ölçüdeki koridorlar için ideal çözüm sunmak üzere tasarlanmıştır. Paneller tamamen sökülmesine gerek kalmadan sadece kaydırılarak tavan arkasına kolay ulaşımı sağlamaktadır.

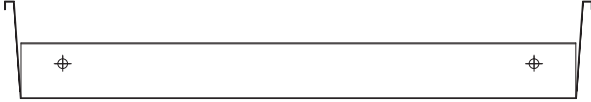
Standart Panel / Standard Panel**Panel Tanımı**

Hammadde: Galvanize çelik, Paslanmaz çelik, Alüminyum.

Kenar özelliği: Küt

En: 200-1200mm

Boy: 200-3000 mm

Boya: RAL 9006, RAL 9010, RAL 9016

- . İsteğe bağlı olarak tüm RAL renklerinde üretim yapılabilir.
- . Özellikle hijyen gerektiren alanlar için anti bakteriyel boya seçeneği mevcuttur.
- . İstenildiğinde ahşap görümlü paneller üretilebilir.
- . Daha fazla bilgi için bkz. **Renk ve Desen**

Perforasyon: Ø0.7, Ø1.5, Ø1.8, Ø2.5, Ø3, Ø4.5, Ø6, Ø7, Ø16, 8x8, Random.
Daha fazla bilgi için bkz. **Perforasyon**

Akustik: NRC 0,70(Ø2.5mm %16 boşluk oranı)
Daha fazla bilgi için bkz. **Akustik**

Yangın: Yangın tepki sınıfı A2-s1,d0.
Daha fazla bilgi için bkz. **Standartlar**

Teknik Standartlar:

- . Gizli taşıyıcı sistem ile desteklenen, ISO9001:2008, TSE ve CE belgeli tesisimizde Avrupa, Amerika ve TAIM (Technical Association of Industrial Metal Ceiling Manufacturers) standartlarına uygun olarak imal edilmektedir.
- . Malzemenin yangın tepki sınıfı, uluslar arası akredite edilmiş test kuruluşlarında yaptırılmış yangın testi ile EN 13501-1 standardı uyarınca yapılan sınıflandırma sonucu A2-s1,d0 olarak belgelenmiştir.

Hook-on DS

Integra Hook-on DS ceiling panels are designed to offer ideal solutions for corridors of different sizes and details. The corridor panels can be slid without demounting and also offer easy reach to ceiling void.

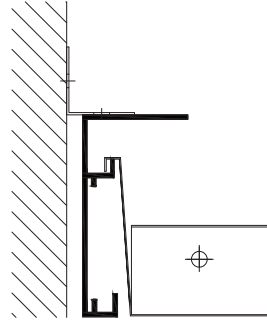
Standart Birleşim / Standard Connection**Panel Description**

Raw material: Galvanized Steel, Stainless Steel, Aluminium.

Edge Option: Square

Width: 200-1200mm

Length: 200-3000 mm

Colour: RAL9006, RAL9010, RAL9016

- . Production is possible in all other RAL colours upon request.
- . Antibacterial paint option is available upon request, especially for areas with hygiene requirements.
- . Panels with wood appearance can be produced if requested.
- . For detailed information please see **Colours and Design**.

Perforation: Ø0.7, Ø1.5, Ø1.8, Ø2.5, Ø3, Ø4.5, Ø6, Ø7, Ø16, 8x8, Random.
For detailed information please see **Perforation**.

Acoustics: NRC: 0,70(Ø2.5mm %16 open area)
For detailed information please see **Acoustics**.

Fire: Reaction to Fire Class A2-s1,d0.
For detailed information please see **Standards**.

Technical Standards:

- . Ceiling panels supported by fully concealed suspension system manufactured in accordance with European, American and TAIM (Technical Association of Industrial Metal Ceiling Manufacturers) standards in our factory that have ISO9001:2008, TSE ve CE certificates.
- . Panels are tested in accordance with EN 13501-1 and must be designed to comply with Euroclass A2-s1, d0

METAL CEILING SPECIFICATION

... x ... mm Sized Hook-on Drop&Slide System

General Description:

Galvanised Steel/Stainless Steel/Aluminium ceiling panels supported by Drop&Slide suspension system manufactured in accordance with European, American and TAIM (Technical Association of Industrial Metal Ceiling Manufacturers) standards by a manufacturer that have ISO9001:2008, TSE ve CE certificates.

Ceilings are tested in accordance with EN 13501-1 and must be designed to comply with at least Euroclass A2-s1-d0

Panel Description:

Raw material	Ceiling panels manufactured from ... mm Galvanised Steel/Stainless Steel/Aluminium.
Colour	Ceiling panels coated electrostatically applied powder coating coloured RAL ... (min. 60 μ thickness and approx. %20 Gloss Rate)
Acoustical inlay	Ceiling panels are manufactured with 0,2 mm thickness, black acoustical inlay (Royalin/Soundtex) to achieve sound absorption $\alpha_w = \dots$ for $\varnothing \dots$ mm Perforation (%.. open area)
Perforation	Ceiling panels are perforated $\varnothing \dots$ mm (% ... open area) and plain borders are ... mm.

Installation:

Wall anchor(3) should be used for lateral sides facing inwards of the corridors according to wall positioning and panel type. The distance between wall anchors should be 900mm. Hook-on profile is connected to wall anchor by using Bolt/Nult (4). Mounting distance between Hook-on profiles should be 5 mm less than size of panel. Lighting, sprinkler or vent places should be cutted out and the components should be mounted according to the project after the installation. In the case of these components come up to suspension system accessories, installation should be continued with mounting suspension system accesories one before and one after the components.

Suspension System:

1-AS 50-DS	Hook on Drop&Slide profile, 47x89 mm sized, 3000 mm length, 2 mm thickness, galvanised steel
2-AS 30	Wall anchor, 30x50x100 mm sized, 1,5 mm thickness galvanised steel
3-VDS 60	Bolt/nult, $\varnothing 6$ mm

PANEL BAĞLANTI DETAYLARI
PANEL CONNECTION DETAILS

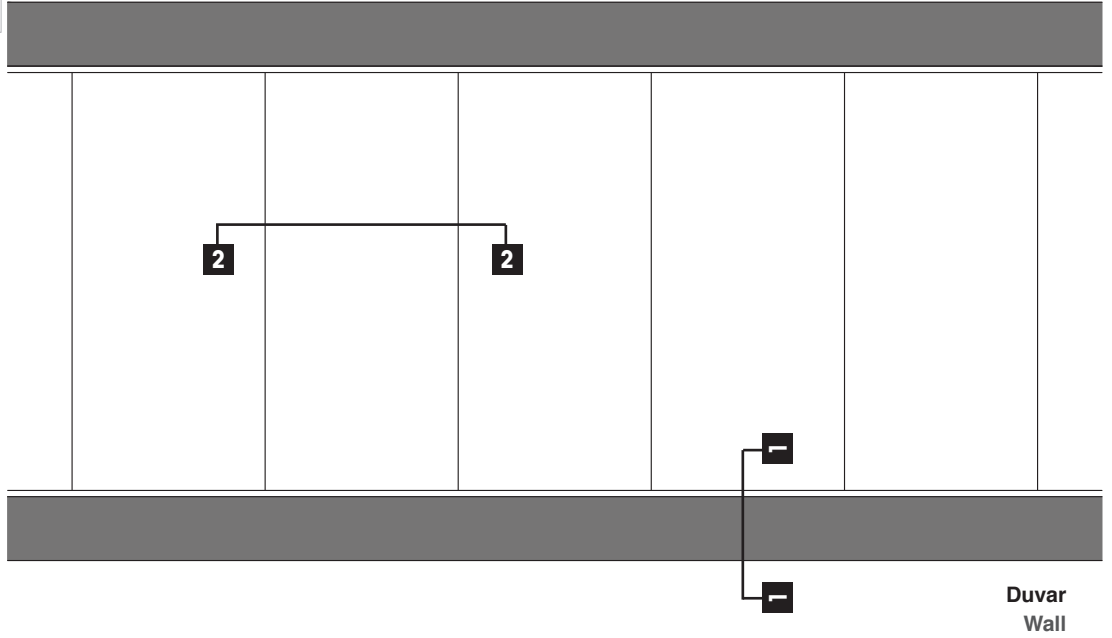

1-1 Kesiti / Section 1-1

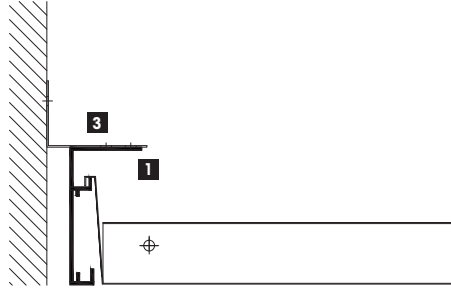

Taşıyıcı - Panel Birleşimi

1 Hook-on DS Profil

3 Duvar Bağlantı Pabucu

Profile - Panel Connection

1 Hook-on Profile

3 Wall Anchor

2-2 Kesiti / Section 2-2

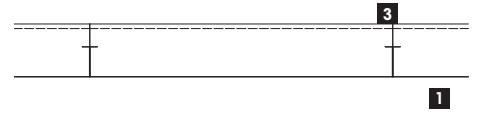

Panel Birleşimi

1 Drop&Slide Profil

3 Duvar Bağlantı Pabucu

Panel Connection

1 Drop&Slide Profile

3 Wall Anchor

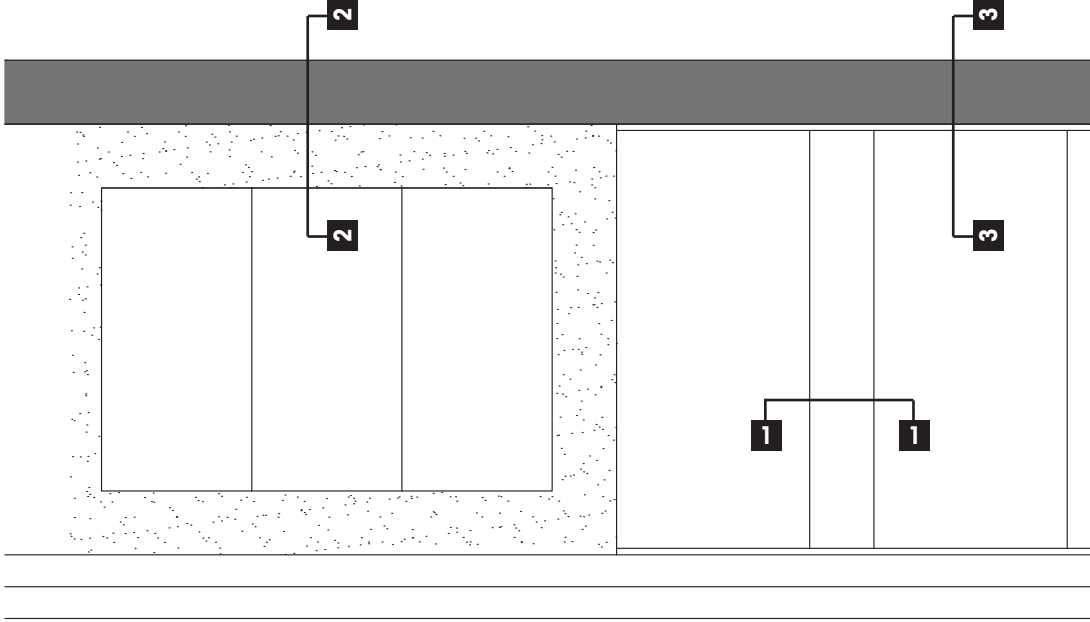

Cephe
Facade

1-1 Kesiti / Section 1-1

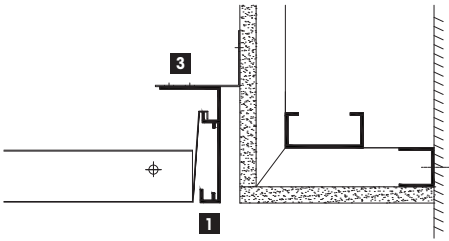

Kapama Paneli - Metal Tavan Birleşimi

- 1 Drop&Slide Profil
- 3 Duvar Bağlantı Pabucu

Covering Panel - Metal Ceiling Connections

- 1 Drop&Slide Profile
- 3 Wall Anchor

2-2 Kesiti / Section 2-2

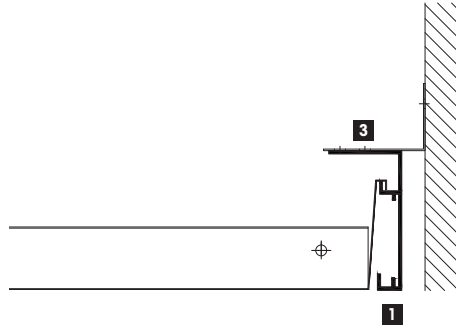

Duvar-Tavan Bağlantıları

- 1 Drop&Slide Profil
- 3 Duvar Bağlantı Pabucu

Ceiling-Wall Connections

- 1 Drop&Slide Profile
- 3 Wall Anchor

PANEL BAĞLANTI DETAYLARI
PANEL CONNECTION DETAILS

3-3 Kesiti / Section 3-3

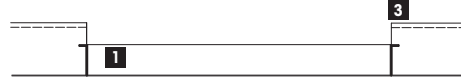

Duvar-Tavan Bağlantıları

1 Drop&Slide Profil

3 Duvar Bağlantı Pabucu

Ceiling-Wall Connections

1 Drop&Slide Profile

3 Wall Anchor

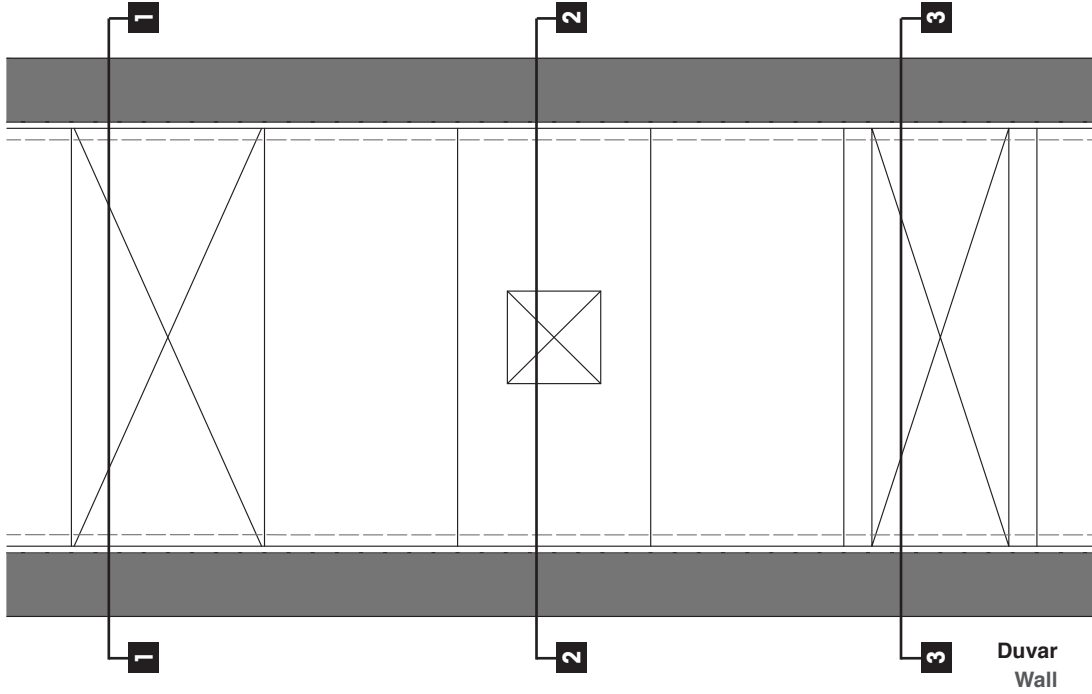

1-1 Kesiti / Section 1-1

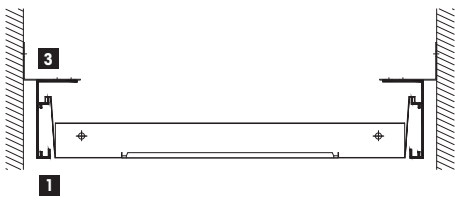

2-2 Kesiti / Section 2-2

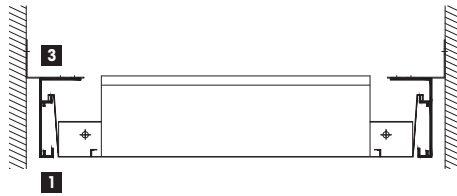

Cut-out Yapılmış Tavan Paneli

1 Drop&Slide Profil

3 Duvar Bağlantı Pabucu

Cut-out Yapılmış Tavan Paneli

1 Drop&Slide Profil

3 Duvar Bağlantı Pabucu

Ceiling Panel with Cut-out

1 Drop&Slide Profile

3 Wall Anchor

Ceiling Panel with Cut-out

1 Drop&Slide Profile

3 Wall Anchor

PANEL BAĞLANTI DETAYLARI
PANEL CONNECTION DETAILS

3-3 Kesiti / Section 3-3

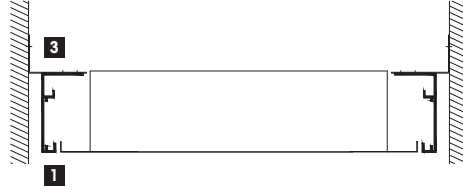

Cut-out Yapılmış Tavan Paneli

1 Drop&Slide Profil

3 Duvar Bağlantı Pabucu

Ceiling Panel with Cut-out

1 Drop&Slide Profile

3 Wall Anchor

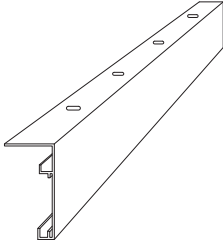

01

AS-50DS

Ürün Adı	Hook-on Drop Slide Profil Alüminyum 2 mm
Özellik / Malzeme	46,6x89,4x3000x2,0

AS-50DS

Product Reference	Hook-on Drop Slide Profile
Specification / Material	Aluminium 2 mm 46,6x89,4x3000x2,0

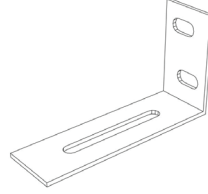

02

AS-30

Ürün Adı	Duvar Bağlantı Pabucu Galvanize Çelik 1,5 mm
Özellik / Malzeme	30x50x100x1,5

AS-30

Product Reference	Wall Anchor Galvanized Steel 1,5 mm
Specification / Material	30x50x100x1,5

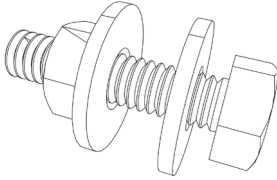

03

VDS-60

Ürün Adı	Vida/Somun/Rondela Ø6
Özellik / Malzeme	

VDS-60

Product Reference	Bolt/Nut/Washer Ø6
Specification / Material	