

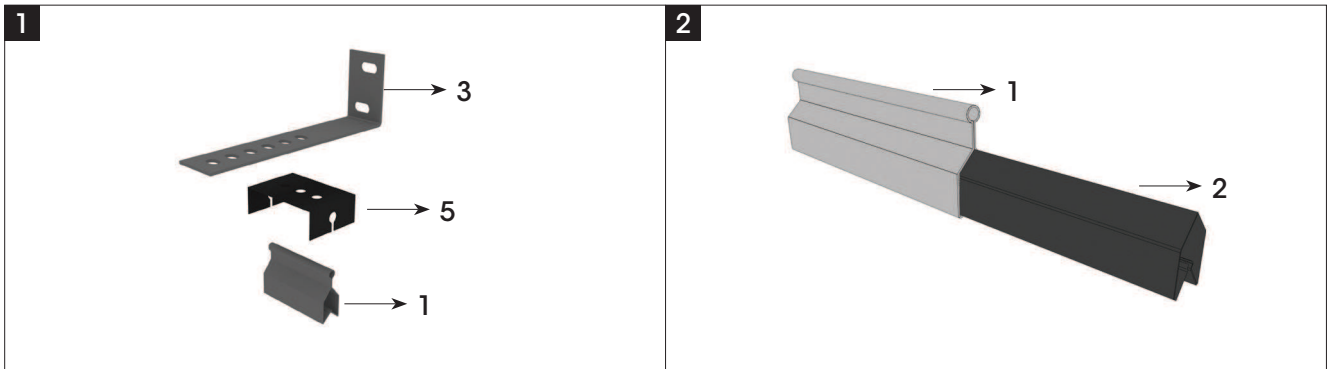

INTEGRA PLANK INTEGRA PLANK

Clip-in Plank Sistem
Clip-in Plank System

Clip-in Koridor
Clip-in Corridor

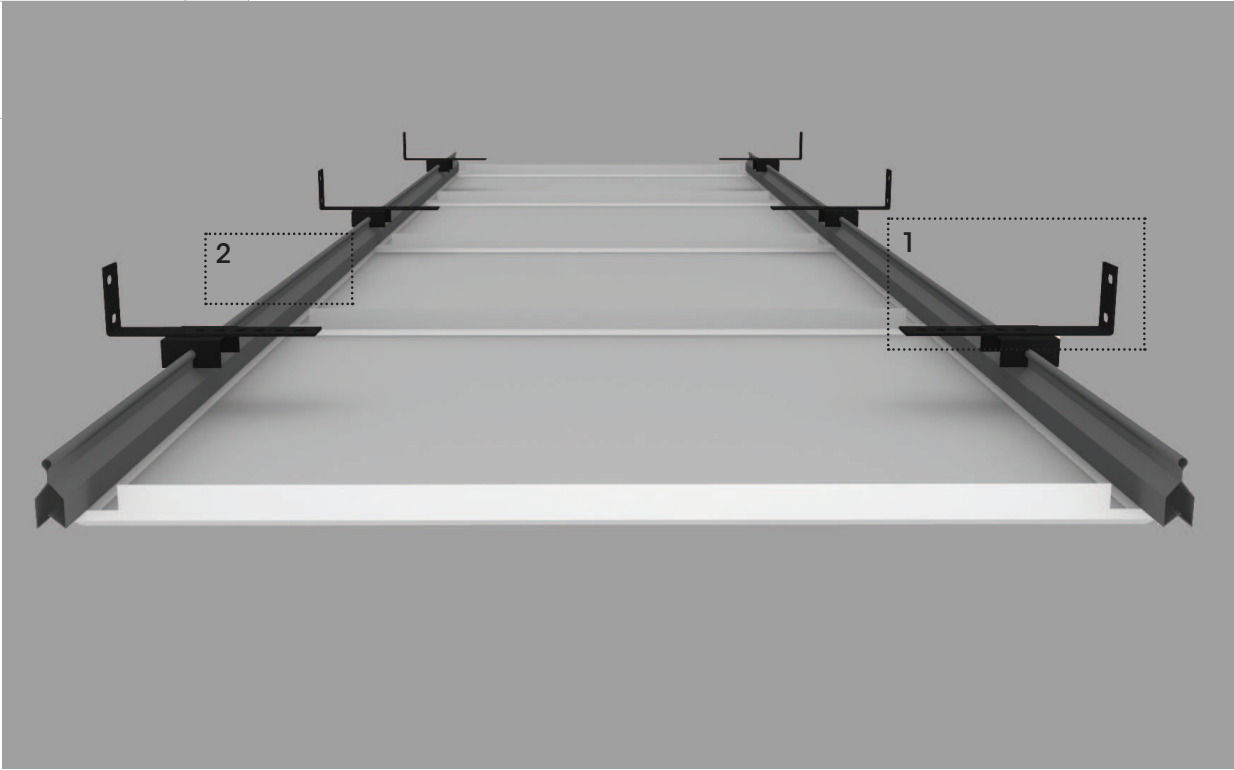

Clip-in Koridor

Integra Plank Clip-in Koridor Sistemler, farklı detay ve ölçüdeki koridorlar için ideal çözüm sunmak üzere tasarlanmıştır. Clip-in Heavy Duty (yüksek taşıma kapasiteli) taşıyıcı profili ile istendiğinde birbirinden bağımsız olarak hızlı demonte edilmekte ve tavan boşluğuna ulaşımı kolaylaştırmaktadır.

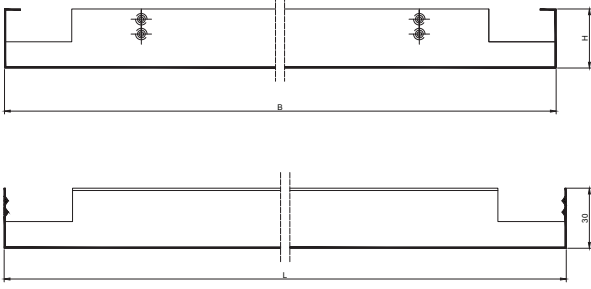
Standart Panel / Standard Panel**Panel Tanımı**

Hammadde: Galvanize çelik, Paslanmaz çelik, Alüminyum.

Kenar özelliği: Küt, Pahlı

En: 200-1200mm

Boy: 200-3000 mm

Boya: RAL 9006, RAL 9010, RAL 9016

- . İsteğe bağlı olarak tüm RAL renklerinde üretim yapılabilir.
- . Özellikle hijyen gerektiren alanlar için anti bakteriyel boya seçeneği mevcuttur.
- . İstenildiğinde ahşap görünümlü paneller üretilebilir.
- . Daha fazla bilgi için bkz. **Renk ve Desen**

Perforasyon: Ø0.7, Ø1.5, Ø1.8, Ø2.5, Ø3, Ø4.5, Ø6, Ø7, Ø16, 8x8, Random

- . Daha fazla bilgi için bkz. **Perforasyon**

Akustik: NRC 0,70(Ø2.5mm %16 boşluk oranı)
Daha fazla bilgi için bkz. **Akustik**

Yangın: Yangın tepki sınıfı A2-s1,d0.
Daha fazla bilgi için bkz. **Standartlar**

Teknik Standartlar:

- . Clip-in Heavy Duty taşıyıcı sistem ile desteklenen, ISO9001:2008, TSE ve CE belgeli tesisimizde Avrupa, Amerika ve TAIM (Technical Association of Industrial Metal Ceiling Manufacturers) standartlarına uygun olarak imal edilmektedir.
- . Malzemenin yangın tepki sınıfı, uluslar arası akredite edilmiş test kuruluşlarında yaptırılmış yangın testi ile EN 13501-1 standardı uyarınca yapılan sınıflandırma sonucu A2-s1,d0 olarak belgelenmiştir.

Clip-in Corridor

Integra Clip-in Corridor Systems are designed to offer ideal solutions for corridors of different sizes and details. Clip-in Corridor panels with their Heavy duty Clip-in profiles offer the advantage of quick demounting and easy access to the ceiling void.

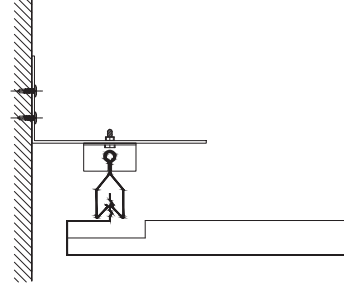
Standart Birleşim / Standard Connection**Panel Description**

Raw material: Galvanized Steel, Stainless Steel, Aluminium.

Edge Option: Square, Bevelled

Width: 200-1200mm

Length: 200-3000 mm

Colour: RAL9006, RAL9010, RAL9016

- . Production is possible in all other RAL colours upon request.
- . Antibacterial paint option is available upon request, especially for areas with hygiene requirements.
- . Panels with wood appearance can be produced if requested.
- . For detailed information please see **Colours and Design**.

Perforation: Ø0.7, Ø1.5, Ø1.8, Ø2.5, Ø3, Ø4.5, Ø6, Ø7, Ø16, 8x8, Random

For detailed information please see **Perforation**.

Acoustics: NRC: 0,70(Ø2.5mm %16 open area)
For detailed information please see **Acoustics**.

Fire: Reaction to Fire Class A2-s1,d0.
For detailed information please see **Standards**.

Technical Standards:

- . Ceiling panels supported by fully concealed Clip-in Heavy duty suspension system manufactured in accordance with European, American and TAIM (Technical Association of Industrial Metal Ceiling Manufacturers) standards in our factory that have ISO9001:2008, TSE ve CE certificates.
- . Panels are tested in accordance with EN 13501-1 and must be designed to comply with Euroclass A2-s1, d0

METAL CEILING SPECIFICATION

... x ... mm Sized Clip-in Corridor System

General Description:

Galvanised Steel/Stainless Steel/Aluminium ceiling panels supported by fully concealed Clip-in heavy duty suspension system manufactured in accordance with European, American and TAIM (Technical Association of Industrial Metal Ceiling Manufacturers) standards by a manufacturer that have ISO9001:2008, TSE ve CE certificates.

Ceilings are tested in accordance with EN 13501-1 and must be designed to comply with at least Euroclass A2-s1, d0

Panel Description:

- Raw material** : Ceiling panels manufactured from ... mm Galvanised Steel/Stainless Steel/Aluminium.
Colour : Ceiling panels coated electrostatically applied powder coating coloured RAL ... (min. 40 μ thickness and approx. %20 Gloss Rate)
Acoustical inlay : Ceiling panels are manufactured with 0,2 mm thickness, black acoustical inlay (Royalin/Soundtex) to achieve sound absorption $\alpha_w = \dots$ for $\varnothing \dots$ mm Perforation (%.. open area)
Perforation : Ceiling panels are perforated $\varnothing \dots$ mm (% ... open area) and plain borders are ... mm.
Edge : Bevelled/Square and double point emboss.

Installation:

Wall anchor(3) should be used for lateral sides facing inwards of the corridors according to wall positioning and panel type. The distance between wall anchors should be 900mm. TRK-02 profile(5) should be connected to wall anchor by using Bolt/Nult (4). Heavy Duty Clip-in Profile(1) will be installed on TRK-02 profile securely. In order to add one clip-in profile to another linearly; Heavy Duty Clip-in splice(2) should be used. All Clip-in panels should be removed with a special tool during the installation or later to access to the ceiling void. Lighting, sprinkler or vent places should be cutted out and the components should be mounted according to the project after the installation. In the case of these components come up to suspension system accessories, installation should be continued with mounting suspension system accessories one before and one after the components.

Suspension System:

- 1- KPH-40** : Heavy Duty Clip-in profile, 4000 mm length, 0,6 mm thickness, galvanised steel.
2- KPS 42 : Heavy Duty Clip-in profile splice, 145 mm length, 0,5 mm thickness, galvanised steel.
3- AS 30 : Wall anchor, 30x50x100 mm sized, 1,5 mm thickness galvanised steel
4- VDS 60 : Bolt/nult, $\varnothing 6$ mm
5- TRK-02 : Clip-in lining clip 20x42,4x60mm sized, 2mm thickness galvanised steel

PANEL BAĞLANTI DETAYLARI
PANEL CONNECTION DETAILS

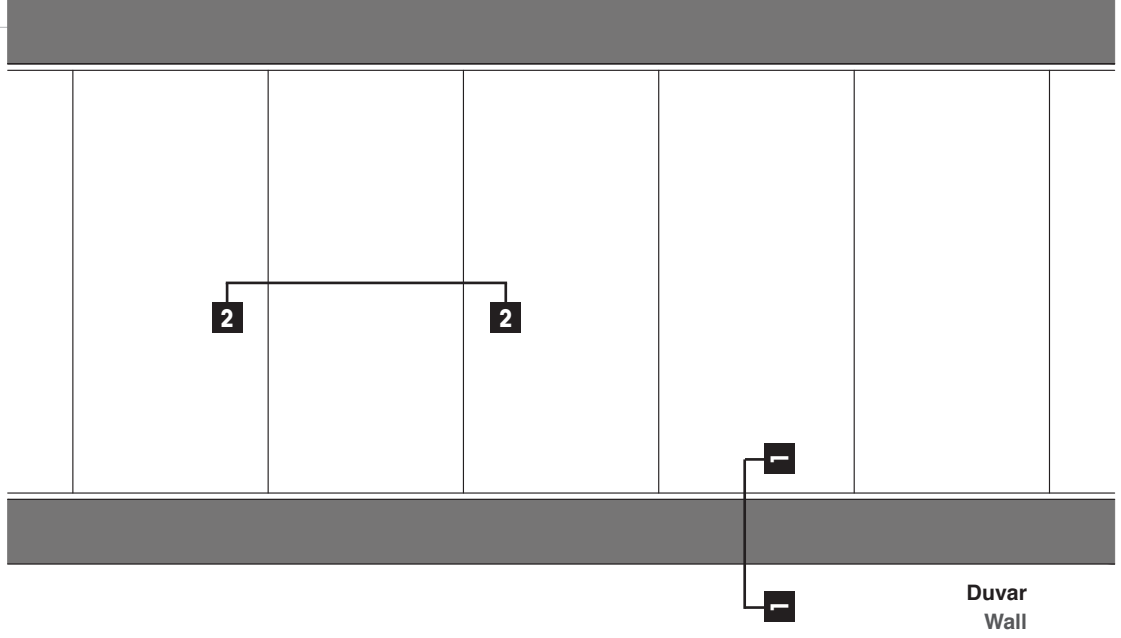

1-1 Kesiti / Section 1-1

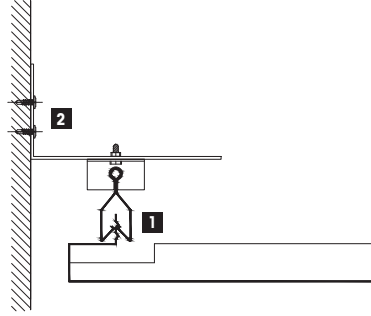

Panel - Taşıyıcı Birleşimi

1 Heavy duty clip-in taşıyıcı

2 Duvar Bağlantı Pabucu

Panel - Profilo Connection

1 Heavy duty clip-in profile

2 Wall Anchor

2-2 Kesiti / Section 2-2

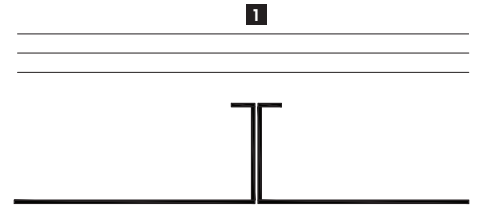

Panel Birleşimi

1 Heavy duty clip-in taşıyıcı

Connection of Panels

1 Heavy duty clip-in profile

METAL VE DİĞER TAVANLARIN BİRLEŞİM DETAYLARI
DETAILS OF METAL AND OTHER CEILING CONNECTION

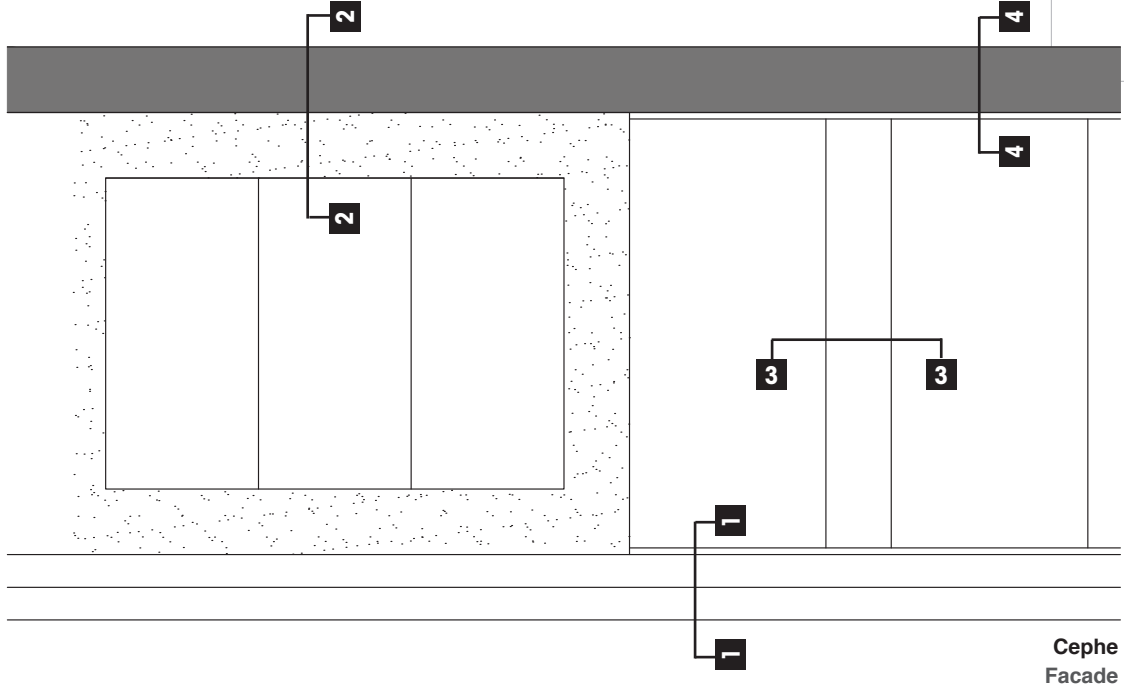

1-1 Kesiti / Section 1-1

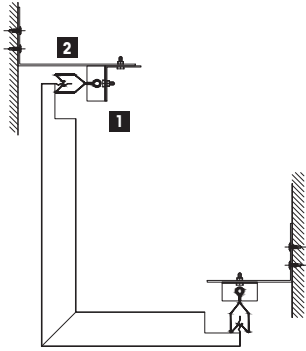

Alternatif 1

Clip-in Profil ile Alın Panel Bitişi
1 Heavy duty clip-in taşıyıcı
2 Duvar Bağlantı Pabucu

Alternative 1

L Panel Finish with Clip-in Profile
1 Heavy duty clip-in profile
2 Wall Anchor

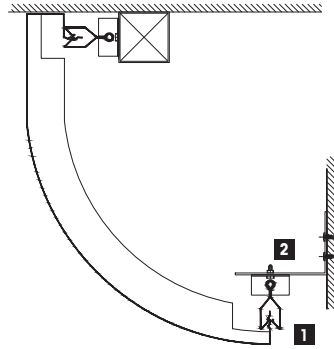

Alternatif 2

Clip-in Profil ile Alın Panel Bitişi
1 Heavy duty clip-in taşıyıcı
2 Duvar Bağlantı Pabucu

Alternative 2

L Panel Finish with Clip-in Profile
1 Heavy duty clip-in profile
2 Wall Anchor

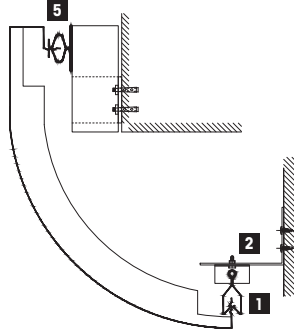

Alternatif 3

Diversa Yarım Dikme ile Alın Panel Bitişi
1 Heavy duty clip-in taşıyıcı
2 Duvar Bağlantı Pabucu
5 Diversa yarım dikme

Alternative 3

L Panel Finish with Diversa Half Upright
1 Heavy duty clip-in profile
2 Wall Anchor
5 Diversa half upright

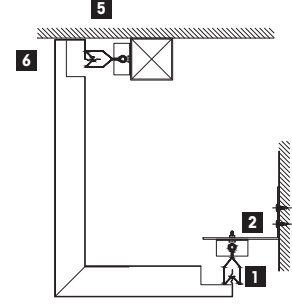

Alternatif 4

Clip-in Profil ile Alın Panel Bitişi
1 Heavy duty clip-in taşıyıcı
2 Duvar Bağlantı Pabucu

Alternative 4

L Panel Finish with Clip-in Profile
1 Heavy duty clip-in profile
2 Wall Anchor

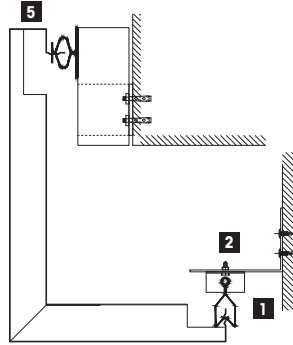

Alternatif 5

Diversa Yarım Dikme ile Alın Panel Bitişi
1 Heavy duty clip-in taşıyıcı
2 Duvar Bağlantı Pabucu
5 Diversa yarım dikme

Alternative 5

Curvilinear Panel Finish with Diversa Half Upright
1 Heavy duty clip-in profile
2 Wall Anchor
5 Diversa half upright

2-2 Kesiti / Section 2-2

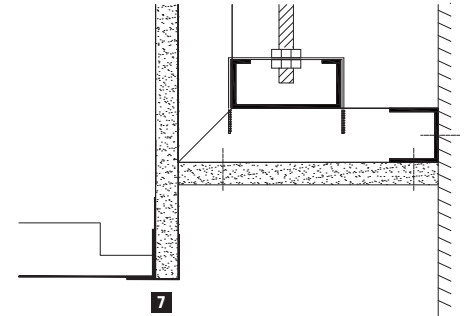

Alternatif 1

F Profil ile Alçıpan-Metal Tavan Birleşimi
7 F Profil

Alternative 1

Joint to a Gypsum Board with F Profile
7 F Profile

3-3 Kesiti / Section 3-3

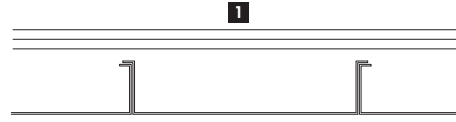
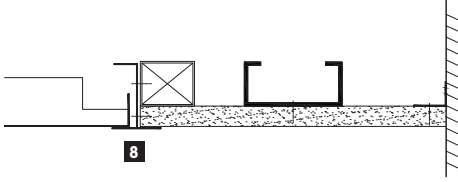

Alternatif 2

H Profil ile Alçıpan - Metal Tavan Birleşimi

8 H Profil

Kapama Paneli - Metal Tavan Birleşimi

1 Heavy duty clip-in taşıyıcı

Alternative 2

Joint to a Gypsum Board with H Profile

8 T-15 Main Runner

Joint to Metal Ceiling with Covering Panel

1 Heavy duty clip-in profile

4-4 Kesiti / Section 4-4

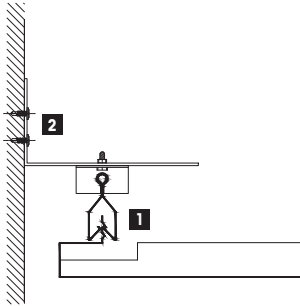

Duvar-Tavan Bağlantıları

Tam Plaka Duvar Bitişi

1 Heavy duty clip-in taşıyıcı

2 Duvar Bağlantı Pabucu

Ceiling-Wall Connections

Full Panel Finish

1 Heavy duty clip-in profile

2 Wall Anchor

CUTOUT YAPILMIŞ PANEL DETAYLARI
PANELS WITH CUT-OUT DETAILS

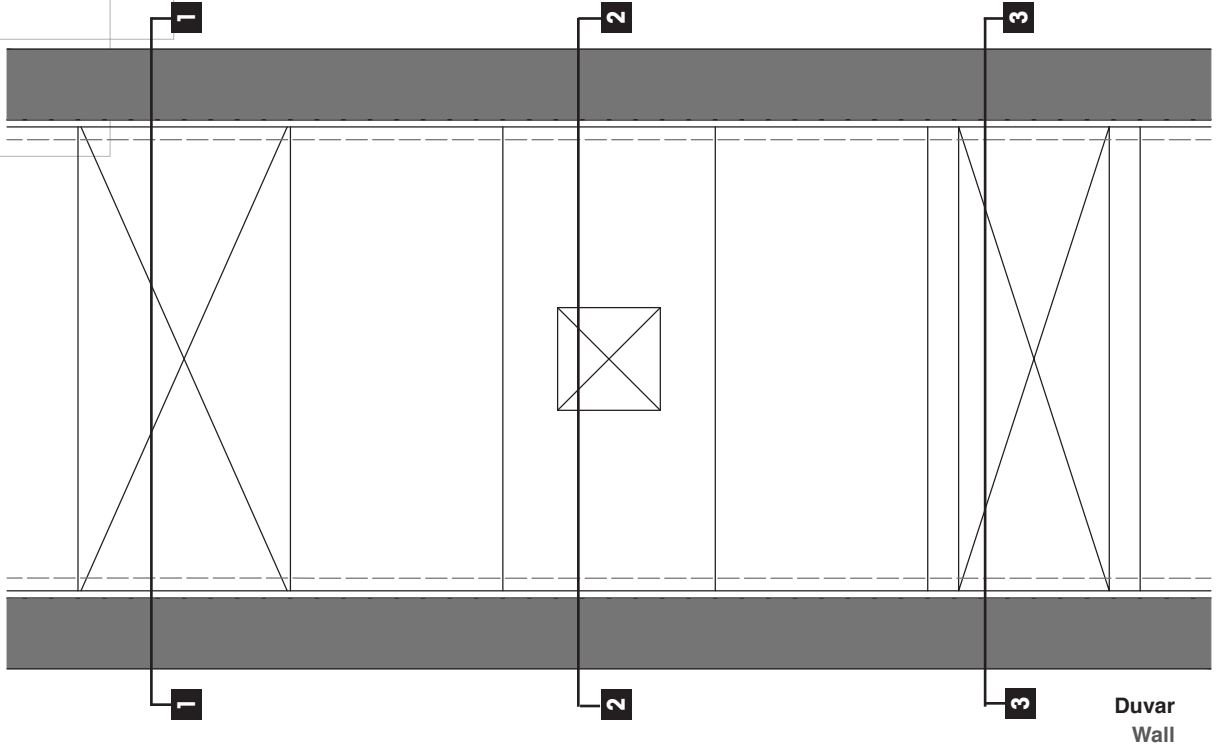

1-1 Kesiti / Section 1-1

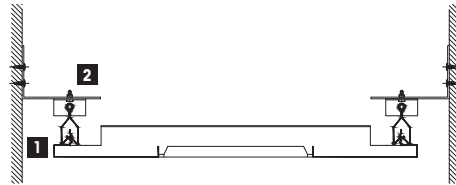

Cut-out Yapılmış Tavan Paneli

- 1 Heavy duty clip-in taşıyıcı
- 2 Duvar Bağlantı Pabucu

Ceiling Panel with Cut-out

- 1 Heavy duty clip-in profile
- 2 Wall Anchor

2-2 Kesiti / Section 1-1

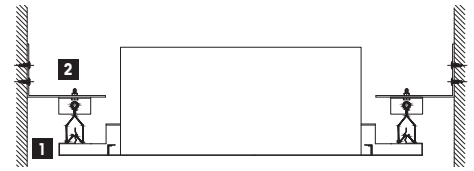

Cut-out Yapılmış Tavan Paneli

- 1 Heavy duty clip-in taşıyıcı
- 2 Duvar Bağlantı Pabucu

Ceiling Panel with Cut-out

- 1 Heavy duty clip-in profile
- 2 Wall Anchor

3-3 Kesiti / Section 3-3

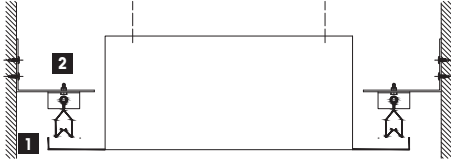

Cut-out Yapılmış Tavan Paneli

1 Heavy duty clip-in taşıyıcı

2 Duvar Bağlantı Pabucu

Ceiling Panel with Cut-out

1 Heavy duty clip-in profile

2 Wall Anchor

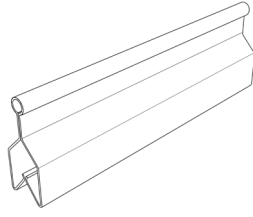

01

KPH 40	
Ürün Adı Özellik / Malzeme	Heavy Duty Clip-in Taşıyıcı Profil Galvanize Çelik 0,6 mm

KPH 40	
Product Reference Specification / Material	Heavy Duty Clip-in Profile Galvanized Steel 0,6 mm

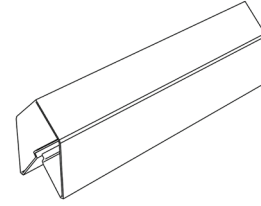

02

KPS 42	
Ürün Adı Özellik / Malzeme	Heavy Duty Ekleme Parçası Galvanize Çelik 0,5 mm

KPS 42	
Product Reference Specification / Material	Heavy Duty Profile Splice Galvanized Steel 0,5 mm

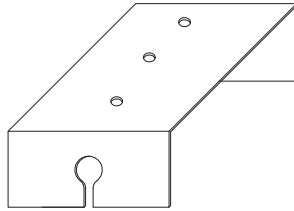

03

TRK 02	
Ürün Adı Özellik / Malzeme	Profil yönlendirme elemanı Galvanize Çelik 2 mm 20x42,4x60x2mm

TRK 02	
Product Reference Specification / Material	Lining Clip Galvanized Steel 2 mm 20x42,4x60x2mm

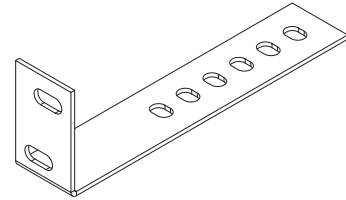

04

TRK 03	
Ürün Adı Özellik / Malzeme	Duvar bağlantı elemanı Galvanize Çelik 2 mm 30x50x150x2mm

TRK 03	
Product Reference Specification / Material	Wall connector Galvanized Steel 2 mm 30x50x150x2mm

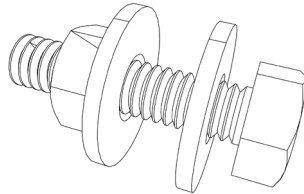

05

VDS-60	
Ürün Adı Özellik / Malzeme	Vida/Somun/Rondela Ø6

VDS-60	
Product Reference Specification / Material	Bolt/Nut/Washer Ø6

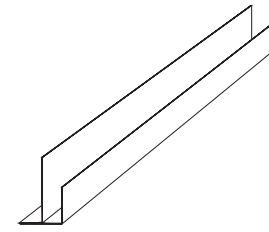

06

FDPR-3000	
Ürün Adı Özellik / Malzeme	F Profil Alüminyum 1 mm

FDPR-3000	
Product Reference Specification / Material	F Profile Aluminium 1 mm