

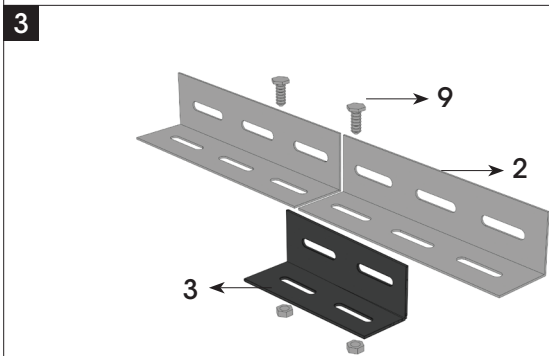

# INTEGRA PLANK INTEGRA PLANK

## Perspekta Plank Sistem Perspekta Plank System

Perspekta C Bandraster  
Perspekta C Bandraster

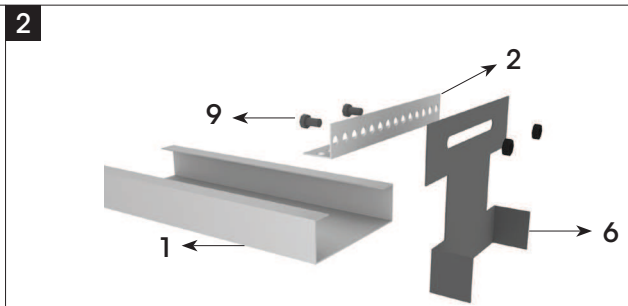
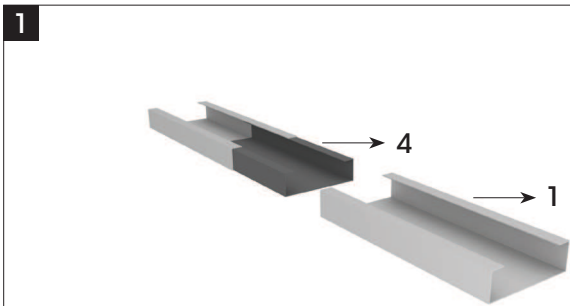
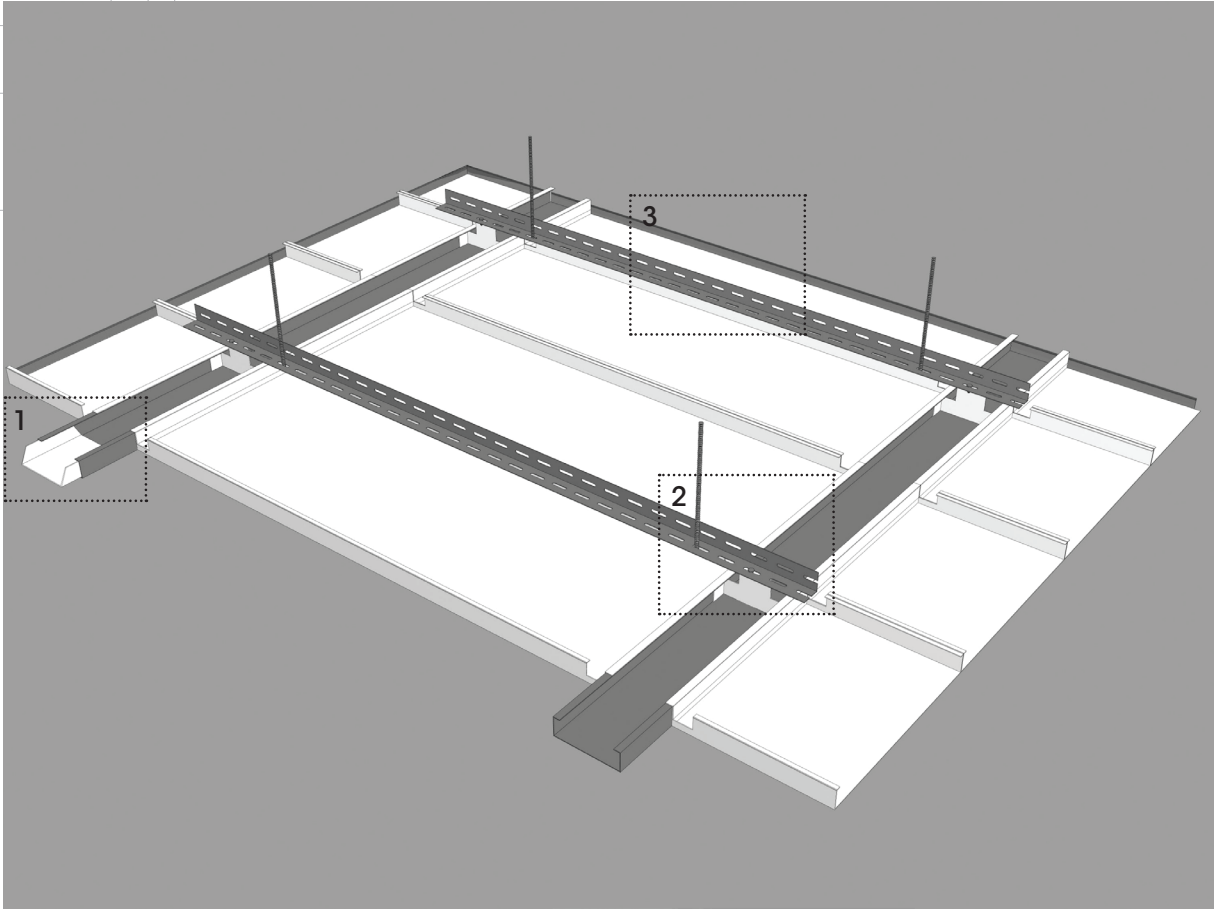

**Perspekta C Bandraster**

Integra Plank Perspekta C Bandraster Sistemleri farklı genişlikte bandraster seçenekleriyle asma tavan yüzeyinde kesintisiz bir görünüm oluşturarak, mimarlara çağdaş uygulama seçenekleri sunar. Her türlü mimari tasarıma uygun çeşitli malzeme seçenekleriyle üretilmesi mümkündür. Tüm Perspekta panelleri sökme aparatı gerektirmeden kolaylıkla demonte edilebilir.

Standart Panel / Standard Panel

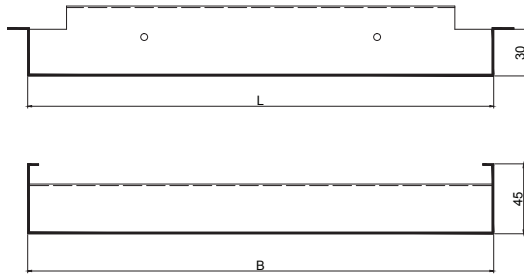
**Panel Tanımı**

**Hammadde:** Galvanize çelik, Paslanmaz çelik, Alüminyum.

**Kenar özelliği:** Küt

**En:** 200-1200 mm

**Boy:** 200-3000 mm

**Boya:** RAL 9006, RAL 9010, RAL 9016

- . İsteğe bağlı olarak tüm RAL renklerinde üretim yapılabilir.
- . Özellikle hijyen gerektiren alanlar için anti bakteriyel boya seçeneği mevcuttur.
- . İstenildiğinde ahşap görünlü paneller üretilebilir.
- . Daha fazla bilgi için bkz. **Renk ve Desen**

**Perforasyon:** Ø0.7, Ø1.5, Ø1.8, Ø2.5, Ø3 Ø4.5, Ø6, Ø7, Ø16, 8x8, Random

Daha fazla bilgi için bkz. **Perforasyon**

**Akustik:** NRC 0,70(Ø2.5mm %16 boşluk oranı)

Daha fazla bilgi için bkz. **Akustik**

**Yangın:** Yangın tepki sınıfı A2-s1,d0.

Daha fazla bilgi için bkz. **Standartlar**

**Teknik Standartlar:**

- . Taşıyıcı sistem ile desteklenen paneller, ISO9001:2008, TSE ve CE belgeli tesisimizde Avrupa, Amerika ve TAIM (Technical Association of Industrial Metal Ceiling Manufacturers) standartlarına uygun olarak imal edilmektedir.
- . Malzemenin yangın tepki sınıfı, uluslar arası akredite edilmiş test kuruluşlarında yaptırılmış yangın testi ile EN 13501-1 standardı uyarınca yapılan sınıflandırma sonucu A2-s1,d0 olarak belgelenmiştir.

**Perspekta C Bandraster**

Integra Plank, Perspekta C Bandraster Systems provide architects with modern application alternatives in places where aesthetics is in the foreground by forming a ceaseless appearance on the surface of the ceiling with C Bandrasters which can be in different widths and details. The panels can be produced for all kinds of architectural design, in different material options. All Perspekta panels can be easily unassembled without any tools.

Standart Birleşim / Standard Connection

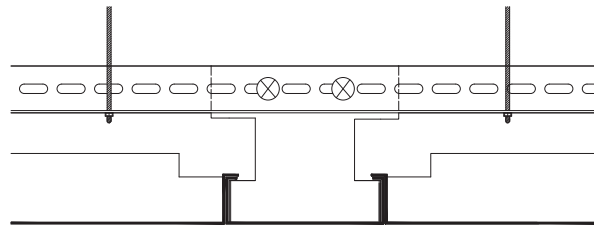
**Panel Description**

**Raw material:** Galvanized Steel, Stainless Steel, Aluminium.

**Edge Option:** Square

**Width:** 200-1200 mm

**Length:** 200-3000 mm

**Colour:** RAL9006, RAL9010, RAL9016

- . Production is possible in all other RAL colours upon request.
- . Antibacterial paint option is available upon request, especially for areas with hygiene requirements.
- . Panels with wood appearance can be produced if requested.
- . For detailed information please see **Colours and Design**.

**Perforation:** Ø0.7, Ø1.5, Ø1.8, Ø2.5, Ø3, Ø4.5, Ø6, Ø7, Ø16, 8x8, Random

For detailed information please see **Perforation**.

**Acoustics:** NRC: 0,70(Ø2.5mm %16 open area)

For detailed information please see **Acoustics**.

**Fire:** Reaction to Fire Class A2-s1,d0.

For detailed information please see **Standards**.

**Technical Standards:**

- . Ceiling panels supported by a suspension system manufactured in accordance with European, American and TAIM (Technical Association of Industrial Metal Ceiling Manufacturers) standards in our factory that have ISO9001:2008, TSE ve CE certificates.
- . Panels are tested in accordance with EN 13501-1 and must be designed to comply with Euroclass A2-s1, d0



## METAL CEILING SPECIFICATION

... x ... mm Sized Perspekta C Bandraster System

### General Description:

Galvanised Steel/Aluminium ceiling panels supported by fully concealed suspension system manufactured in accordance with European, American and TAIM (Technical Association of Industrial Metal Ceiling Manufacturers) standards by a manufacturer that have ISO9001:2000, TSE ve CE certificates.

Ceilings are tested in accordance with EN 13501-1 and must be designed to comply with at least Euroclass A2-s1,d0

### Panel Description:

<b>Raw material</b>	Ceiling panels manufactured from ... mm Galvanised Steel/Stainless Steel/Aluminium.
<b>Colour</b>	Ceiling panels coated electrostatically applied powder coating coloured RAL ... ( min. 40 $\mu$ thickness and approx. %20 Gloss Rate)
<b>Acoustical inlay</b>	Ceiling panels are manufactured with 0,2 mm thickness, black acoustical inlay (Royalin/Soundtex) to achieve sound absorption $\alpha_w = \dots$ for $\varnothing \dots$ mm Perforation (%.. open area)
<b>Perforation Edge</b>	Ceiling panels are perforated $\varnothing \dots$ mm (% ... open area) and plain borders are ... mm. Square

### Installation:

C-Wall Angle(4) should be used for lateral sides facing inwards of the gypsum pool. C Bandraster wall anchor should be used if there is no C wall angle. The first hanger system should not exceed 450 mm distance from the wall and the distance between hangers could be max 1000mm. Threaded Rod(10) , Bolt/Nut (9) and threaded rod anchor(11) will be used to suspend the C Bandraster Profile(1) securely. The distance between Wall-angle and the main runner should be max. 600 mm. The distance between the main runners should not exceed 1200mm. The cross runners should be positioned on 600 mm away from each. C Bandraster and Primary L runners are connected by C Bandraster Rigid Hanger(6). In order to add one C Bandraster profile or Primary L runner to another lienarly; C Bandraster profile splice(3) or Primary L runner Splice(4) should be used. Lighting, sprinkler or vent places should be cutted out and the components should be installed according to the project after the installation. In the case of these components come up to suspension system accessories, installation should be continued with mounting suspension system accesories one before and one after the components.

### Suspension System:

<b>1-CBP-100-L400-9010</b>	C Bandraster Profile, 100 mm width, 4000 mm length, 1 mm thickness, galvanised steel
<b>2-AS 20</b>	Primary L Runner, Lsectioned, 30x30 mm sized, 4000 mm length, 1 mm thickness, galvanised steel
<b>3-CBP-ZL-100</b>	C Bandraster Profile Splice
<b>4-AS 25</b>	Primary L Runner splice
<b>5-CBP-ZW-100</b>	C Bandraster Wall Anchor, 1 mm thickness, galvanised steel. ( if there is no C-Wall Angle).
<b>6-CBP-ZA-100</b>	C Bandraster Rigid Hanger, 1 mm thickness, galvanised steel.
<b>7-CDPR 300</b>	C-Wall Angle, 20x40x20 mm sized, 3000 mm length, 0,5 mm thickness, pre-painted galvanised steel
<b>8-KT 40</b>	Wedge Clip, 0,5 mm thickness, galvanised steel
<b>9-VDS 60</b>	Bolt/nult, $\varnothing 6$ mm
<b>10-ATJ 100</b>	Threaded Rod, $\varnothing 6$ mm, 1000mm length (Standard)
<b>11-TD-06</b>	Threaded Rod Anchor

PANEL BAĞLANTI DETAYLARI  
PANEL CONNECTION DETAILS

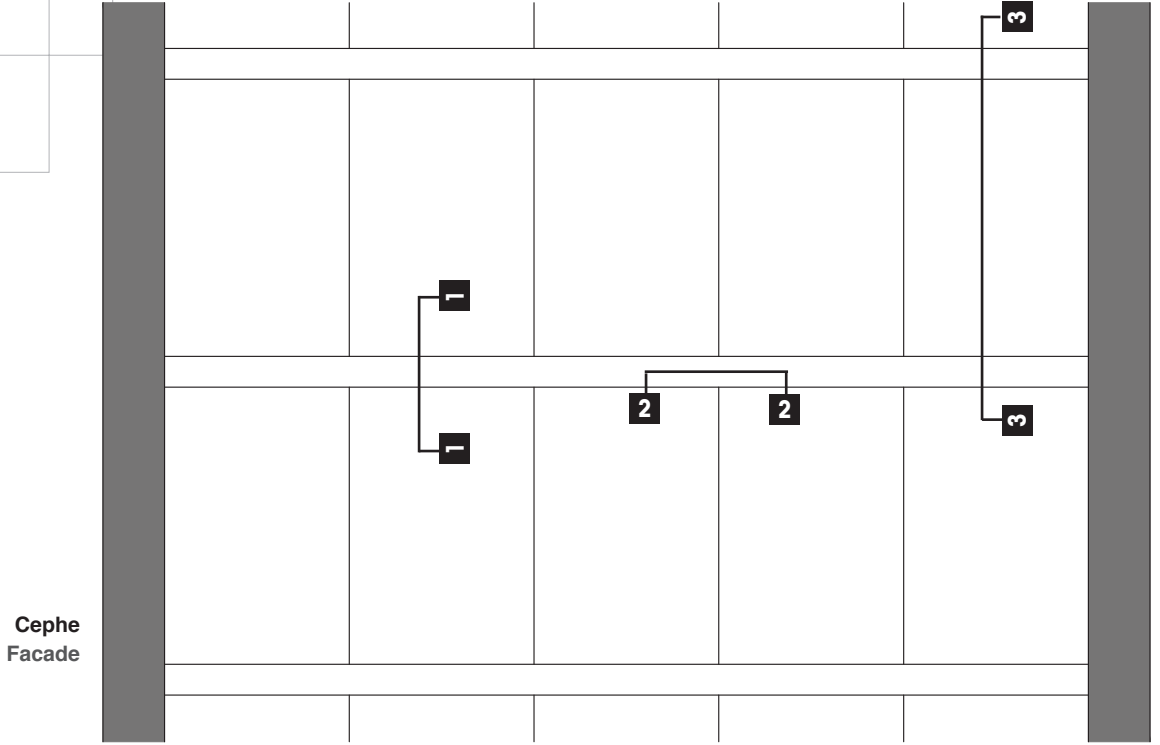

1-1 Kesiti / Section 1-1

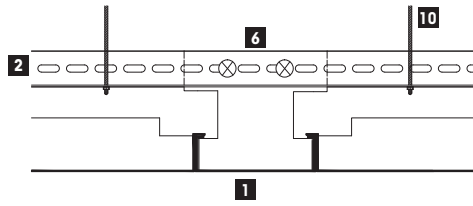

Taşıyıcı Profil - Panel Birleşimi

1	C Bandraster Profil
2	Ana L taşıyıcı
6	C Bandraster Ana L taşıyıcı Askı Parçası
10	Askı tiji

Runner - Panel Connection

1	C Bandraster Profile
2	Primary L runner
6	C Bandraster Rigid Hanger
10	Threaded Rod

2-2 Kesiti / Section 2-2

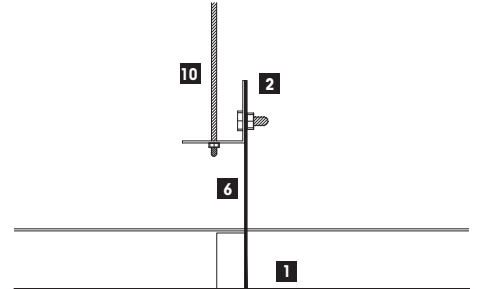

Taşıyıcı Profil - Bandraster Birleşimi

1	C Bandraster Profil
2	Ana L taşıyıcı
6	C Bandraster Ana L taşıyıcı Askı Parçası
10	Askı tiji

Runner - Bandraster Connection

1	C Bandraster Profile
2	Primary L runner
6	C Bandraster Rigid Hanger
10	Threaded Rod

3-3 Kesiti / Section 3-3

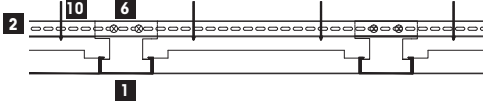

Panel Birleşimi

1 C Bandraster Profil

2 Ana L taşıyıcı

6 C Bandraster Ana L taşıyıcı Askı Parçası

10 Askı tiji

Connection of Panels

1 C Bandraster Profile

2 Primary L runner

6 C Bandraster Rigid Hanger

10 Threaded Rod

METAL VE DİĞER TAVANLARIN BİRLEŞİM DETAYLARI  
METAL AND OTHER CEILING CONNECTION DETAILS

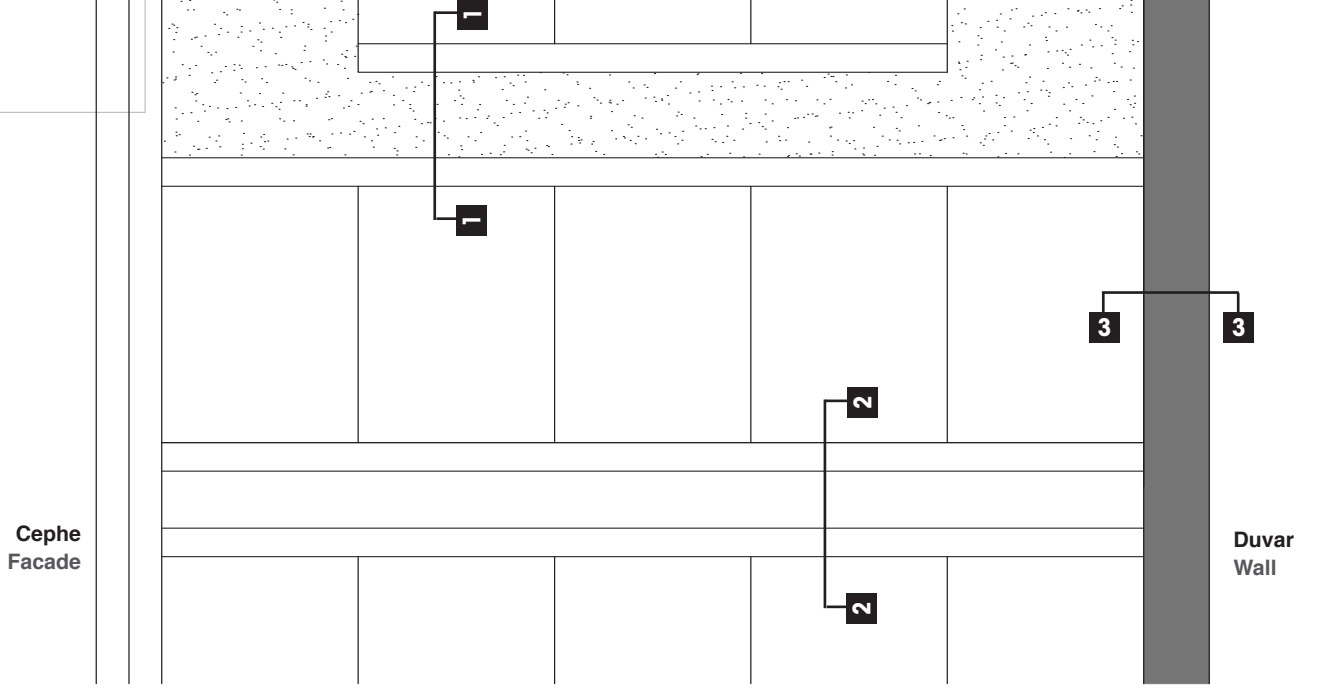

1-1 Kesiti / Section 1-1

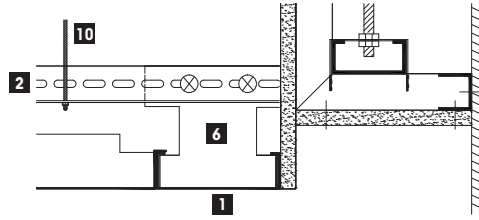

Alternatif 1

F Profil ile Alçıpan - Metal Tavan Birleşimi

1	C Bandraster Profil
2	Ana L Taşıyıcı
6	C Bandraster Ana L taşıyıcı Askı Parçası
10	Askı tiji

Alternative 1

Joint to a Gypsum Board with F Profile

1	C Bandraster Profile
2	Primary L Runner
6	C Bandraster Rigid Hanger
10	Threaded Rod

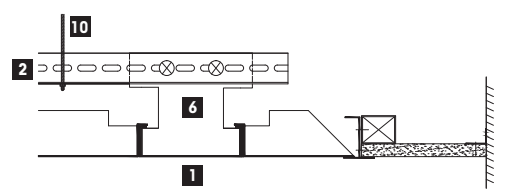

Alternatif 2

Özel L Profil ile Alçıpan - Metal Tavan Birleşimi

1	C Bandraster Profil
2	Ana L Taşıyıcı
6	C Bandraster Ana L taşıyıcı Askı Parçası
10	Askı tiji

Alternative 2

Joint to a Gypsum Board with Special L Profile

1	C Bandraster Profile
2	Primary L Runner
6	C Bandraster Rigid Hanger
10	Threaded Rod

2-2 Kesiti / Section 2-2

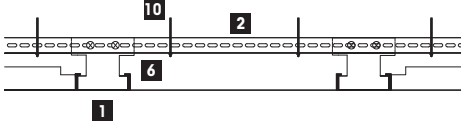

Alternatif 3

Kapama Paneli - Metal Tavan Birleşimi

1	C Bandraster Profil
2	Ana L Taşıyıcı
6	C Bandraster Ana L taşıyıcı Askı Parçası
10	Askı tiji

Alternative 3

Joint to Metal Ceiling with Covering Panel

1	C Bandraster Profile
2	Primary L Runner
6	C Bandraster Rigid Hanger
10	Threaded Rod

3-3 Kesiti / Section 3-3

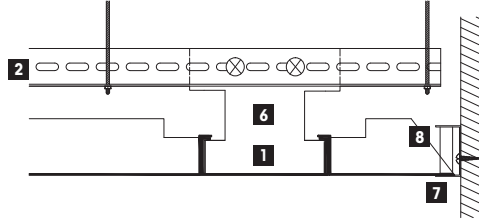

Alternatif 4 Duvar-Tavan Bağlantıları

C Köşebent ile Kesik Plaka Duvar Bitişi

1	C Bandraster Profil
2	Ana L taşıyıcı
6	C Bandraster Ana L taşıyıcı Askı Parçası
7	C Köşebent
8	Kenar Takoğu

Alternative 4 Ceiling-Wall Connections

Cutted Panel Finish with C Wall Angle

1	C Bandraster Profile
2	Primary L runner
6	C Bandraster Rigid Hanger
7	C Wall Angle
8	Wedge Clip

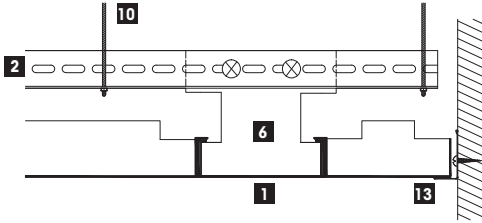

Alternatif 5

L Köşebent ile Tam Plaka Duvar Bitişi

1	C Bandraster Profil
2	Ana L taşıyıcı
6	C Bandraster Ana L taşıyıcı Askı Parçası
10	Askı tiji
13	L Köşebent

Alternative 5

Full Panel Finish with L Wall Angle

1	C Bandraster Profile
2	Primary L runner
6	C Bandraster Rigid Hanger
10	Threaded Rod
13	L Wall Angle

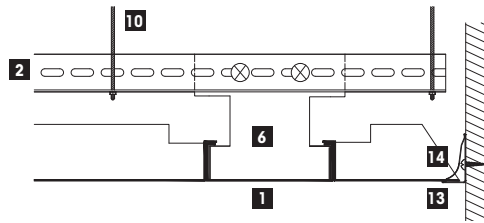

Alternatif 3

L Köşebent ile Kesik Plaka Duvar Bitişi

1	C Bandraster Profil
2	Ana L taşıyıcı
6	C Bandraster Ana L taşıyıcı Askı Parçası
10	Askı tiji
13	L Köşebent
14	Kenar Takoğu

Alternative 3

Cutted Panel Finish with L Wall Angle

1	C Bandraster Profile
2	Primary L runner
6	C Bandraster Rigid Hanger
10	Threaded Rod
13	L Wall Angle
14	Wedge Clip



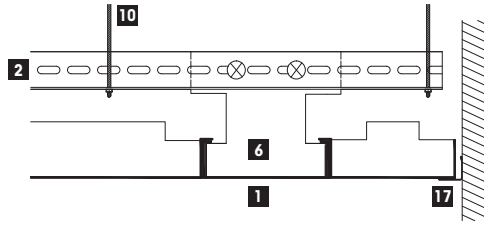

#### Alternatif 4

##### Grida L Köşebent ile Tam Plaka Duvar Bitişi

1	C Bandraster Profil
2	Ana L taşıyıcı
6	C Bandraster Ana L taşıyıcı Askı Parçası
10	Askı tiji
17	Grida L Köşebent

#### Alternative 4

##### Full Panel Finish with Grida L Wall Angle

1	C Bandraster Profile
2	Primary L runner
6	C Bandraster Rigid Hanger
10	Threaded Rod
17	Grida L Wall Angle

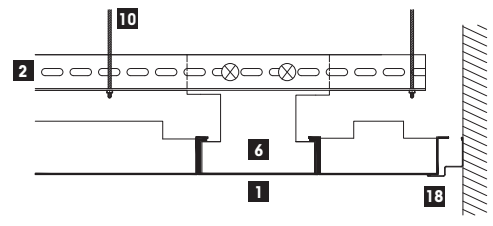

#### Alternatif 5

##### Basamaklı Köşebent ile Tam Plaka Duvar Bitişi

1	C Bandraster Profil
2	Ana L taşıyıcı
6	C Bandraster Ana L taşıyıcı Askı Parçası
10	Askı tiji
18	Basamaklı Köşebent

#### Alternative 5

##### Full Panel Finish with Z Profile

1	C Bandraster Profile
2	Primary L runner
6	C Bandraster Rigid Hanger
10	Threaded Rod
18	Z Wall Angle

CUTOUT YAPILMIŞ PANEL DETAYLARI  
DETAILS OF PANELS WITH CUT-OUT

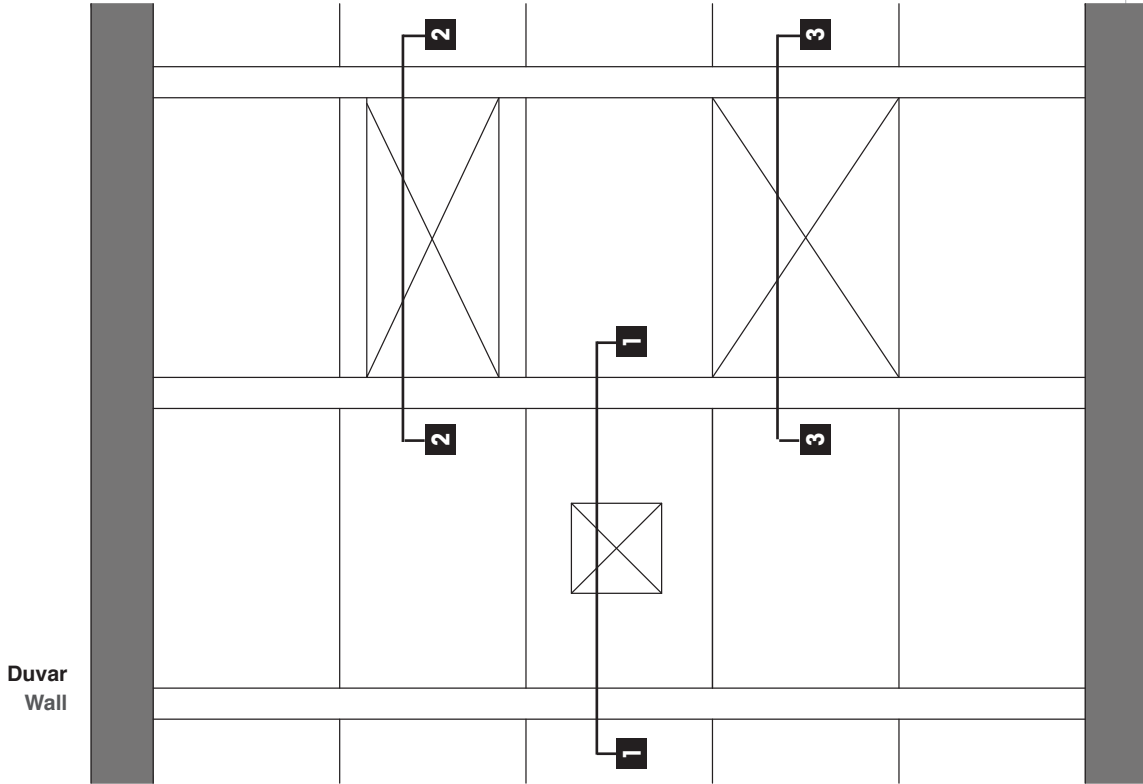

1-1 Kesiti / Section 1-1

2-2 Kesiti / Section 2-2

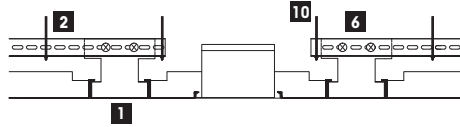
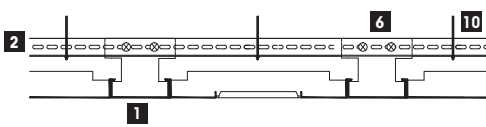

Cut-out Yapılmış Tavan Paneli

- 1** C Bandraster Profil
- 2** Ana L taşıyıcı
- 6** C Bandraster Ana L taşıyıcı Askı Parçası
- 10** Askı tiji

Cut-out Yapılmış Tavan Paneli

- 1** C Bandraster Profil
- 2** Ana L taşıyıcı
- 6** C Bandraster Ana L taşıyıcı Askı Parçası
- 10** Askı tiji

Ceiling Panel with Cut-out

- 1** C Bandraster Profile
- 2** Primary L runner
- 6** C Bandraster Rigid Hanger
- 10** Threaded Rod

Ceiling Panel with Cut-out

- 1** C Bandraster Profile
- 2** Primary L runner
- 6** C Bandraster Rigid Hanger
- 10** Threaded Rod

3-3 Kesiti / Section 3-3

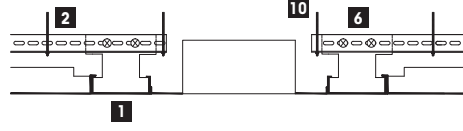

Cut-out Yapılmış Tavan Paneli

- |   |
|---|
| <b>1</b> C Bandraster Profil                      |
| <b>2</b> Ana L taşıyıcı                           |
| <b>6</b> C Bandraster Ana L taşıyıcı Askı Parçası |
| <b>10</b> Askı tiji                               |

Ceiling Panel with Cut-out

- |                                    |
|------------------------------------|
| <b>1</b> C Bandraster Profile      |
| <b>2</b> Primary L runner          |
| <b>6</b> C Bandraster Rigid Hanger |
| <b>10</b> Threaded Rod             |

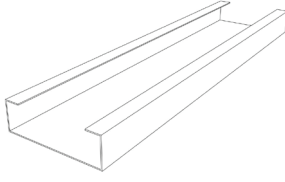

01

<b>CBP-100-L4000</b>	
Ürün Adı	C Bandraster
Özellik / Malzeme	Galvanize Çelik 1 mm 15x30x100x4000x1,0

<b>CBP-100-L4000</b>	
Product Reference	C Bandraster
Specification / Material	Galvanized Steel 1 mm 15x30x100x4000x1,0

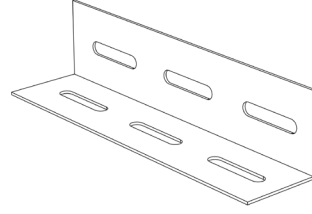

02

<b>AS-20</b>	
Ürün Adı	Ana L Taşıyıcı
Özellik / Malzeme	Galvanize Çelik 1 mm 30x30x4000x1,0

<b>AS-20</b>	
Product Reference	Primary L Runner
Specification / Material	Galvanized Steel 1 mm 30x30x4000x1,0

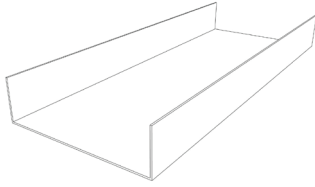

03

<b>CBP-ZL-100</b>	
Ürün Adı	C Bandraster Ekleme Parçası
Özellik / Malzeme	Galvanize Çelik 1 mm 97x120x1,0

<b>CBP-ZL-100</b>	
Product Reference	C Bandraster Profile Splice
Specification / Material	Galvanized Steel 1 mm 97x120x1,0

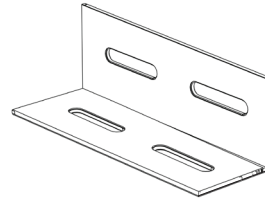

04

<b>AS-25</b>	
Ürün Adı	Ana L Taşıyıcı Ekleme Parçası
Özellik / Malzeme	Galvanize Çelik 1,5 mm 30x30x4000x1,0

<b>AS-25</b>	
Product Reference	Primary L Runner Splice
Specification / Material	Galvanized Steel 1,5 mm 30x30x4000x1,0

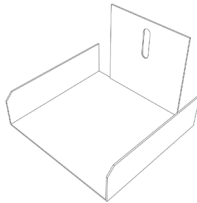

05

<b>CBP-ZW-100</b>	
Ürün Adı	Galvanize Çelik 1 mm
Özellik / Malzeme	70x97x100x1,0

<b>CBP-ZW-100</b>	
Product Reference	Galvanized Steel 1 mm
Specification / Material	70x97x100x1,0

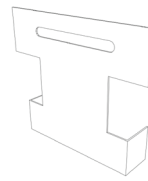

06

<b>CBP-ZA-100</b>	
Ürün Adı	C Bandraster Ana L Taşıyıcı Askı Parçası
Özellik / Malzeme	Galvanize Çelik 1 mm 30x30x150x1,0

<b>CBP-ZA-100</b>	
Product Reference	Rigid Hanger
Specification / Material	Galvanized Steel 1 mm 30x30x150x1,0

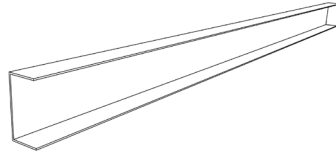

07

CDPR 300	
Ürün Adı	C Köşebent
Özellik / Malzeme	20x40x20x3000x0,5 Galvanize Çelik 0,5 mm
CDPR 300	
Product Reference	C Wall Angle
Specification / Material	20x40x20x3000x0,5 Galvanized Steel 0,5 mm

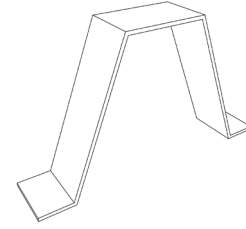

08

KT 40	
Ürün Adı	Kenar Takozu
Özellik / Malzeme	Yay Çeliği 0,45 mm
KT 40	
Product Reference	Wedge Clip
Specification / Material	Spring Steel 0,45 mm

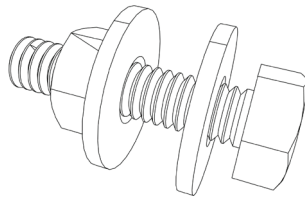

09

VDS-60	
Ürün Adı	Vida/Somun/Rondela
Özellik / Malzeme	Ø6
VDS-60	
Product Reference	Bolt/Nut/Washer
Specification / Material	Ø6

10

ATJ-100	
Ürün Adı	Askı Tiji
Özellik / Malzeme	Ø6-1000
ATJ-100	
Product Reference	Threaded Rod
Specification / Material	Ø6-1000



11

TD-06	
Ürün Adı	Tij Dübeli
Özellik / Malzeme	
TD-06	
Product Reference	Rod Anchor
Specification / Material	

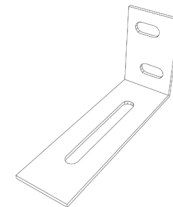

12

AS-30	
Ürün Adı	Duvar Bağlantı Pabucu
Özellik / Malzeme	Galvanize Çelik 1,5 mm 30x50x100x1,5
AS-30	
Ordering Reference	Wall Anchor
Specification / Material	Galvanized Steel 1,5 mm 30x50x100x1,5

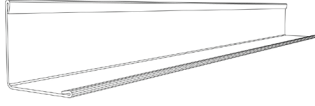

13

<b>WL-3000</b>	
Ürün Adı	L Köşebent
Özellik / Malzeme	Galvanize Çelik 0,6 mm

<b>WL-3000</b>	
Product Reference	L Wall Angle
Specification / Material	Galvanized Steel 0,6 mm



14

<b>WKT-1</b>	
Ürün Adı	Kenar Takozu
Özellik / Malzeme	

<b>WKT-1</b>	
Product Reference	Wedge Clip
Specification / Material	

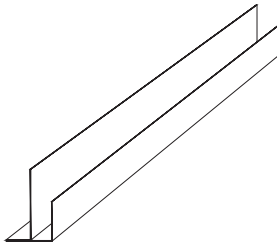

15

<b>FDPR-3000</b>	
Ürün Adı	F Profil
Özellik / Malzeme	Alüminyum 1 mm

<b>FDPR-3000</b>	
Product Reference	F Profile
Specification / Material	Aluminium 1 mm

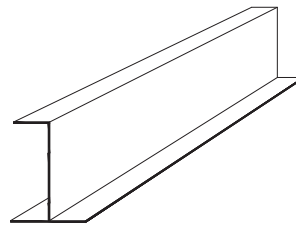

16

<b>HDPR-40</b>	
Ürün Adı	H Profil
Özellik / Malzeme	30x40x3000x1mm Alüminyum 1 mm

<b>HDPR-40</b>	
Product Reference	H Profile
Specification / Material	30x40x3000x1mm Aluminium 1 mm

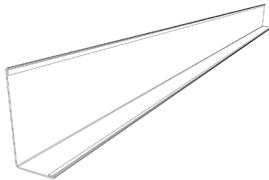

17

<b>AS-GR1919-B04</b>	
Ürün Adı	Grıda L Profil
Özellik / Malzeme	19x19x3050x0,5mm Galvanize Çelik 0,5 mm

<b>AS-GR1919-B04</b>	
Product Reference	Grıda L Wall Angle
Specification / Material	19x19x3050x0,5mm Galvanized Steel 0,5 mm

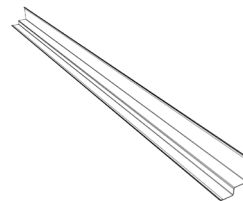

18

<b>AS-GR1508-B05</b>	
Ürün Adı	Basamaklı Köşebent
Özellik / Malzeme	25x8x15x15x3050x0,5mm Galvanize Çelik 0,5 mm

<b>AS-GR1508-B05</b>	
Product Reference	Z Wall Angle
Specification / Material	25x8x15x15x3050x0,5mm Galvanized Steel 0,5 mm



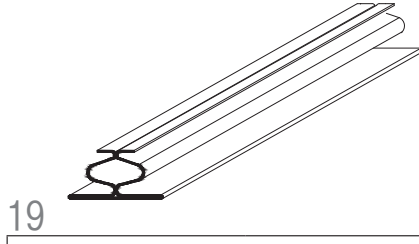

Ürün Adı	Diversa yarım dikme profili
Özellik / Malzeme	49x20.6x5100x0,8 mm Galvanize Çelik 0,8 mm
Product Reference	Diversa half upright
Specification / Material	49x20.6x5100x0,8 mm Galvanized Steel 0,8 mm



# INTEGRA PLANK INTEGRA PLANK

## Perspekta Plank Sistem Perspekta Plank System

Perspekta C Bandraster Nonius  
Perspekta C Bandraster Nonius

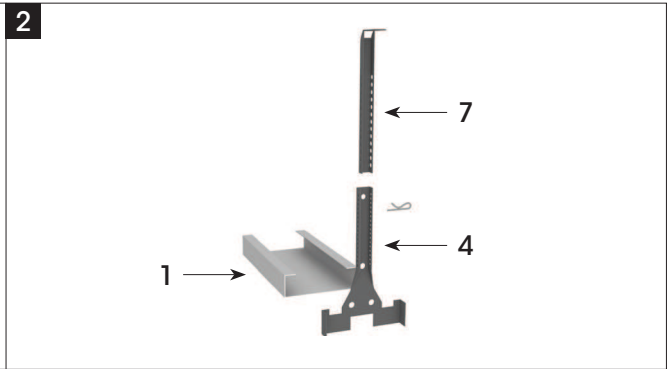
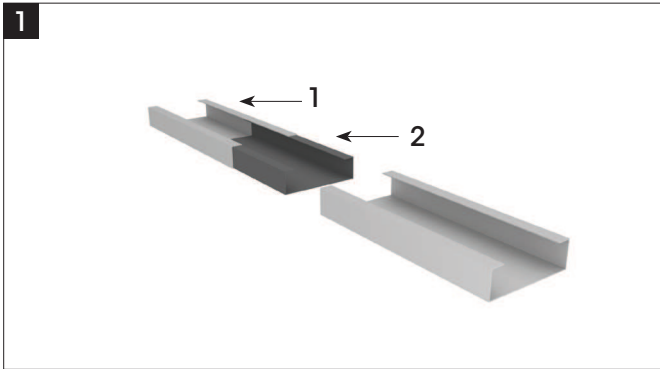
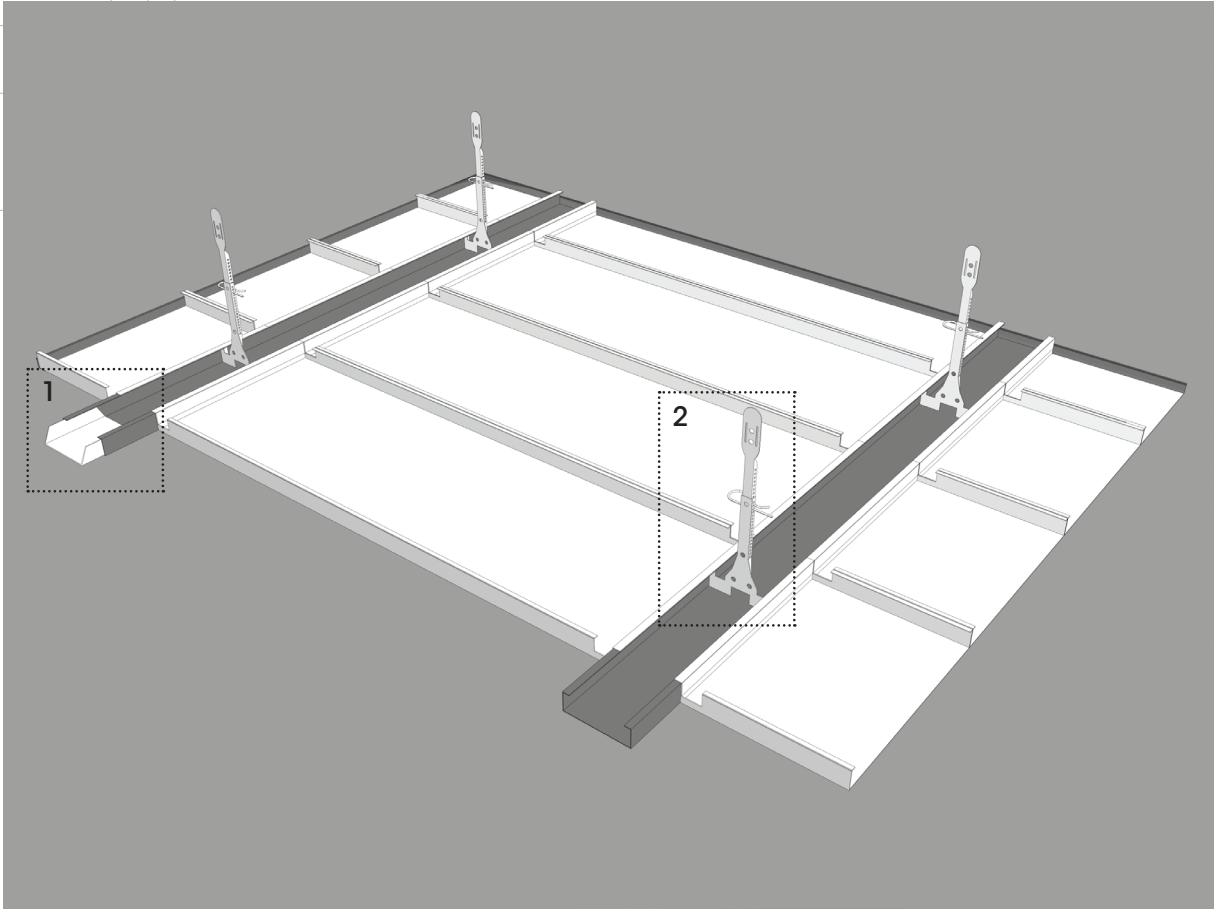

## Perspekta C Bandraster

Integra Plank Perspekta C Bandraster Sistemleri farklı genişlikte bandraster seçenekleriyle asma tavan yüzeyinde kesintisiz bir görünüm oluşturarak, mimarlara çağdaş uygulama seçenekleri sunar. Her türlü mimari tasarıma uygun çeşitli malzeme seçenekleriyle üretilmesi mümkündür. Tüm Perspekta panelleri sökme aparatı gerektirmeden kolaylıkla demonte edilebilir.

Standart Panel / Standard Panel

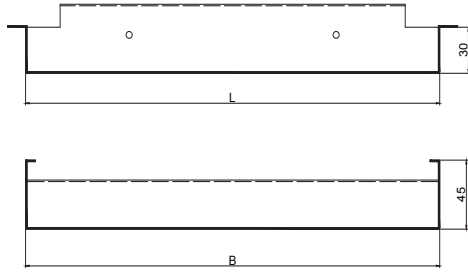

### Panel Tanımı

**Hammadde:** Galvanize çelik, Paslanmaz çelik, Alüminyum.

**Kenar özelliği:** Küt

**En:** 200-1200 mm

**Boy:** 200-3000 mm

**Boya:** RAL 9006, RAL 9010, RAL 9016

- . İsteğe bağlı olarak tüm RAL renklerinde üretim yapılabilir.
- . Özellikle hijyen gerektiren alanlar için anti bakteriyel boya seçeneği mevcuttur.
- . İstenildiğinde ahşap görünlü paneller üretilebilir.
- . Daha fazla bilgi için bkz. **Renk ve Desen**

**Perforasyon:** Ø0.7, Ø1.5, Ø1.8, Ø2.5, Ø3, Ø4.5, Ø6, Ø7, Ø16, 8x8, Random  
Daha fazla bilgi için bkz. **Perforasyon**

**Akustik:** NRC 0,70(Ø2.5mm %16 boşluk oranı)  
Daha fazla bilgi için bkz. **Akustik**

**Yangın:** Yangın tepki sınıfı A2-s1,d0.  
Daha fazla bilgi için bkz. **Standartlar**

### Teknik Standartlar:

- . Taşıyıcı sistem ile desteklenen paneller, ISO9001:2008, TSE ve CE belgeli tesisimizde Avrupa, Amerika ve TAIM (Technical Association of Industrial Metal Ceiling Manufacturers) standartlarına uygun olarak imal edilmektedir.
- . Malzemenin yangın tepki sınıfı, uluslar arası akredite edilmiş test kuruluşlarında yaptırılmış yangın testi ile EN 13501-1 standardı uyarınca yapılan sınıflandırma sonucu A2-s1,d0 olarak belgelenmiştir.

## Perspekta C Bandraster

Integra Plank, Perspekta C Bandraster Systems provide architects with modern application alternatives in places where aesthetics is in the foreground by forming a ceaseless appearance on the surface of the ceiling with C Bandrasters which can be in different widths and details. The panels can be produced for all kinds of architectural design, in different material options. All Perspekta panels can be easily unassembled without any tools.

Standart Birleşim / Standard Connection

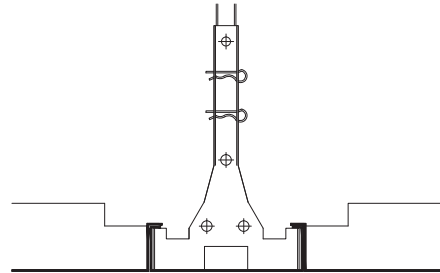

### Panel Description

**Raw material:** Galvanized Steel, Stainless Steel, Aluminium.

**Edge Option:** Square

**Width:** 200-1200 mm

**Length:** 200-3000 mm

**Colour:** RAL9006, RAL9010, RAL9016

- . Production is possible in all other RAL colours upon request.
- . Antibacterial paint option is available upon request, especially for areas with hygiene requirements.
- . Panels with wood appearance can be produced if requested.
- . For detailed information please see **Colours and Design**.

**Perforation:** Ø0.7, Ø1.5, Ø1.8, Ø2.5, Ø3, Ø4.5, Ø6, Ø7, Ø16, 8x8, Random  
For detailed information please see **Perforation**.

**Acoustics:** NRC: 0,70(Ø2.5mm %16 open area)  
For detailed information please see **Acoustics**.

**Fire:** Reaction to Fire Class A2-s1,d0.  
For detailed information please see **Standards**.

### Technical Standards:

- . Ceiling panels supported by a suspension system manufactured in accordance with European, American and TAIM (Technical Association of Industrial Metal Ceiling Manufacturers) standards in our factory that have ISO9001:2008, TSE ve CE certificates.
- . Panels are tested in accordance with EN 13501-1 and must be designed to comply with Euroclass A2-s1, d0

## METAL CEILING SPECIFICATION

... x ... mm Sized Perspekta C Bandraster Nonius System

### General Description:

Galvanised Steel/Aluminium ceiling panels supported by fully concealed suspension system system manufactured in accordance with European, American and TAIM (Technical Association of Industrial Metal Ceiling Manufacturers) standards by a manufacturer that have ISO9001:2008, TSE ve CE certificates.

Ceilings are tested in accordance with EN 13501-1 and must be designed to comply with at least Euroclass A2-s1, d0

### Panel Description:

<b>Raw material</b>	Ceiling panels manufactured from ... mm Galvanised Steel/Stainless Steel/Aluminium.
<b>Colour</b>	Ceiling panels coated electrostatically applied powder coating coloured RAL ... ( min. 40 $\mu$ thickness and approx. %20 Gloss Rate)
<b>Acoustical inlay</b>	Ceiling panels are manufactured with 0,2 mm thickness, black acoustical inlay (Royalin/Soundtex) to achieve sound absorption $\alpha_w = \dots$ for $\varnothing \dots$ mm Perforation (%.. open area)
<b>Perforation Edge</b>	Ceiling panels are perforated $\varnothing \dots$ mm (% ... open area) and plain borders are ... mm. Square.

### Installation:

C-Wall Angle(5) should be used for lateral sides facing inwards of the gypsum pool. C Bandraster wall anchor (3) should be used if there is no C wall angle. The first hanger system should not exceed 450 mm distance from the wall and the distance between hangers could be max 1000mm. C Bandraster Nonius Rigid Hanger (Lower Part) (4), Nonius Rigid Hanger (upper part) (7) , and steel anchor (8) will be used to suspend the C Bandraster Profile(1) securely. The distance between Wall-angle and the main runner should be max. 600 mm. The distance between the main runners should not exceed 1200mm. The cross runners should be positioned on 600 mm away from each. In order to add one C Bandraster profile C Bandraster profile splice(2) should be used. Lighting, sprinkler or vent places should be cutted out and the components should be mounted according to the project after the installation. In the case of these components come up to suspension system accessories, installation should be continued with mounting suspension system accesories one before and one after the components.

### Suspension System:

<b>1-CBP-100-L400-9010</b>	C Bandraster Profile, 100 mm width, 4000 mm length, 1 mm thickness, galvanised steel
<b>2-CBP-ZL-100</b>	C Bandraster Profile Splice
<b>3-CBP-ZW-100</b>	C Bandraster Wall Anchor, 1 mm thickness, galvanised steel. ( if there is no C-Wall Angle).
<b>4-CBP-100NA-50</b>	C Bandraster Nonius Rigid Hanger (Lower Part)
<b>5-CDPR 300</b>	C-Wall Angle, 20x40x20 mm sized, 3000 mm length, 0,5 mm thickness, pre-painted galvanised steel
<b>6-KT 40</b>	Wedge Clip, 0,5 mm thickness, galvanised steel
<b>7-NU-30</b>	Nonius Rigid Hanger (upper part)
<b>8-TP-02</b>	Steel anchor that coated by zinc against corrosion



PANEL BAĞLANTI DETAYLARI  
PANEL CONNECTION DETAILS

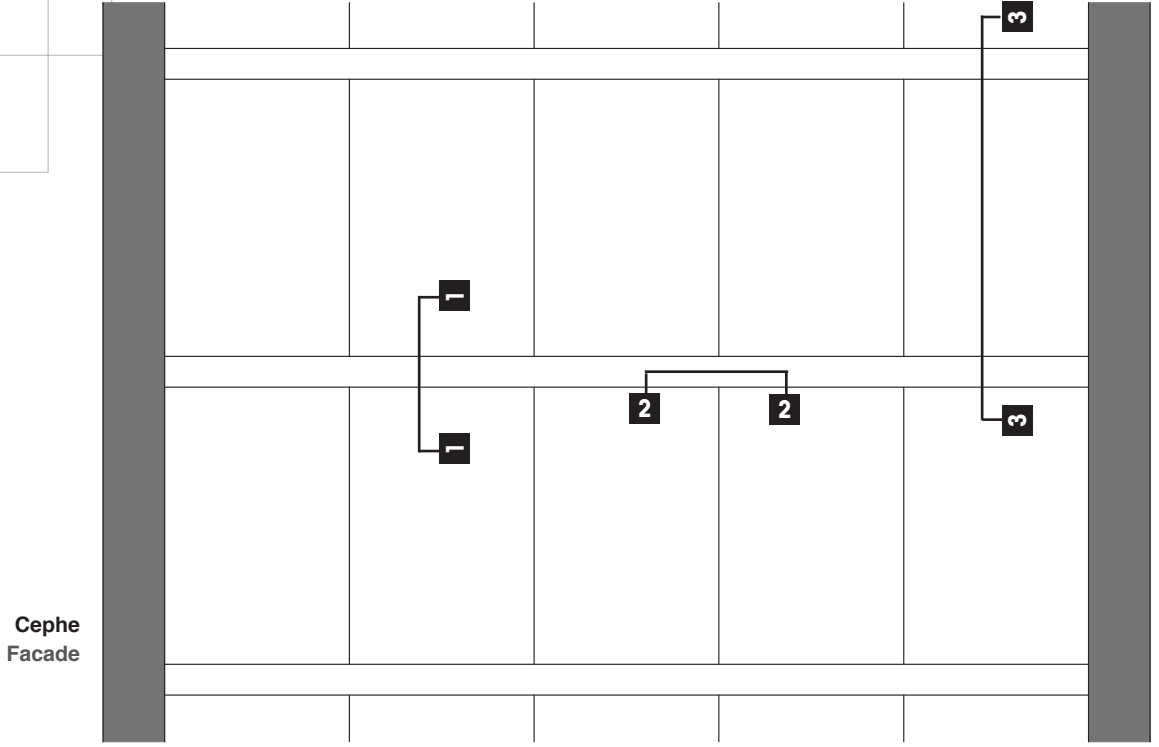

1-1 Kesiti / Section 1-1

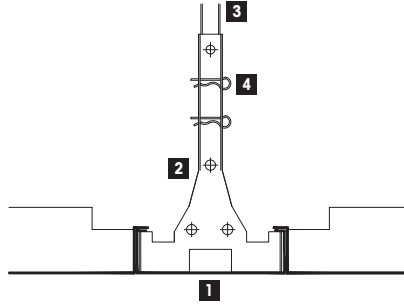

Panel - Bandraster Birleşimi	
1	C Bandraster Profil
2	C Bandraster Nonius Alt Parçası
3	Nonius Üst Parça
4	Nonius Askı Pimi

Panel - Bandraster Connection	
1	C Bandraster Profile
2	C Bandraster Nonius Hanger
3	Nonius Upper Part
4	Nonius Pin

2-2 Kesiti / Section 2-2

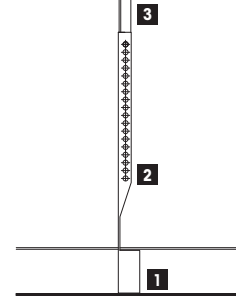

Bandraster - Askı Birleşimi	
1	C Bandraster Profil
2	C Bandraster Nonius Alt Parçası
3	Nonius Üst Parça

Bandraster - Hanger Connection	
1	C Bandraster Profile
2	C Bandraster Nonius Hanger
3	Nonius Upper Part



3-3 Kesiti / Section 3-3

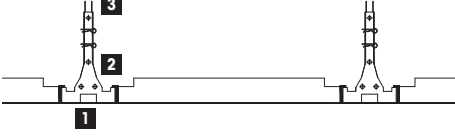

Panel Birleşimi

1 C Bandraster Profil

2 C Bandraster Nonius Alt Parçası

3 Nonius Üst parça

Connection of Panels

1 C Bandraster Profile

2 C Bandraster Nonius Hanger

3 Nonius Upper Part

METAL VE DİĞER TAVANLARIN BİRLEŞİM DETAYLARI  
METAL AND OTHER CEILING CONNECTION DETAILS

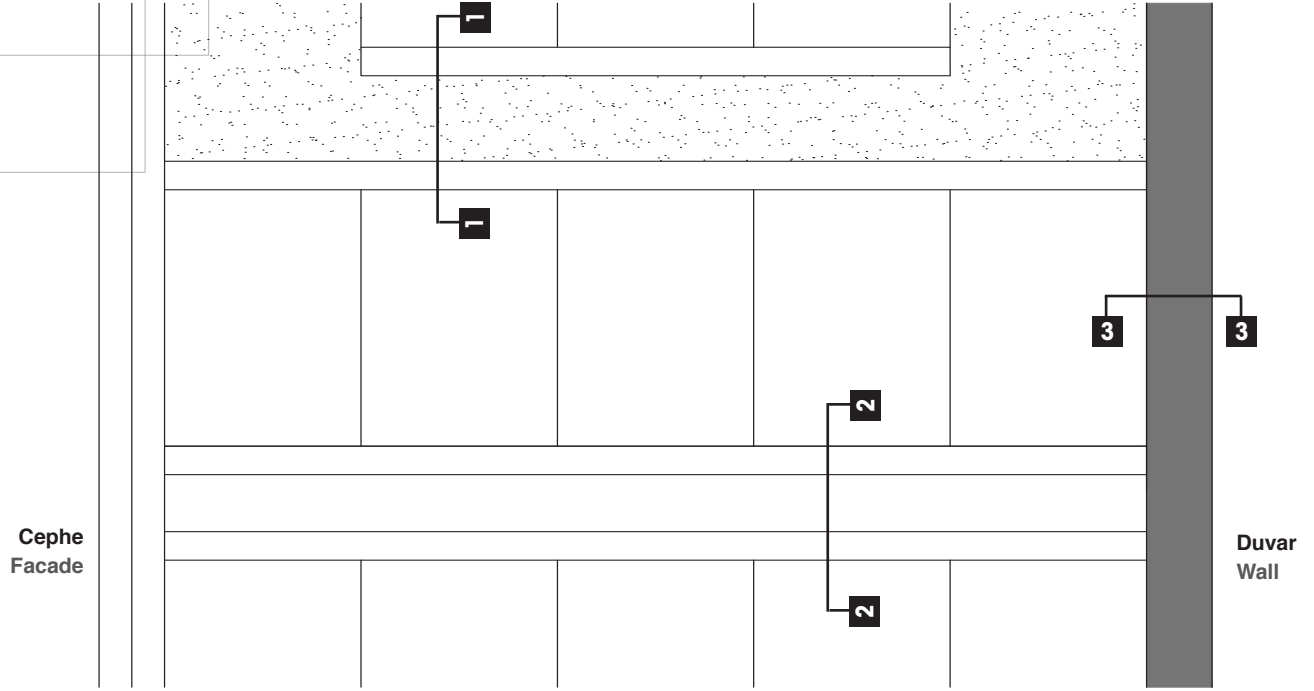

1-1 Kesiti / Section 1-1

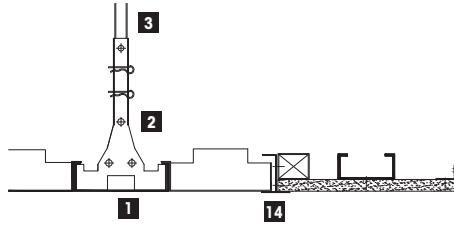

H Profil ile Alçıpan - Metal Tavan Birleşimi
1 C Bandraster Profil
2 C Bandraster Nonius Alt Parçası
3 Nonius Üst parça
14 H profil

Joint to a Gypsum Board with H Profile
1 C Bandraster Profile
2 C Bandraster Nonius Hanger
3 Nonius Upper Part
14 H Profile

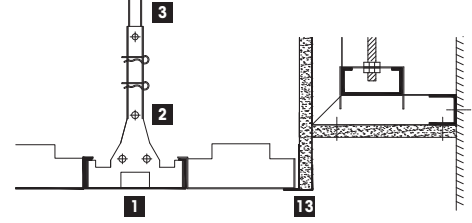

F Profil ile Alçıpan - Metal Tavan Birleşimi
1 C Bandraster Profil
2 C Bandraster Nonius Alt Parçası
3 Nonius Üst parça
13 F Profil

Joint to a Gypsum Board with F Profile
1 C Bandraster Profile
2 C Bandraster Nonius Hanger
3 Nonius Upper Part
13 F Profile

2-2 Kesiti / Section 2-2



Kapama Paneli - Metal Tavan Birleşimi
1 C Bandraster Profil
2 C Bandraster Nonius Alt Parçası
3 Nonius Üst Parça

Joint to Metal Ceiling with Covering Panel
1 C Bandraster Profile
2 C Bandraster Nonius Hanger
3 Nonius Upper Part

3-3 Kesiti / Section 3-3

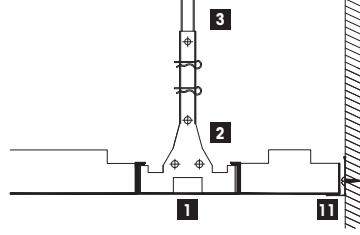

Alternatif 1 Duvar-Tavan Bağlantıları

L Köşebent ile Tam Plaka Duvar Bitişi
1 C Bandraster Profil
2 C Bandraster Nonius Alt Parçası
3 Nonius Üst parça
11 L Köşebent

Alternative 1 Ceiling-Wall Connections

Full Panel Finish with L Wall Angle
1 C Bandraster Profile
2 C Bandraster Nonius Hanger
3 Nonius Upper Part
11 L Wall Angle

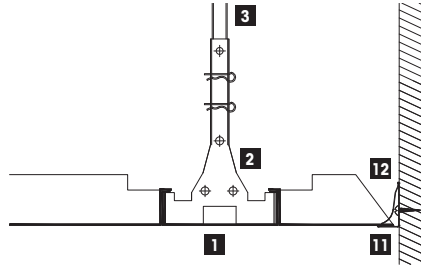

Alternatif 2

L Köşebent ile Kesik Plaka Duvar Bitişi
1 C Bandraster Profil
2 C Bandraster Nonius Alt Parçası
3 Nonius Üst parça
11 L Köşebent
12 Kenar Takozu

Alternative 2

Cutted Panel Finish with L Wall Angle
1 C Bandraster Profile
2 C Bandraster Nonius Hanger
3 Nonius Upper Part
11 L Wall Angle
12 Kenar Takozu

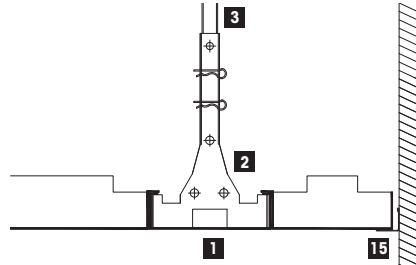

Alternatif 3

Grida L Köşebent ile Tam Plaka Duvar Bitişi
1 C Bandraster Profil
2 C Bandraster Nonius Alt Parçası
3 Nonius Üst Parça
15 Grida L Köşebent

Alternative 3

Full Panel Finish with Grida L Wall Angle
1 C Bandraster Profile
2 C Bandraster Nonius Hanger
3 Nonius Upper Part
15 Grida L Wall Angle

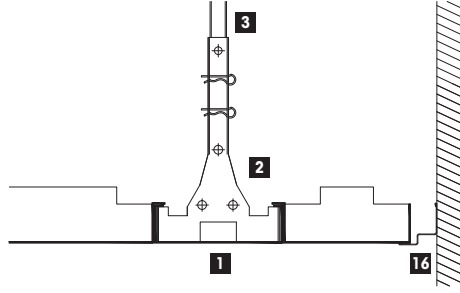

#### Alternatif 4

##### Grıda L Köşebent ile Tam Plaka Duvar Bitişi

- |    |                                 |
|----|---------------------------------|
| 1  | C Bandraster Profil             |
| 2  | C Bandraster Nonius Alt Parçası |
| 3  | Nonius Üst Parça                |
| 16 | Basamaklı Köşebent              |

#### Alternative 4

##### Full Panel Finish with Grıda L Wall Angle

- |    |                            |
|----|----------------------------|
| 1  | C Bandraster Profile       |
| 2  | C Bandraster Nonius Hanger |
| 3  | Nonius Upper Part          |
| 16 | Z Wall Angle               |

CUTOUT YAPILMIŞ PANEL DETAYLARI  
DETAILS OF PANELS WITH CUT-OUT

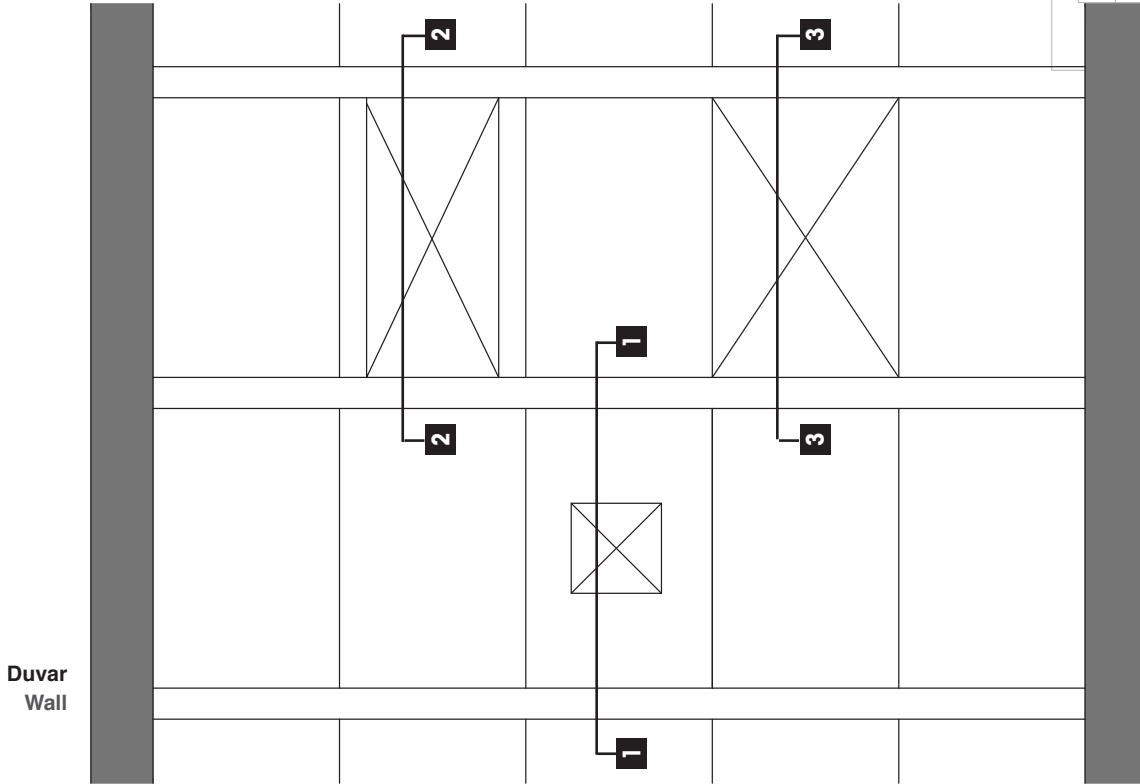

1-1 Kesiti / Section 1-1

2-2 Kesiti / Section 2-2

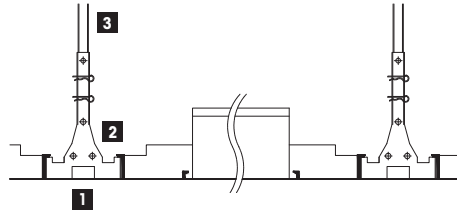
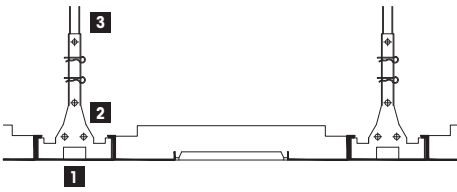

Cut-out Yapılmış Tavan Paneli

- 1 C Bandraster Profil
- 2 C Bandraster Nonius Alt Parçası
- 3 Nonius Üst Parça

Cut-out Yapılmış Tavan Paneli

- 1 C Bandraster Profil
- 2 C Bandraster Nonius Alt Parçası
- 3 Nonius Üst Parça

Ceiling Panel with Cut-out

- 1 C Bandraster Profile
- 2 C Bandraster Nonius Hanger
- 3 Nonius Upper Part

Ceiling Panel with Cut-out

- 1 C Bandraster Profile
- 2 C Bandraster Nonius Hanger
- 3 Nonius Upper Part

3-3 Kesiti / Section 3-3

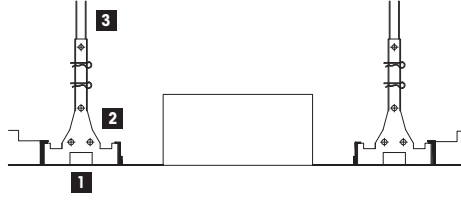

Cut-out Yapılmış Tavan Paneli

- |   |                                 |
|---|---------------------------------|
| 1 | C Bandraster Profil             |
| 2 | C Bandraster Nonius Alt Parçası |
| 3 | Nonius Üst Parça                |

Ceiling Panel with Cut-out

- |   |                            |
|---|----------------------------|
| 1 | C Bandraster Profile       |
| 2 | C Bandraster Nonius Hanger |
| 3 | Nonius Upper Part          |



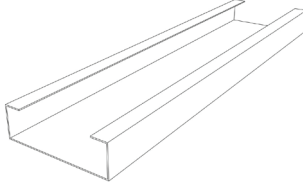

01

<b>CBP-100-L4000</b>	
Ürün Adı	C Bandraster Galvanize Çelik 1 mm
Özellik / Malzeme	15x30x100x4000x1,0

<b>CBP-100-L4000</b>	
Product Reference	C Bandraster Galvanized Steel 1 mm
Specification / Material	15x30x100x4000x1,0

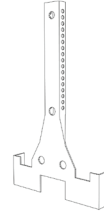

02

<b>CBP-100-NA</b>	
Ürün Adı	C Bandraster Nonius Alt Parçası
Özellik / Malzeme	Galvanize Çelik 1 mm 30x30x150x1,0

<b>CBP-100-NA</b>	
Product Reference	C Bandraster Nonius Rigid Hanger
Specification / Material	Galvanized Steel 1 mm 30x30x150x1,0



03

<b>NU-100</b>	
Ürün Adı	Nonius Üst Parça
Özellik / Malzeme	Galvanize Çelik 0,9 mm

<b>NU-100</b>	
Product Reference	Nonius Üst Parça
Specification / Material	Galvanized Steel 0,9 mm

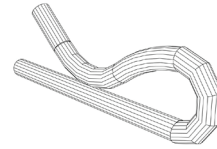

04

<b>1 14</b>	
Ürün Adı	Nonius Askı Pimi
Özellik / Malzeme	Galvanize Çelik 0,9 mm

<b>1 14</b>	
Product Reference	Nonius Pin
Specification / Material	Galvanized Steel 0,9 mm

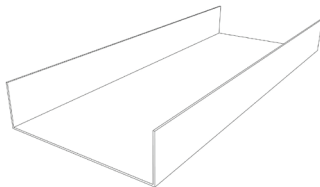

05

<b>CBP-ZL-100</b>	
Ürün Adı	C Bandraster Ekleme Parçası
Özellik / Malzeme	Galvanize Çelik 1 mm 97x120x1,0

<b>CBP-ZL-100</b>	
Product Reference	C Bandraster Profile Splice
Specification / Material	Galvanized Steel 1 mm 97x120x1,0

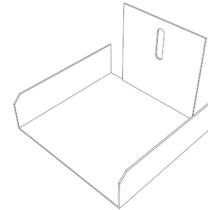

06

<b>CBP-ZW-100</b>	
Ürün Adı	C Bandraster duvar bağlantı parçası
Özellik / Malzeme	Galvanize Çelik 1 mm 70x97x100x1,0

<b>CBP-ZW-100</b>	
Product Reference	C Bandraster wall anchor
Specification / Material	Galvanized Steel 1 mm 70x97x100x1,0

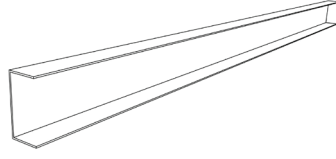

07

<b>CDPR 300</b>	
Ürün Adı	C Köşebent
Özellik / Malzeme	20x40x20x3000x0,5 Galvanize Çelik 0,5 mm
<b>CDPR 300</b>	
Product Reference	C Wall Angle
Specification / Material	20x40x20x3000x0,5 Galvanized Steel 0,5 mm

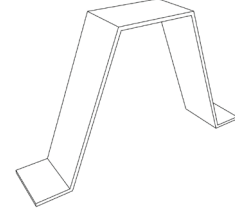

08

<b>KT 40</b>	
Ürün Adı	Kenar Takozu
Özellik / Malzeme	Yay Çeliği 0,45 mm
<b>KT 40</b>	
Product Reference	Wedge Clip
Specification / Material	Spring Steel 0,45 mm

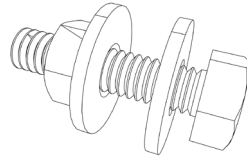

09

<b>VDS-60</b>	
Ürün Adı	Vida/Somun/Rondela
Özellik / Malzeme	Ø6
<b>VDS-60</b>	
Product Reference	Bolt/Nut/Washer
Specification / Material	Ø6

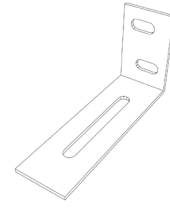

10

<b>AS-30</b>	
Ürün Adı	Duvar Bağlantı Pabucu
Özellik / Malzeme	Galvanize Çelik 1,5 mm 30x50x100x1,5
<b>AS-30</b>	
Product Reference	Wall Anchor
Specification / Material	Galvanized Steel 1,5 mm 30x50x100x1,5

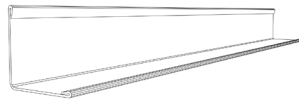

11

<b>WL-3000</b>	
Ürün Adı	L Köşebent
Özellik / Malzeme	Galvanize Çelik 0,6 mm
<b>WL-3000</b>	
Product Reference	L Wall Angle
Specification / Material	Galvanized Steel 0,6 mm



12

<b>WKT-1</b>	
Ürün Adı	Kenar Takozu
Özellik / Malzeme	
<b>WKT-1</b>	
Ordering Reference	Wedge Clip
Specification / Material	

13

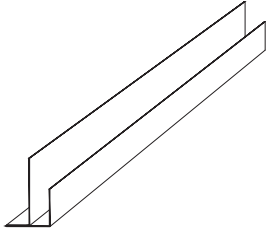

<b>FDPR-3000</b>	
Ürün Adı	F Profil
Özellik / Malzeme	Alüminyum 1 mm

<b>FDPR-3000</b>	
Product Reference	F Profile
Specification / Material	Aluminium 1 mm

14

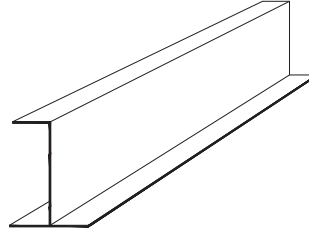

<b>HDPR-40</b>	
Ürün Adı	H Profil 30x40x3000x1mm
Özellik / Malzeme	Alüminyum 1 mm

<b>HDPR-40</b>	
Product Reference	H Profile 30x40x3000x1mm
Specification / Material	Aluminium 1 mm

15

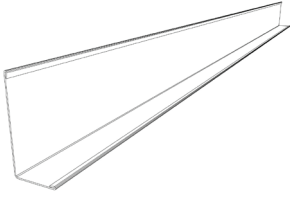

<b>AS-GR1919-B04</b>	
Ürün Adı	Grıda L Profil 19x19x3050x0,5mm
Özellik / Malzeme	Galvanize Çelik 0,5 mm

<b>AS-GR1919-B04</b>	
Product Reference	Grıda L Wall Angle 19x19x3050x0,5mm
Specification / Material	Galvanized Steel 0,5 mm

16

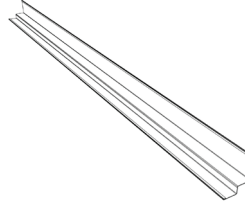

<b>AS-GR1508-B05</b>	
Ürün Adı	Basamaklı Köşebent 25x8x15x15x3050x0,5mm
Özellik / Malzeme	Galvanize Çelik 0,5 mm

<b>AS-GR1508-B05</b>	
Product Reference	Z Wall Angle 25x8x15x15x3050x0,5mm
Specification / Material	Galvanized Steel 0,5 mm

17

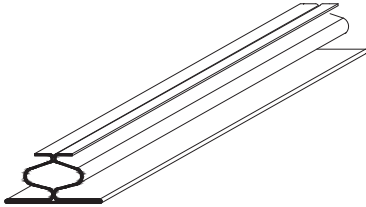

<b>Diversa yarım dikme profili</b>	
Ürün Adı	Diversa yarım dikme profili 49x20.6x5100x0,8 mm
Özellik / Malzeme	Galvanize Çelik 0,8 mm

<b>Diversa yarım dikme profili</b>	
Product Reference	Diversa half upright 49x20.6x5100x0,8 mm
Specification / Material	Galvanized Steel 0,8 mm



# INTEGRA PLANK INTEGRA PLANK

## Perspekta Plank Sistem Perspekta Plank System

Perspekta C Bandraster  
Hinge-down  
Perspekta C Bandraster  
Hinge-down

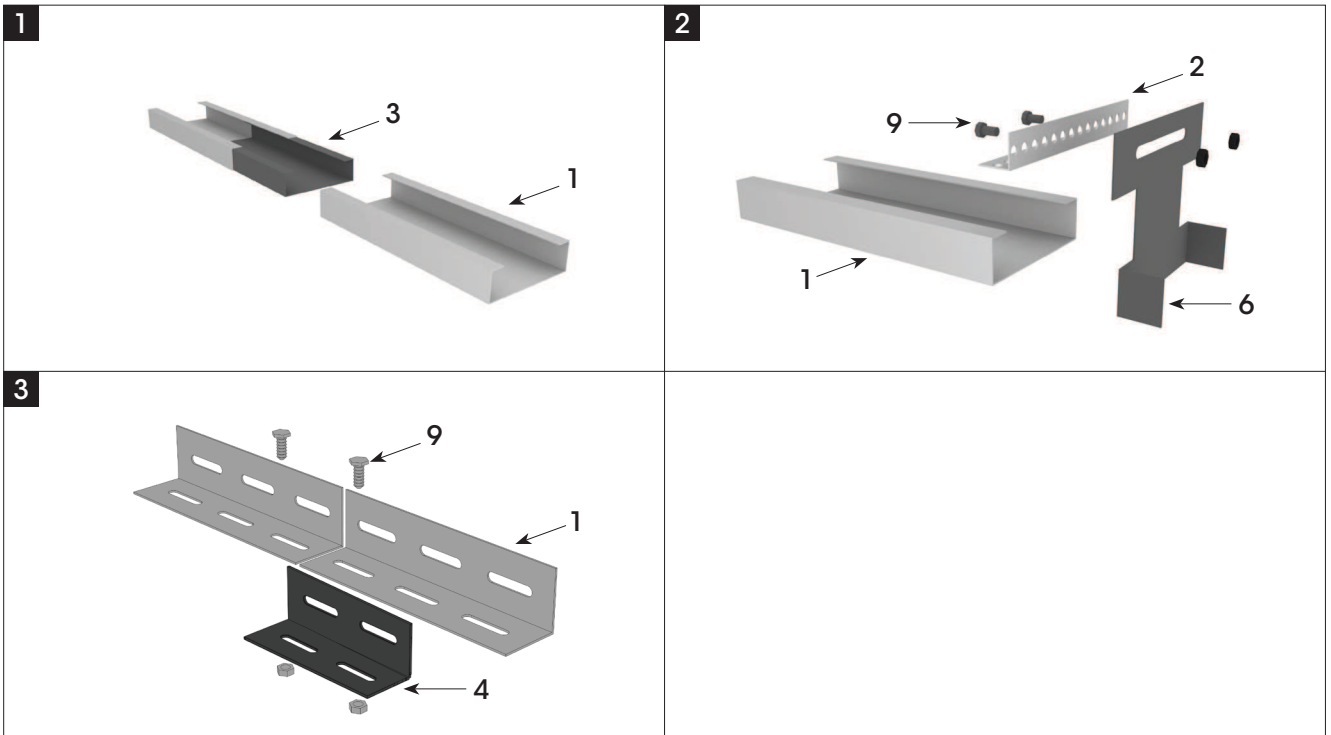
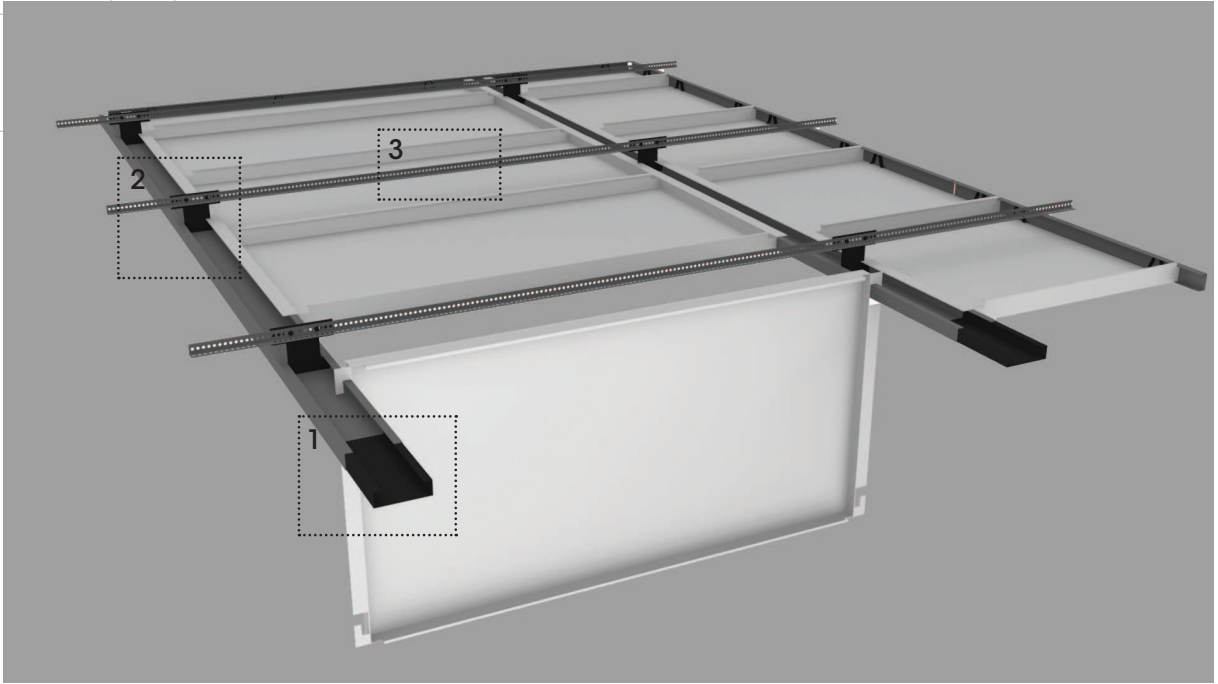

**Perspekta C Bandraster Hinge down**

Integra Plank Perspekta C Bandraster Hinge down Sistemi sistemden ayrılmadan aşağı doğru sarkıtılarak demonte edilebilir ve böylece tavan üstü tesisata kolay ve sık ulaşım gerektiren alanlarda kullanım rahatlığı sunar.

Tüm Perspekta panelleri sökme aparatı gerektirmeden kolaylıkla demonte edilebilir.

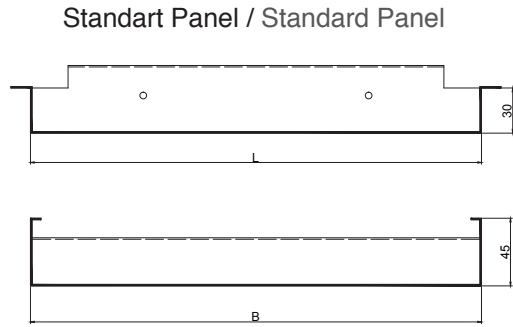
**Panel Tanımı**

**Hammadde:** Galvanize çelik, Paslanmaz çelik, Alüminyum.

**Kenar özelliği:** Küt

**En:** 200-1200 mm

**Boy:** 200-3000 mm

**Boya:** RAL 9006, RAL 9010, RAL 9016

- . İsteğe bağlı olarak tüm RAL renklerinde üretim yapılabilir.
- . Özellikle hijyen gerektiren alanlar için anti bakteriyel boya seçeneği mevcuttur.
- . İstenildiğinde ahşap görünümlü paneller üretilebilir.
- . Daha fazla bilgi için bkz. **Renk ve Desen**

**Perforasyon:** Ø0.7, Ø1.5, Ø1.8, Ø2.5, Ø3, Ø4.5, Ø6, Ø7, Ø16, 8x8, Random  
Daha fazla bilgi için bkz. **Perforasyon**

**Akustik:** NRC 0,70(Ø2.5mm %16 boşluk oranı)  
Daha fazla bilgi için bkz. **Akustik**

**Yangın:** Yangın tepki sınıfı A2-s1,d0.  
Daha fazla bilgi için bkz. **Standartlar**

**Teknik Standartlar:**

- . Taşıyıcı sistem ile desteklenen paneller, ISO9001:2008, TSE ve CE belgeli tesisimizde Avrupa, Amerika ve TAIM (Technical Association of Industrial Metal Ceiling Manufacturers) standartlarına uygun olarak imal edilmektedir.
- . Malzemenin yangın tepki sınıfı, uluslar arası akredite edilmiş test kuruluşlarında yaptırılmış yangın testi ile EN 13501-1 standardı uyarınca yapılan sınıflandırma sonucu A2-s1,d0 olarak belgelenmiştir.

**Perspekta C Bandraster Hinge down**

Perspekta C Bandraster Hinge down can be swung down from the ceiling and allowed to hang from the profile edge hinges. In areas where frequent and quick access to installations within the ceiling void requirement, this feature offers greater ease of usage.

All Perspekta panels can be easily demounted without any tools.

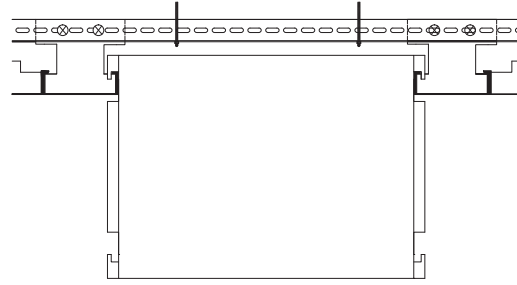
**Standart Birleşim / Standard Connection****Panel Description**

**Raw material:** Galvanized Steel, Stainless Steel, Aluminium.

**Edge Option:** Square

**Width:** 200-1200 mm

**Length:** 200-3000 mm

**Colour:** RAL9006, RAL9010, RAL9016

- . Production is possible in all other RAL colours upon request.
- . Antibacterial paint option is available upon request, especially for areas with hygiene requirements.
- . Panels with wood appearance can be produced if requested.
- . For detailed information please see **Colours and Design**.

**Perforation:** Ø0.7, Ø1.5, Ø1.8, Ø2.5, Ø3, Ø4.5, Ø6, Ø7, Ø16, 8x8, Random  
For detailed information please see **Perforation**.

**Acoustics:** NRC: 0,70(Ø2.5mm %16 open area)  
For detailed information please see **Acoustics**.

**Fire:** Reaction to Fire Class A2-s1,d0.  
For detailed information please see **Standards**.

**Technical Standards:**

- . Ceiling panels supported by a suspension system manufactured in accordance with European, American and TAIM (Technical Association of Industrial Metal Ceiling Manufacturers) standards in our factory that have ISO9001:2008, TSE ve CE certificates.
- . Panels are tested in accordance with EN 13501-1 and must be designed to comply with Euroclass A2-s1, d0



## METAL CEILING SPECIFICATION

... x ... mm Sized Perspekta C Bandraster Hinge down System

### General Description:

Galvanised Steel/Aluminium ceiling panels supported by a suspension system manufactured in accordance with European, American and TAIM (Technical Association of Industrial Metal Ceiling Manufacturers) standards by a manufacturer that have ISO9001:2008, TSE ve CE certificates.

Ceilings are tested in accordance with EN 13501-1 and must be designed to comply with at least Euroclass A2-s1, d0

### Panel Description:

<b>Raw material</b>	Ceiling panels manufactured from ... mm Galvanised Steel/Stainless Steel/Aluminium.
<b>Colour</b>	Ceiling panels coated electrostatically applied powder coating coloured RAL ... ( min. 40 $\mu$ thickness and approx. %20 Gloss Rate)
<b>Acoustical inlay</b>	Ceiling panels are manufactured with 0,2 mm thickness, black acoustical inlay (Royalin/Soundtex) to achieve sound absorption $\alpha_w = \dots$ for $\varnothing \dots$ mm Perforation (%.. open area)
<b>Perforation</b>	Ceiling panels are perforated $\varnothing \dots$ mm (% ... open area) and plain borders are ... mm.
<b>Edge</b>	Square

### Installation:

C-Wall Angle(4) should be used for lateral sides facing inwards of the gypsum pool. C Bandraster wall anchor should be used if there is no C wall angle. The first hanger system should not exceed 450 mm distance from the wall and the distance between hangers could be max 1000mm. Threaded Rod(10), Bolt/Nut (9) and threaded rod anchor(11) will be used to suspend the C Bandraster Profile(1) securely. The distance between Wall-angle and the main runner should be max. 600 mm. The distance between the main runners should not exceed 1200mm. The cross runners should be positioned on 600 mm away from each. C Bandraster and Primary L runners are connected by C Bandraster Rigid Hanger(6). In order to add one C Bandraster profile or Primary L runner to another lienarly; C Bandraster profile splice(3) or Primary L runner Splice(4) should be used. Lighting, sprinkler or vent places should be cutted out and the components should be installed according to the project after the installation. In the case of these components come up to suspension system accessories, installation should be continued with mounting suspension system accesories one before and one after the components.

### Suspension System:

<b>1-CBP-100-L400-9010</b>	C Bandraster Profile, 100 mm width, 4000 mm length, 1 mm thickness, galvanised steel
<b>2-AS 20</b>	Primary L Runner, Lsectioned, 30x30 mm sized, 4000 mm length, 1 mm thickness, galvanised steel
<b>3-CBP-ZL-100</b>	C Bandraster Profile Splice
<b>4-AS 25</b>	Primary L Runner splice
<b>5-CBP-ZW-100</b>	C Bandraster Wall Anchor, 1 mm thickness, galvanised steel. ( if there is no C-Wall Angle).
<b>6-CBP-ZA-100</b>	C Bandraster Rigid Hanger, 1 mm thickness, galvanised steel.
<b>7-CDPR 300</b>	C-Wall Angle, 20x40x20 mm sized, 3000 mm length, 0,5 mm thickness, pre-painted galvanised steel
<b>8-KT 40</b>	Wedge Clip, 0,5 mm thickness, galvanised steel
<b>9-VDS 60</b>	Bolt/nult, $\varnothing 6$ mm
<b>10-ATJ 100</b>	Threaded Rod, $\varnothing 6$ mm, 1000mm length (Standard)
<b>11-TD-06</b>	Threaded Rod Anchor

PANEL BAĞLANTI DETAYLARI  
PANEL CONNECTION DETAILS

Duvar  
Wall

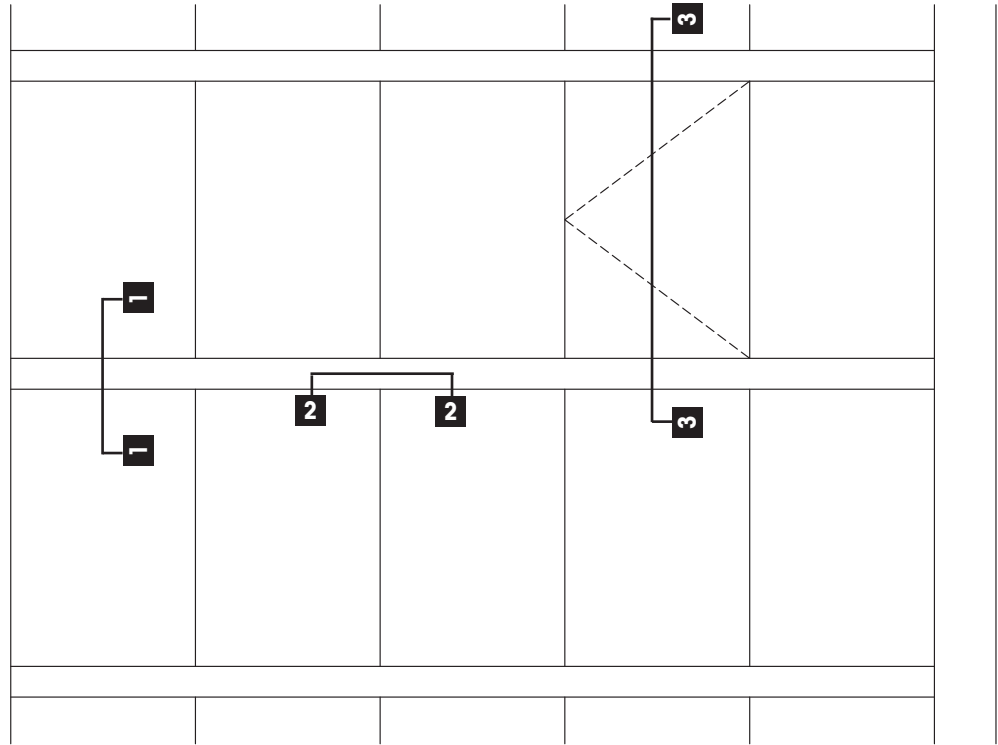

1-1 Kesiti / Section 1-1

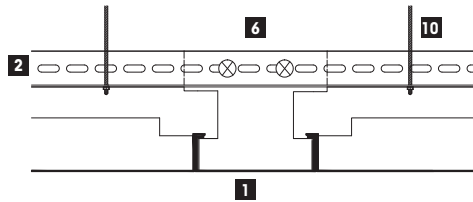

Taşıyıcı - Panel Birleşimi

- 1 C Bandraster Profil
- 2 Ana L taşıyıcı
- 6 C Bandraster Ana L taşıyıcı Askı Parçası
- 10 Askı tiji

Profile - Panel Connection

- 1 C Bandraster Profile
- 2 Primary L runner
- 6 C Bandraster Rigid Hanger
- 10 Threaded Rod

2-2 Kesiti / Section 2-2

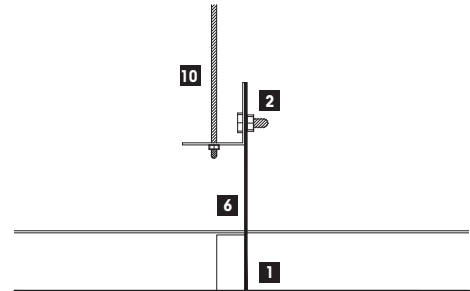

Taşıyıcı - Askı Birleşimi

- 1 C Bandraster Profil
- 2 Ana L taşıyıcı
- 6 C Bandraster Ana L taşıyıcı Askı Parçası
- 10 Askı tiji

Profile - Hanger Connection

- 1 C Bandraster Profile
- 2 Primary L runner
- 6 C Bandraster Rigid Hanger
- 10 Threaded Rod

3-3 Kesiti / Section 3-3

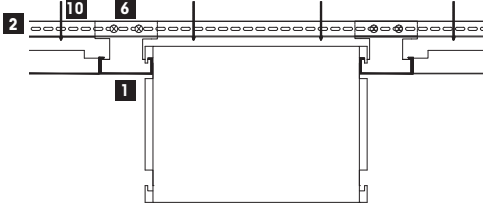

Panel Birleşimi

1 C Bandraster Profil

2 Ana L taşıyıcı

6 C Bandraster Ana L taşıyıcı Askı Parçası

10 Askı tiji

Connection of Panels

1 C Bandraster Profile

2 Primary L runner

6 C Bandraster Rigid Hanger

10 Threaded Rod

**Not:** Diğer detaylar için Perspekta C sistemine bakınız.