

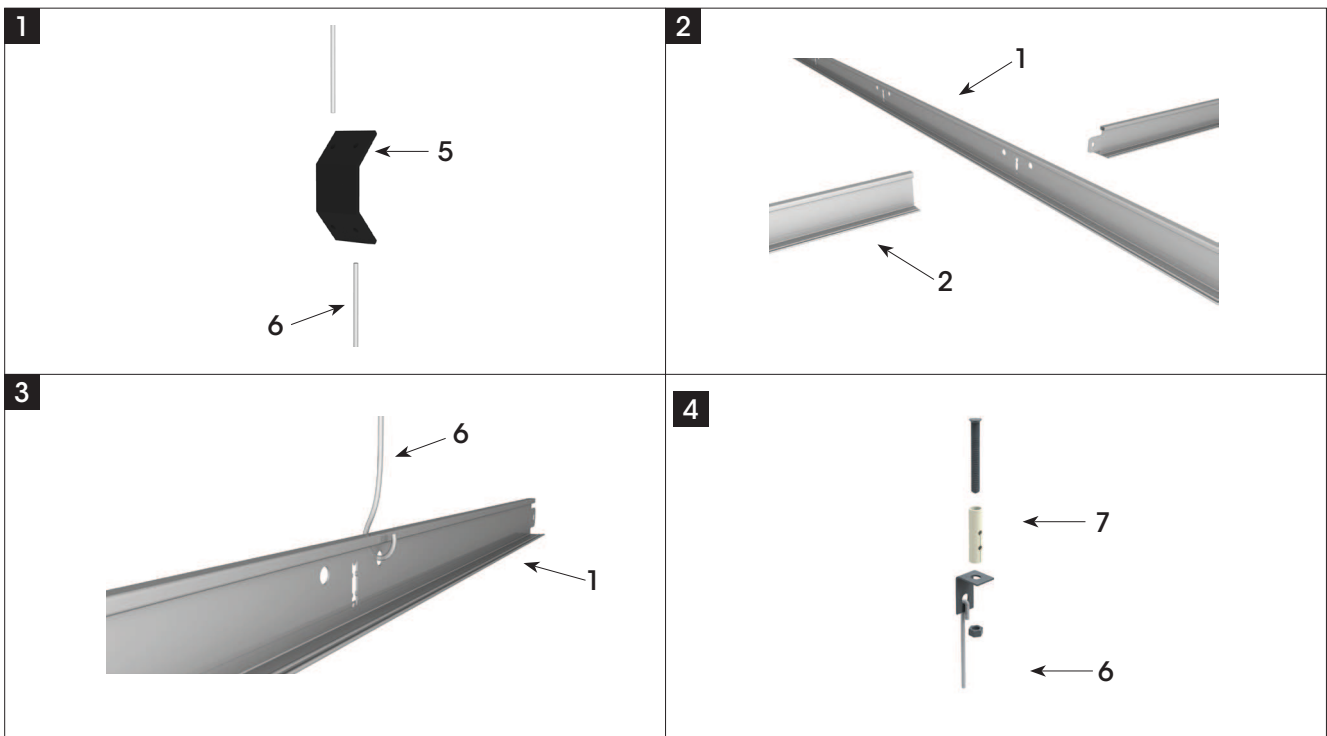

INTEGRA TILE INTEGRA TILE

Lay-in Tile Sistem
Lay-in Tile System

Lay-in Tegular / Deep Tegular
Lay-in Tegular / Deep Tegular

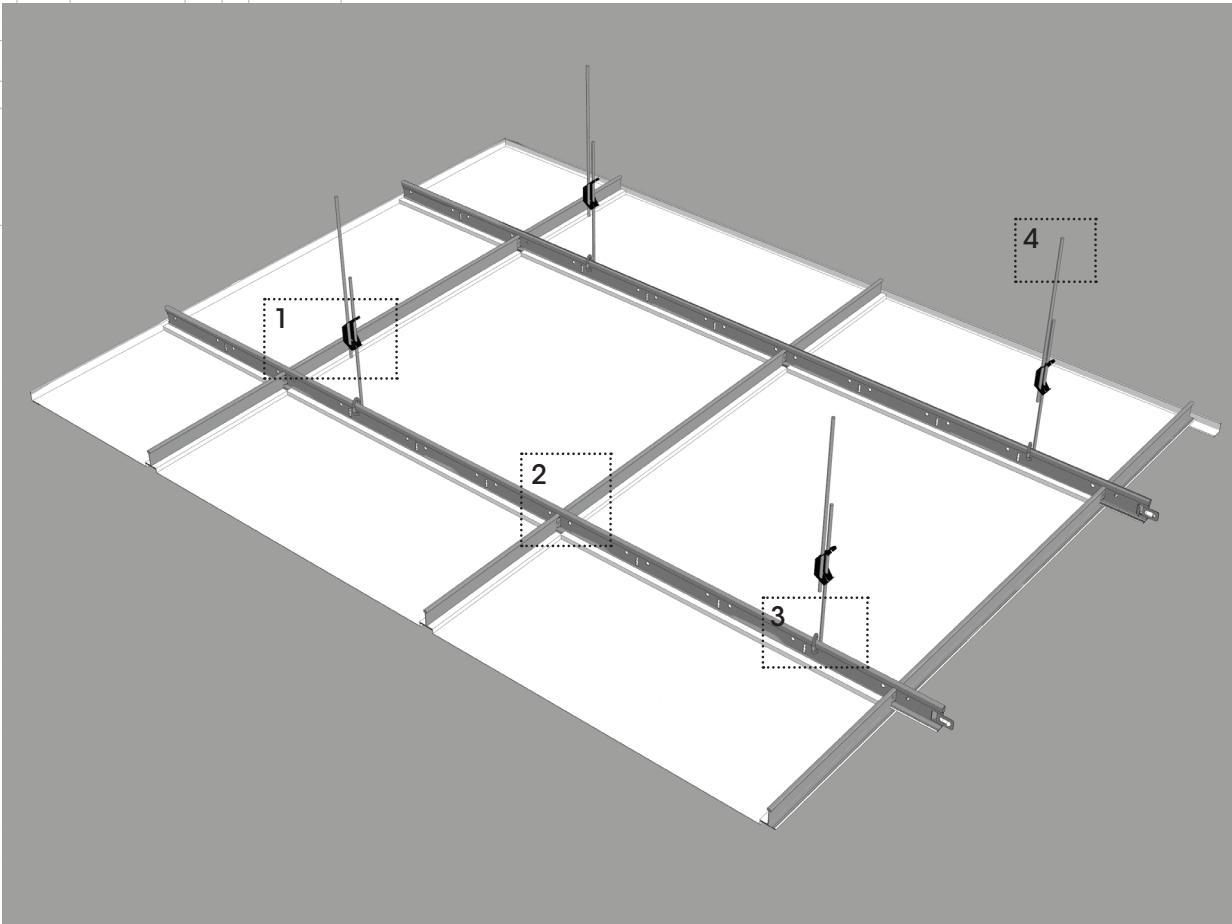

Lay-in Tile Tegular / Deep Tegular

Integra Tile Lay-in Tegular ve Deep Tegular tavan sistemleri çağdaş asma tavan tasarımları ile farklı seçenekler sunar. Tegular Lay-in panelleri T24 taşıyıcı sisteminden 8mm sarkmalıdır. Deep Tegular Lay-in panelleri ise 12mm sarkma ölçüsü ile fuga etkisini artırmaktadır. Integra Lay-in panelleri siparişe göre farklı ebatta ve farklı sarkma ölçüleri ile üretilebilir.

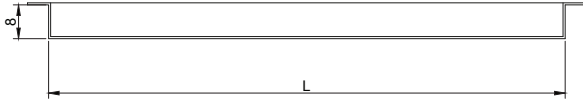
Standart Panel / Standard Panel**Panel Tanımı**

Hammadde: Galvanize çelik, Paslanmaz çelik, Alüminyum.

Kenar özelliği: 8mm/12mm sarkmalı

En: 600 mm

Boy: 600mm

Boya: RAL 9006, RAL 9010, RAL 9016

- . İsteğe bağlı olarak tüm RAL renklerinde üretim yapılabilir.
- . Özellikle hijyen gerektiren alanlar için anti bakteriyel boya seçeneği mevcuttur.
- . İstenildiğinde ahşap görünümlü paneller üretilebilir.
- . Daha fazla bilgi için bkz. **Renk ve Desen**

Perforasyon: Ø0.7, Ø1.5, Ø1.8, Ø2.5, Ø3, Ø4.5, Ø6, Ø7, Ø16, 8x8, Random

- . Daha fazla bilgi için bkz. **Perforasyon**

Akustik: NRC 0,70(Ø2.5mm %16 boşluk oranı)
Daha fazla bilgi için bkz. **Akustik**

Yangın: Yangın tepki sınıfı A2-s1,d0.
Daha fazla bilgi için bkz. **Standartlar**

Teknik Standartlar:

- . T24 taşıyıcı sistem ile desteklenen paneller, ISO9001:2008, TSE ve CE belgeli tesisimizde Avrupa, Amerika ve TAIM (Technical Association of Industrial Metal Ceiling Manufacturers) standartlarına uygun olarak imal edilmektedir.
- . Malzemenin yangın tepki sınıfı, uluslar arası akredite edilmiş test kuruluşlarında yaptırılmış yangın testi ile EN 13501-1 standardı uyarınca yapılan sınıflandırma sonucu A2-s1,d0 olarak belgelenmiştir.

Lay-in Tile Tegular / Deep Tegular

Integra Lay-in Tegular and Deep Tegular panels, which offer different alternatives for modern ceiling designs, The Tegular Lay-in panels have 8 mm recessed from the T-24 system. The Deep Tegular panels enhance the gap effect with a 12 mm recessed. Available in galvanized steel and aluminium, Integra Lay-in panels can be custom-designed and produced with the possibility of different recessed dimensions.

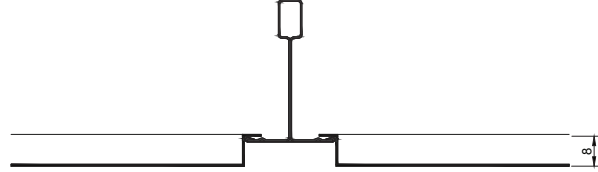
Standart Birleşim / Standard Connection**Panel Description**

Raw material: Galvanized Steel, Stainless Steel, Aluminium.

Edge Option: 8mm/12mm drop

Width: 600 mm

Length: 600 mm

Colour: RAL9006, RAL9010, RAL9016

- . Production is possible in all other RAL colours upon request.
- . Antibacterial paint option is available upon request, especially for areas with hygiene requirements.
- . Panels with wood appearance can be produced if requested.
- . For detailed information please see **Colours and Design**.

Perforation: Ø0.7, Ø1.5, Ø1.8, Ø2.5, Ø3, Ø4.5, Ø6, Ø7, Ø16, 8x8, Random

For detailed information please see **Perforation**.

Acoustics: NRC: 0,70(Ø2.5mm %16 open area)
For detailed information please see **Acoustics**.

Fire: Reaction to Fire Class A2-s1,d0.
For detailed information please see **Standards**.

Technical Standards:

- . Ceiling panels supported by T-24 suspension system manufactured in accordance with European, American and TAIM (Technical Association of Industrial Metal Ceiling Manufacturers) standards in our factory that have ISO9001:2008, TSE and CE certificates.
- . Panels are tested in accordance with EN 13501-1 and must be designed to comply with Euroclass A2-s1, d0

METAL CEILING SPECIFICATION

... x ... mm Sized Tegular / Deep Tegular Lay-in Standard System

General Description:

Aluminium /Stainless Steel/ Galvanised Steel ceiling panels supported by T-24 suspension system manufactured in accordance with European, American and (Technical Association of Industrial Metal Ceiling Manufacturers) standards by a manufacturer that have ISO9001:2008, TSE ve CE certificates.

Ceilings are tested in accordance with EN 13501-1 and must be designed to comply with at least Euroclass A2-s1, d0

Panel Description:

- Raw material:** Ceiling panels manufactured from ... mm Aluminium /Stainless Steel/ Galvanised Steel.
Colour: Ceiling panels coated electrostatically applied powder coating coloured RAL ... (min. 40 μ thickness and approx. %20 Gloss Rate)
Acoustical inlay: Ceiling panels are manufactured with 0,2 mm thickness, black acoustical inlay (Royalin / Soundtex) to achieve sound absorption $\alpha_w = \dots$ for $\varnothing \dots$ mm Perforation (%.. open area)
Perforation: Ceiling panels are perforated $\varnothing \dots$ mm (% ... open area) and plain borders are ... mm.
Edge: 8mm/12mm drop.

Installation:

Shadow Angle (4) (C Wall Angle/L Wall Angle) should be used for lateral sides facing inwards of the gypsum pool. The first hanger system (Grida-T24) should not exceed 450 mm distance from the wall and the distance between hangers could be max 1000mm. Double spring clip(2), hanger wire(3) and steel anchor(7) will be used to suspend the runners securely. The distance between Wall-angle and the T-24 main runner should be max. 600 mm. The distance between the T-24 main runners should not exceed 1200mm. The T-24 cross runners should be positioned on 600 mm away from each. Lighting, sprinkler or vent places should be cutted out and the components should be mounted according to the project after the installation. In the case of these components come up to suspension system accessories, installation should be continued with mounting suspension system accesories one before and one after the components.

Suspension System:

- 1- **AS GR24-BO1:** T-24 Main Runner, 3600 mm length, 0,4 mm thickness , galvanised steel.
- 2- **AS GR24-BO2:** T-24 Cross Tee Runner, 1200 mm length, 0,4 mm thickness , galvanised steel.
- 3- **AS GR24-BO3:** T-24 Cross Tee Runner, 600 mm length, 0,4 mm thickness , galvanised steel.
- 4- **AS-GR1508-B05:** Shadow Angle, 3050 mm length, 0,5 mm thickness, pre-painted galvanised steel
- 5- **HDVC/4:** Double spring clip, black colored, phosphatized, 0,5 mm thickness, galvanised steel
- 6- **DST-01:** Hanger Wire, $\varnothing 4$ mm, 1000mm length (Standard)
- 7- **TP-02:** Steel anchor that coated by zinc against corrosion

PANEL BAĞLANTI DETAYLARI
PANEL CONNECTION DETAILS

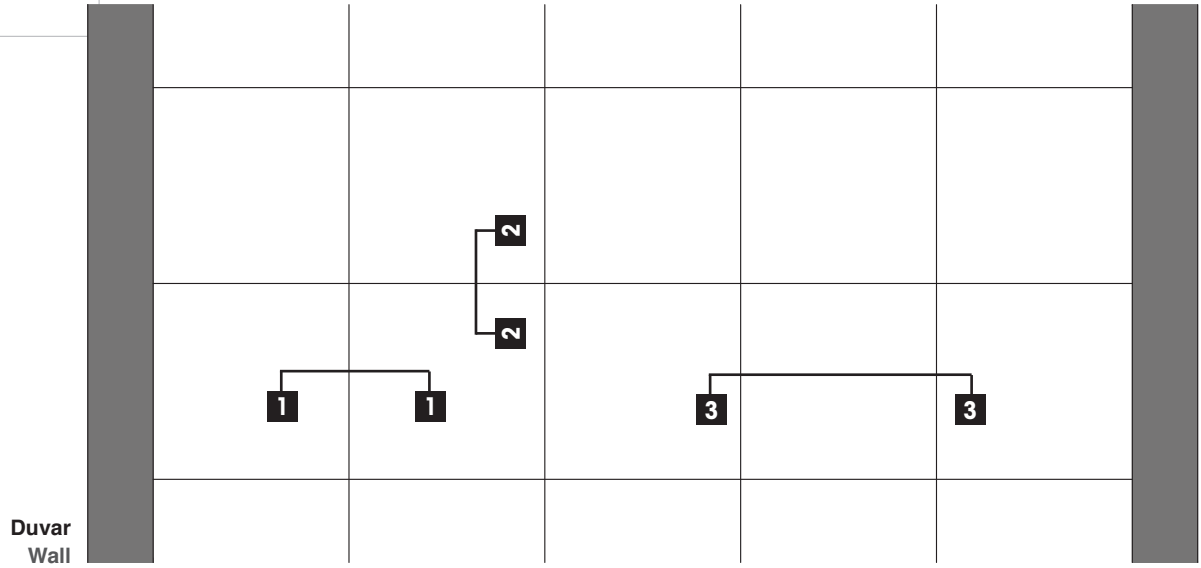

1-1 Kesiti / Section 1-1

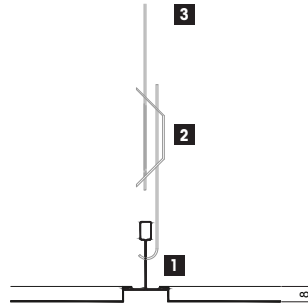

Alternatif 1

Tegular-8mm Sarkmalı
1 T-24 Ana Taşıyıcı
2 Askı Yayı
3 Askı Teli

Alternative 1

Tegular-8mm Drop
1 T-24 Main Runner
2 Double Spring Clip
3 Hanger Wire

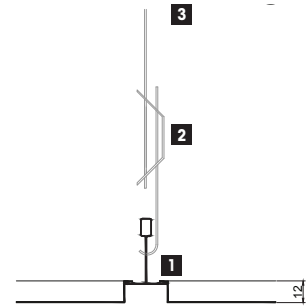

Alternatif 2

Deep Tegular-12mm Sarkmalı
1 T-24 Ana Taşıyıcı
2 Askı Yayı
3 Askı Teli

Alternative 2

Deep Tegular-12mm Drop
1 T-24 Main Runner
2 Double Spring Clip
3 Hanger Wire

2-2 Kesiti / Section 2-2



Panel Birleşimi

1 T-24 Ana Taşıyıcı

2 Askı Yayı

3 Askı Teli

Connection of Panels

1 T-24 Main Runner

2 Double Spring Clip

3 Hanger Wire

METAL VE DİĞER TAVANLARIN BİRLEŞİM DETAYLARI
METAL AND OTHER CEILING CONNECTION DETAILS

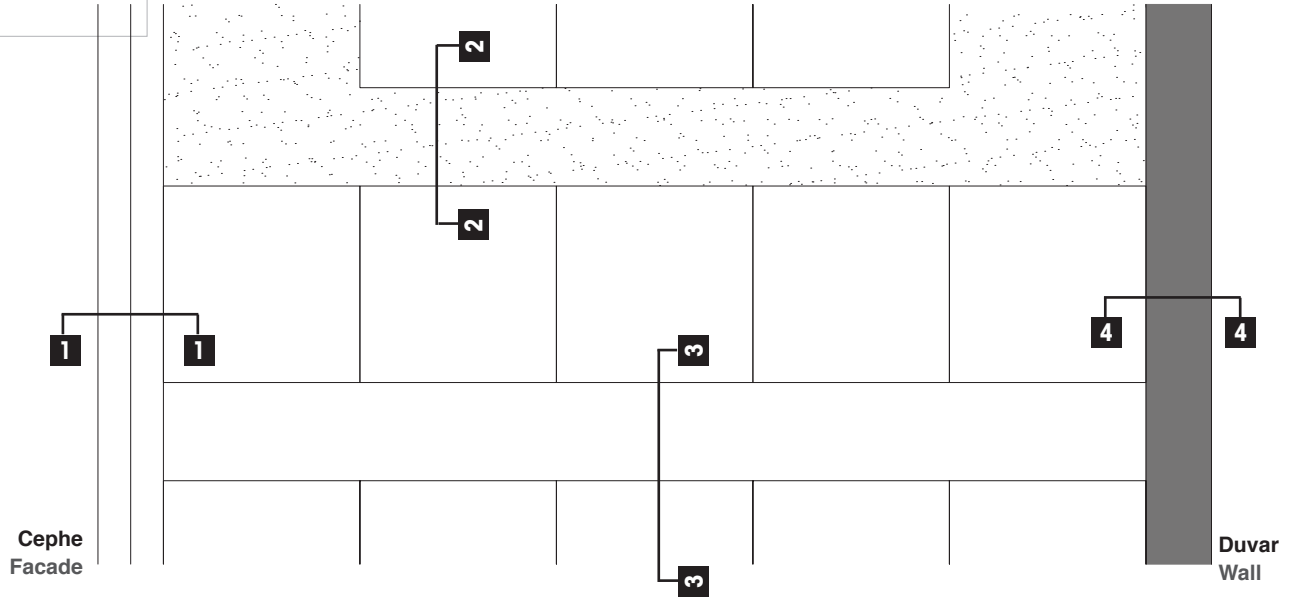

1-1 Kesiti / Section 1-1

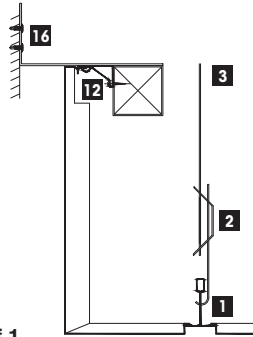

Alternatif 1

Yarım Clip-in Profil ile Alın Panel Bitişi
1 T-24 Ana Taşıyıcı
2 Askı Yayı
3 Askı Teli
12 Yarım Clip-in Profil
16 Duvar Bağlantı Pabucu

Alternative 1

L Panel Finish with Half Clip-in Profile
1 T-24 Main Runner
2 Double Spring Clip
3 Hanger Wire
12 Half Clip-in Profile
16 Wall Anchor

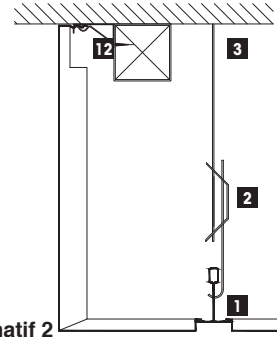

Alternatif 2

Yarım Clip-in Profil ile Alın Panel Bitişi
1 T-24 Ana Taşıyıcı
2 Askı Yayı
3 Askı Teli
12 Yarım Clip-in Profil

Alternative 2

L Panel Finish with Clip-in Profile
1 T-24 Main Runner
2 Double Spring Clip
3 Hanger Wire
12 Half Clip-in Profile

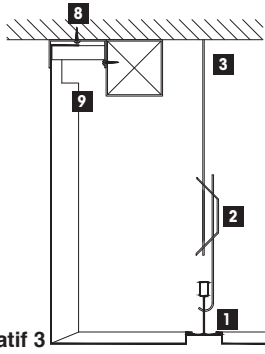

Alternatif 3

C Köşebent ile Alın Panel Bitişi

- | | |
|---|-------------------|
| 1 | T-24 Ana Taşıyıcı |
| 2 | Askı Yayı |
| 3 | Askı Teli |
| 8 | C Köşebent |
| 9 | Kenar Takozu |

Alternative 3

L Panel Finish with C Wall Angle

- | | |
|---|--------------------|
| 1 | T-24 Main Runner |
| 2 | Double Spring Clip |
| 3 | Hanger Wire |
| 8 | C Wall Angle |
| 9 | Wedge Clip |

2-2 Kesiti / Section 2-2

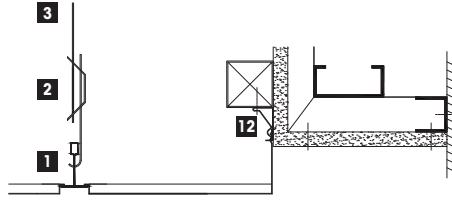

Alternatif 1

Yarım Clip-in Profil ile Alçıpan - Metal Tavan Birleşimi

- | | |
|----|----------------------|
| 1 | T-24 Ana Taşıyıcı |
| 2 | Askı Yayı |
| 3 | Askı Teli |
| 12 | Yarım Clip-in Profil |

Alternative 1

Joint to a Gypsum Board with Half Clip-in Profile

- | | |
|----|----------------------|
| 1 | T-24 Main Runner |
| 2 | Double Spring Clip |
| 3 | Hanger Wire |
| 12 | Half Clip-in Profile |

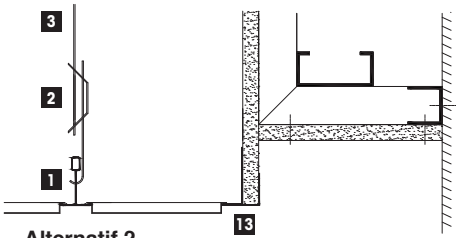

Alternatif 2

F Profil ile Alçıpan - Metal Tavan Birleşimi

- | | |
|----|-------------------|
| 1 | T-24 Ana Taşıyıcı |
| 2 | Askı Yayı |
| 3 | Askı Teli |
| 13 | F Profil |

Alternative 2

Joint to a Gypsum Board with F Profile

- | | |
|----|--------------------|
| 1 | T-24 Main Runner |
| 2 | Double Spring Clip |
| 3 | Hanger Wire |
| 13 | F Profile |

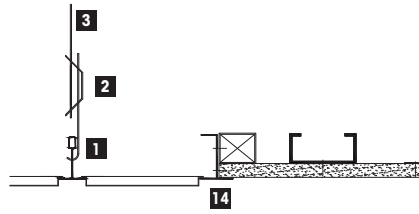

Alternatif 3

H Profil ile Alçıpan - Metal Tavan Birleşimi

- | | |
|----|-------------------|
| 1 | T-24 Ana Taşıyıcı |
| 2 | Askı Yayı |
| 3 | Askı Teli |
| 14 | H Profil |

Alternative 3

Joint to a Gypsum Board with H Profile

- | | |
|----|--------------------|
| 1 | T-24 Main Runner |
| 2 | Double Spring Clip |
| 3 | Hanger Wire |
| 14 | H Profile |

3-3 Kesiti / Section 3-3



Alternatif 1

Kapama Paneli - Metal Tavan Birleşimi
1 T-24 Ana Taşıyıcı
2 Askı Yayısı
3 Askı Teli

Alternative 1

Joint to Metal Ceiling with Covering Panel
1 T-24 Main Runner
2 Double Spring Clip
3 Hanger Wire



Alternatif 2

Kapama Paneli - Metal Tavan Birleşimi
1 T-24 Ana Taşıyıcı
2 Askı Yayısı
3 Askı Teli

Alternative 2

Joint to Metal Ceiling with Covering Panel
1 T-24 Main Runner
2 Double Spring Clip
3 Hanger Wire

4-4 Kesiti / Section 4-4

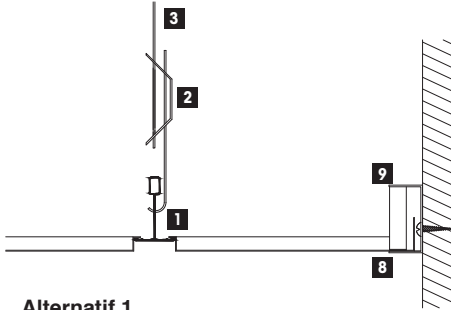

Alternatif 1

C Köşebent ile Tam Plaka Duvar Bitişi
1 T-24 Ana Taşıyıcı
2 Askı Yayısı
3 Askı Teli
8 C Köşebent
9 Kenar Takozu

Alternative 1

Full Panel Finish with C Wall Angle
1 T-24 Main Runner
2 Double Spring Clip
3 Hanger Wire
8 C Wall Angle
9 Wedge Clip

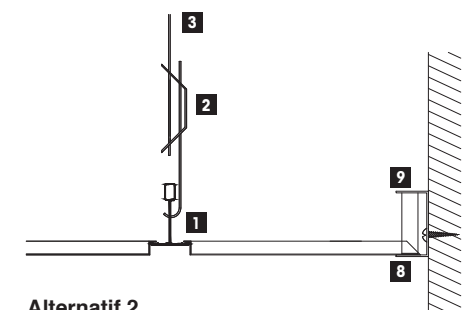

Alternatif 2

C Köşebent ile Tam Plaka Duvar Bitişi
1 T-24 Ana Taşıyıcı
2 Askı Yayısı
3 Askı Teli
8 C Köşebent
9 Kenar Takozu

Alternative 2

Full Panel Finish with C Wall Angle
1 T-24 Main Runner
2 Double Spring Clip
3 Hanger Wire
8 C Wall Angle
9 Wedge Clip

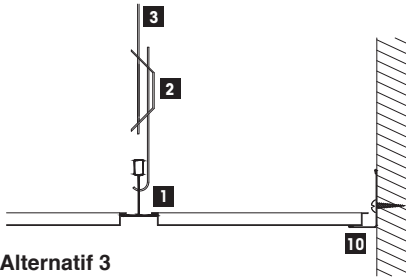

Alternatif 3

L Köşebent ile Tam Plaka Duvar Bitişi

- | |
|----------------------------|
| 1 T-24 Ana Taşıyıcı |
| 2 Askı Yayı |
| 3 Askı Teli |
| 10 L Köşebent |

Alternative 3

Full Panel Finish with L Wall Angle

- | |
|-----------------------------|
| 1 T-24 Main Runner |
| 2 Double Spring Clip |
| 3 Hanger Wire |
| 10 L Wall Angle |

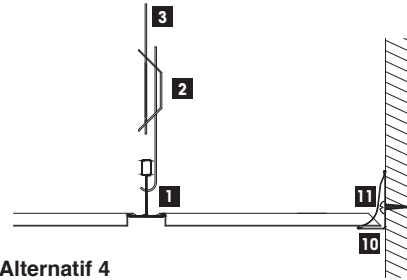

Alternatif 4

L Köşebent ile Kesik Plaka Duvar Bitişi

- | |
|----------------------------|
| 1 T-24 Ana Taşıyıcı |
| 2 Askı Yayı |
| 3 Askı Teli |
| 10 L Köşebent |
| 11 Kenar Takoğu |

Alternative 4

Cutted Panel Finish with L Wall Angle

- | |
|-----------------------------|
| 1 T-24 Main Runner |
| 2 Double Spring Clip |
| 3 Hanger Wire |
| 10 L Wall Angle |
| 11 Wedge Clip |

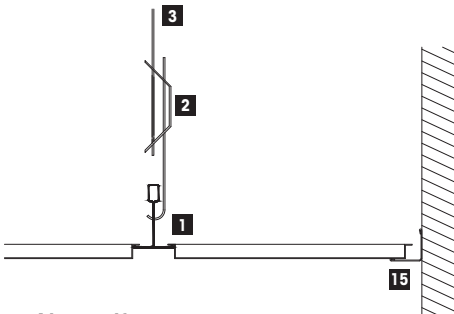

Alternatif 5

Grıda L Köşebent ile Tam Plaka Duvar Bitişi

- | |
|----------------------------|
| 1 T-24 Ana Taşıyıcı |
| 2 Askı Yayı |
| 3 Askı Teli |
| 15 Grıda L Köşebent |

Alternative 5

Full Panel Finish with Grıda L Wall Angle

- | |
|------------------------------|
| 1 T-24 Main Runner |
| 2 Double Spring Clip |
| 3 Hanger Wire |
| 15 Grıda L Wall Angle |

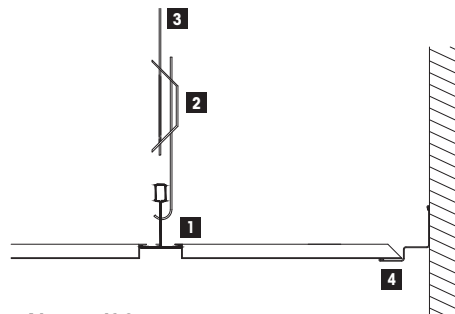

Alternatif 6

Basamaklı Köşebent ile Tam Plaka Duvar Bitişi

- | |
|-----------------------------|
| 1 T-24 Ana Taşıyıcı |
| 2 Askı Yayı |
| 3 Askı Teli |
| 4 Basamaklı Köşebent |

Alternative 6

Full Panel Finish with Z Profile

- | |
|-----------------------------|
| 1 T-24 Main Runner |
| 2 Double Spring Clip |
| 3 Hanger Wire |
| 4 Z Wall Angle |

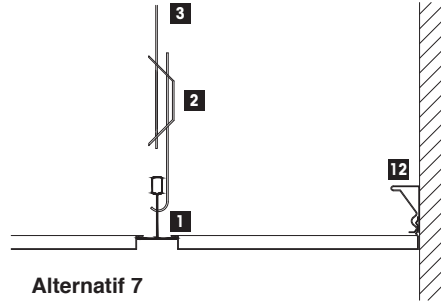

Alternatif 7

Yarım Clip-in Profil ile Tam Plaka Duvar Bitişi	
1	T-24 Ana Taşıyıcı
2	Askı Yayı
3	Askı Teli
12	Yarım Clip-in Profil

Alternative 7

Full Panel Finish with Half Clip-in Profile	
1	T-24 Main Runner
2	Double Spring Clip
3	Hanger Wire
12	Half Clip-in Profile

CUTOUT YAPILMIŞ PANEL DETAYLARI
PANELS WITH CUT-OUT DETAILS

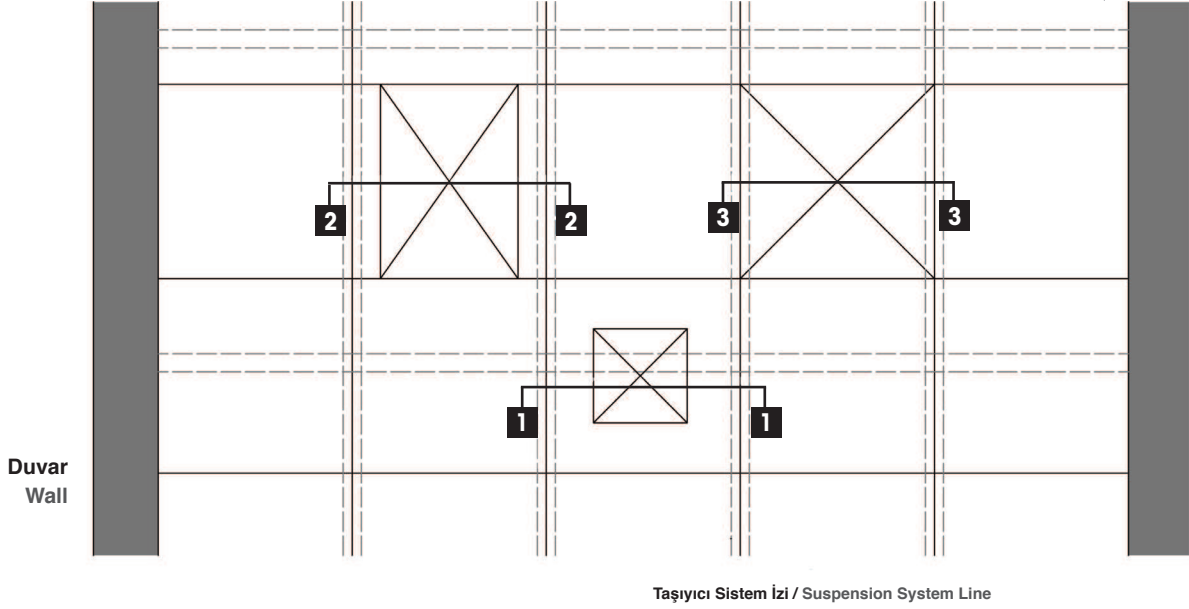

1-1 Kesiti / Section 1-1



2-2 Kesiti / Section 1-1

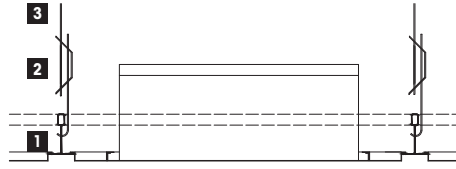

Cut-out Yapılmış Tavan Paneli

- 1 T-24 Ana Taşıyıcı
- 2 Askı Yayı
- 3 Askı Teli

Cut-out Yapılmış Tavan Paneli

- 1 T-24 Ana Taşıyıcı
- 2 Askı Yayı
- 3 Askı Teli

Ceiling Panel with Cut-out

- 1 T-24 Main Runner
- 2 Double Spring Clip
- 3 Hanger Wire

Ceiling Panel with Cut-out

- 1 T-24 Main Runner
- 2 Double Spring Clip
- 3 Hanger Wire

3-3 Kesiti / Section 3-3

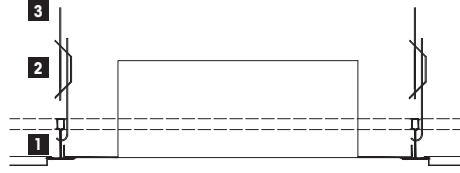

Cut-out Yapılmış Tavan Paneli

1 T-24 Ana Taşıyıcı

2 Askı Yayı

3 Askı Teli

Ceiling Panel with Cut-out

1 T-24 Main Runner

2 Double Spring Clip

3 Hanger Wire

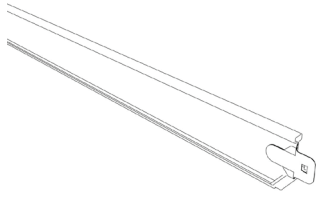

01

AS-GR24-B01

Ürün Adı Özellik / Malzeme	T24 Ana Taşıyıcı 24x38x3600x0,4mm Galvanize Çelik 0,4 mm
-------------------------------	--

AS-GR24-B01

Product Reference Specification / Material	T24 Main Runner 24x38x3600x0,4mm Galvanized Steel 0,4 mm
---	--

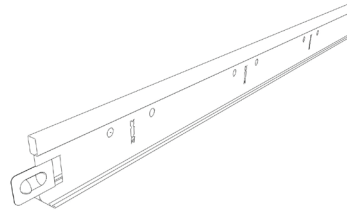

02

AS-GR24-B02

Ürün Adı Özellik / Malzeme	T24 Tali Taşıyıcı 15x30x1200x0,4mm Galvanize Çelik 0,4 mm
-------------------------------	---

AS-GR24-B02

Product Reference Specification / Material	T24 Cross Runner 15x30x1200x0,4mm Galvanized Steel 0,4 mm
---	---

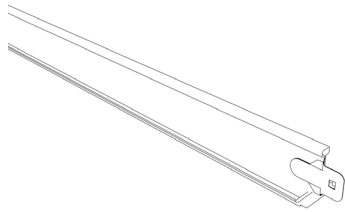

03

AS-GR24-B03

Ürün Adı Özellik / Malzeme	T24 Tali Taşıyıcı 15x30x600x0,4mm Galvanize Çelik 0,4 mm
-------------------------------	--

AS-GR24-B03

Product Reference Specification / Material	T24 Cross Runner 15x30x600x0,4mm Galvanized Steel 0,4 mm
---	--

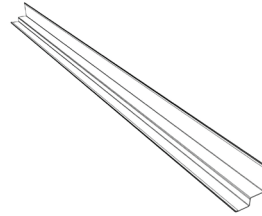

04

AS-GR1508-B05

Ürün Adı Özellik / Malzeme	Basamaklı Köşebent 25x8x15x15x3050x0,5mm Galvanize Çelik 0,5 mm
-------------------------------	---

AS-GR1508-B05

Product Reference Specification / Material	Z Wall Angle 25x8x15x15x3050x0,5mm Galvanized Steel 0,5 mm
---	--

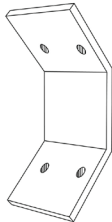

05

HDVC/4

Ürün Adı Özellik / Malzeme	Askı Yayı Yay Çeliği 0,5 mm
-------------------------------	--------------------------------

HDVC/4

Product Reference Specification / Material	Double Spring Clip Spring Steel 0,5 mm
---	---



06

DST 01

Ürün Adı Özellik / Malzeme	Askı Teli Galvanize Çelik 0,6 mm
-------------------------------	-------------------------------------

DST 01

Product Reference Specification / Material	Hanger Wire Galvanized Steel 0,6 mm
---	--

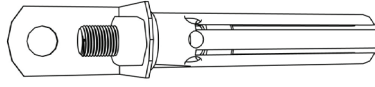

07

TP 02	
Ürün Adı Özellik / Malzeme	Çelik Dübelli Pabuç Yay Çeliği 2 mm

TP 02	
Product Reference Specification / Material	Steel Anchor Spring Steel 2,0 mm

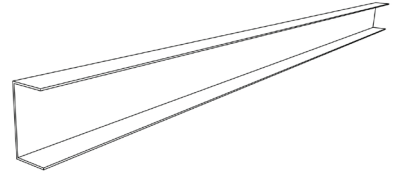

08

CDPR 300	
Ürün Adı Özellik / Malzeme	C Köşebent 20x40x20x3000x0,5 Galvanize Çelik 0,5 mm

CDPR 300	
Product Reference Specification / Material	C Wall Angle 20x40x20x3000x0,5 Galvanized Steel 0,5 mm

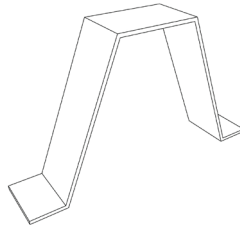

09

KT 40	
Ürün Adı Özellik / Malzeme	Kenar Takoza Yay Çeliği 0,45 mm

KT 40	
Product Reference Specification / Material	Wedge Clip Spring Steel 0,45 mm

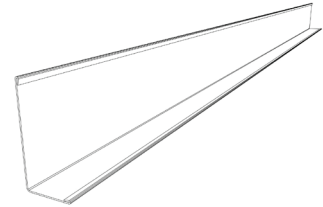

10

WL 3000	
Ürün Adı Özellik / Malzeme	L Köşebent 20x40x3000x0,5 Galvanize Çelik 0,5 mm

WL 3000	
Product Reference Specification / Material	L Wall Angle 20x40x3000x0,5 Galvanized Steel 0,5 mm



11

WKT 1	
Ordering Reference Specification / Material	Kenar Takoza Yay Çeliği 0,45 mm

WKT 1	
Ordering Reference Specification / Material	Wedge Clip Spring Steel 0,45 mm

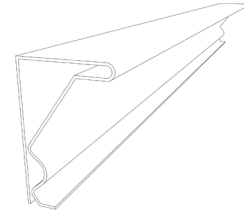

12

HCLN 400	
Ürün Adı Özellik / Malzeme	Yarım Clip-in Profil 18x29x4000x0,5 mm Galvanize Çelik 0,5 mm

HCLN 400	
Product Reference Specification / Material	Yarım Clip-in Profil 18x29x4000x0,5 mm Galvanized Steel 0,5 mm

13

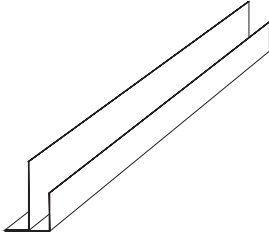

FDPR-3000	
Ordering Reference Specification / Material	F Profil Alüminyum 1 mm

FDPR-3000	
Ordering Reference Specification / Material	F Profile Aluminium 1 mm

14

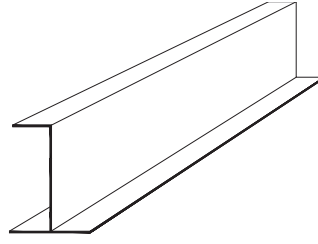

HDPR-40	
Ürün Adı Özellik / Malzeme	H Profil 30x40x3000x1mm Alüminyum 1 mm

HDPR-40	
Product Reference Specification / Material	H Profile 30x40x3000x1mm Aluminium 1 mm

15

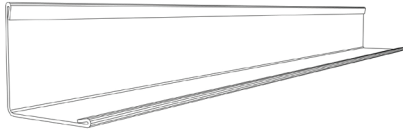

AS-GR1919-B04	
Ürün Adı Özellik / Malzeme	Grıda L Profil 19x19x3050x0,5mm Galvanize Çelik 0,5 mm

AS-GR1919-B04	
Product Reference Specification / Material	Grıda L Wall Angle 19x19x3050x0,5mm Galvanized Steel 0,5 mm

16

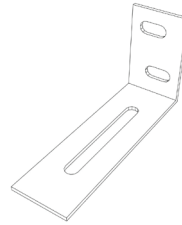

AS-30	
Ürün Adı Özellik / Malzeme	Duvar Bağlantı Pabucu Galvanize Çelik 1,5 mm 30x50x100x1,5

AS-30	
Product Reference Specification / Material	Wall Anchor Galvanized Steel 1,5 mm 30x50x100x1,5